

WATER WELL RECORD

Form WWC-5

Division of Water Resources App. No.

[Empty box]

Well ID

MW2

[X] Original Record [] Correction [] Change in Well Ust

1 LOCATION OF WATER WELL: County Sedgwick Fraction NE 1/4 NW 1/4 NE 1/4 NE 1/4 Section Number 32 Township Number T 27 S Range Number R 1 E W

2 WELL OWNER: Last Name: Business: KDHE (Derby Station) Address: 1000 SW Jackson, Suite 410 City: Topeka State: KS ZIP: 66612 Street or Rural Address where well is located (if unknown, distance and direction from nearest town or intersection): 1601 S. Main St Wichita, Kansas 67213

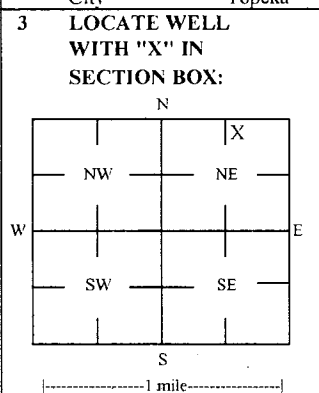

4 DEPTH OF COMPLETED WELL: 25 ft Depth(s) Groundwater Encountered: 1) _____ ft 2) _____ ft 3) _____ ft, or 4) [] Dry Well WELLS STATIC WATER LEVEL: 20.54 ft. [X] below land surface, measured on (mo-day-yr) 4/11/18 [] above land surface, measured on (mo-day-yr) _____ Pump test data: Well water was _____ ft after _____ hours pumping _____ gpm Water well was _____ ft after _____ hours pumping _____ gpm Estimated Yield: _____ gpm Bore Hole Diameter: 7.25 in to _____ ft, and _____ in to _____ ft

5 Latitude: 37.66406 (decimal degrees) Longitude: 97.33832 (decimal degrees) Horizontal Datum: [] WGS 84 [] NAD 83 [X] NAD 27 Source for Latitude/Longitude: [] GPS (unit make/model: _____) (WAAS enabled? [] Yes [] No) [X] Land Survey [] Topographic Map [] Online Mapper

6 Elevation 1282.48 ft [] Ground Level [X] TOC Source [X] Land Survey [] GPS [] Topographic Map [] Other _____

7 WELL WATER TO BE USED AS: 1 Domestic: [] Household [] Lawn & Garden [] Livestock [] Irrigation [] Feedlot [] Industrial 2 Public Water Supply: well ID _____ 3 Dewatering: how many wells? _____ 4 Aquifer Recharge: well ID _____ 5 Monitoring: well ID MW2 6 Environmental Remediation: well ID _____ [] Air Sparge [] Soil Vapor Extractor [] Recovery [] Injection 7 Oil Field Water Supply: lease _____ 8 Test Hole: well ID _____ [] Cased [] Uncased [] Geotechnical 9 Geothermal: How many bores? _____ a) Closed Loop [] Horizontal [] Vertical b) Open Loop [] Surface Discharge [] Inj. of Water [] Other (specify): _____

Was a chemical/bacteriological sample submitted to KDHE? [] Yes [X] No If yes, date sample was submitted: _____ Water well disinfected? [] Yes [X] No

8 TYPE OF CASING USED: [] Steel [X] PVC [] Other _____ CASING JOINTS: [] Glued [] Clamped [] Welded [X] Threaded Casing diameter 2 in. to 15 ft, Diameter _____ in. to _____ ft, Diameter _____ in. to _____ ft, Casing height above land surface -0.25 in. Weight _____ lbs./ft. Well thickness or gauge No _____ TYPE OF SCREEN OR PERFORATION MATERIAL: [] Steel [] Stainless Steel [] Fiberglass [X] PVC [] Brass [] Galvanized Steel [] Concrete tile [] None used (open hole) [] Other (Specify) _____ SCREEN OR PERFORATION OPENINGS ARE: [] Continuous Slot [X] Mill Slot [] Gauze Wrapped [] Torch Cut [] Drilled Holes [] Other (Specify) _____ [] Louvered Shutter [] Key Punched [] Wire Wrapped [] Saw Cut [] None (Open Hole) SCREEN-PERFORATED INTERVALS: From 15 ft. to 25 ft, From _____ ft. to _____ ft, From _____ ft. to _____ ft, GRAVEL PACK INTERVALS: From 13 ft. to 25 ft, From _____ ft. to _____ ft, From _____ ft. to _____ ft,

9 GROUT MATERIAL: [] Neat cement [] Cement grout [X] Bentonite [X] Other Concrete: 0-1' Grout intervals: From 1 ft. to 13 ft, From _____ ft. to _____ ft, From _____ ft. to _____ ft,

Nearest source of possible contamination: [] Septic Tank [] Lateral Lines [] Pit Privy [] Livestock Pens [] Insecticide Storage [] Sewer Lines [] Cess Pool [] Sewage Lagoon [X] Fuel Storage [] Abandoned Water Well [] Watertight Sewer Lines [] Seepage Pit [] Feedyard [] Fertilizer Storage [] Oil Well / Gas Well [] Other (Specify) _____ Direction from well? N Distance from well? ~130 ft

10 FROM TO LITHOLOGIC LOG FROM TO LITHO. LOG (cont.) or PLUGGING INTERVALS

0	0.33	Topsoil: silt with sand			
0.33	4	Silty			
4	6	Silty clay grading to clayey silt			
6	11	Clayey silt			
11	21	Fine sand			
21	25	Coarse sand and gravel			

Notes: KDHE ID: Derby Station; U2-087-12671 Target of monitoring well is shallow groundwater, <20' of grout was installed at the direction of KDHE.

11 CONTRACTOR'S OR LANDOWNER'S CERTIFICATION: This water well was [X] constructed, [] reconstructed, or [] plugged under my jurisdiction and was completed on (mo-day-year) 4/9/18 and this record is true to the best of my knowledge and belief. Kansas Water Well Contractor's License No 757 This Water Well Record was completed on (mo-day-year) 5/2/18 under the business name of Larsen & Associates, Inc. Signature _____

SECTWICK

DENNIS L HANDKE

1820 NW 59th Terrace
TOPEKA, KANSAS 66618
785-286-4047 Home
785-286-1990 Fax

Jessica Chapman
Larsen & Associates
1311 E. 25th Street, Suite B
Lawrence, Kansas, 66046

April 24, 2018
Revised May 1, 2018

RE: Monitor Well Elevation Survey
110 W. Harry, Wichita, Kansas

Proj. 18-00L
Derby Station
U2-087-12671

Bench Mark: Chisled Sq. on NW corner of concrete signal light base at Southeast corner of property.
Elev: 1146.95 North 26 West 782 (from SE Cor. Sec. 29-27-1E)

MW-1	rim	1282.27	South	47	NE1/4,NW1/4,NE1/4,NE1/4 (Sec. 32-27-1E)
	top pipe	1281.73	West	835	Lat= 37.66420 Long = 97.33842
MW-2	rim	1282.73	South	97	NE1/4,NW1/4,NE1/4,NE1/4 (Sec. 32-27-1E)
	top pipe	1282.48	West	804	Lat= 37.66406 Long = 97.33832
MW-3	rim	1282.07	North	129	SE1/4,SW1/4,SE1/4,SE1/4
	top pipe	1281.72	West	781	Lat= 37.66468 Long = 97.33824
MW-4	rim	1282.57	South	55	NW1/4,NW1/4,NE1/4,NE1/4 (Sec. 32-27-1E)
	top pipe	1282.23	West	1085	Lat= 37.66418 Long = 97.33929
MW-5	rim	1282.54	North	124	SW1/4,SW1/4,SE1/4,SE1/4
	top pipe	1282.32	West	1100	Lat= 37.66467 Long = 97.33934
MW-6	rim	1282.17	South	58	NE1/4,NW1/4,NE1/4,NE1/4 (Sec. 32-27-1E)
	top pipe	1281.84	West	959	Lat= 37.66417 Long = 97.33885

MAY 12 2018

Lat & Long derived existing Wichita East 7.5' quad map. WGS 84.

BUREAU OF WATER

Elevation established from City of Wichita BM. NAVD 27.

If you have any questions, please feel free to call me. Thank you for the opportunity to be of service to you.

Dennis L Handke RLS

Dennis L Handke
KANSAS
LAND SURVEYOR

RECEIVED

SENECA COUNTY
 sec 29 27S 1E
 SEDGWICK

NOTE: Figures exhibited within this report are only to be used within the context of this report. Placement of property lines, wells, structures, and roads is based on the available information from county appraiser maps, surveys, site visits, and/or previous vendor reports and should be considered approximate.

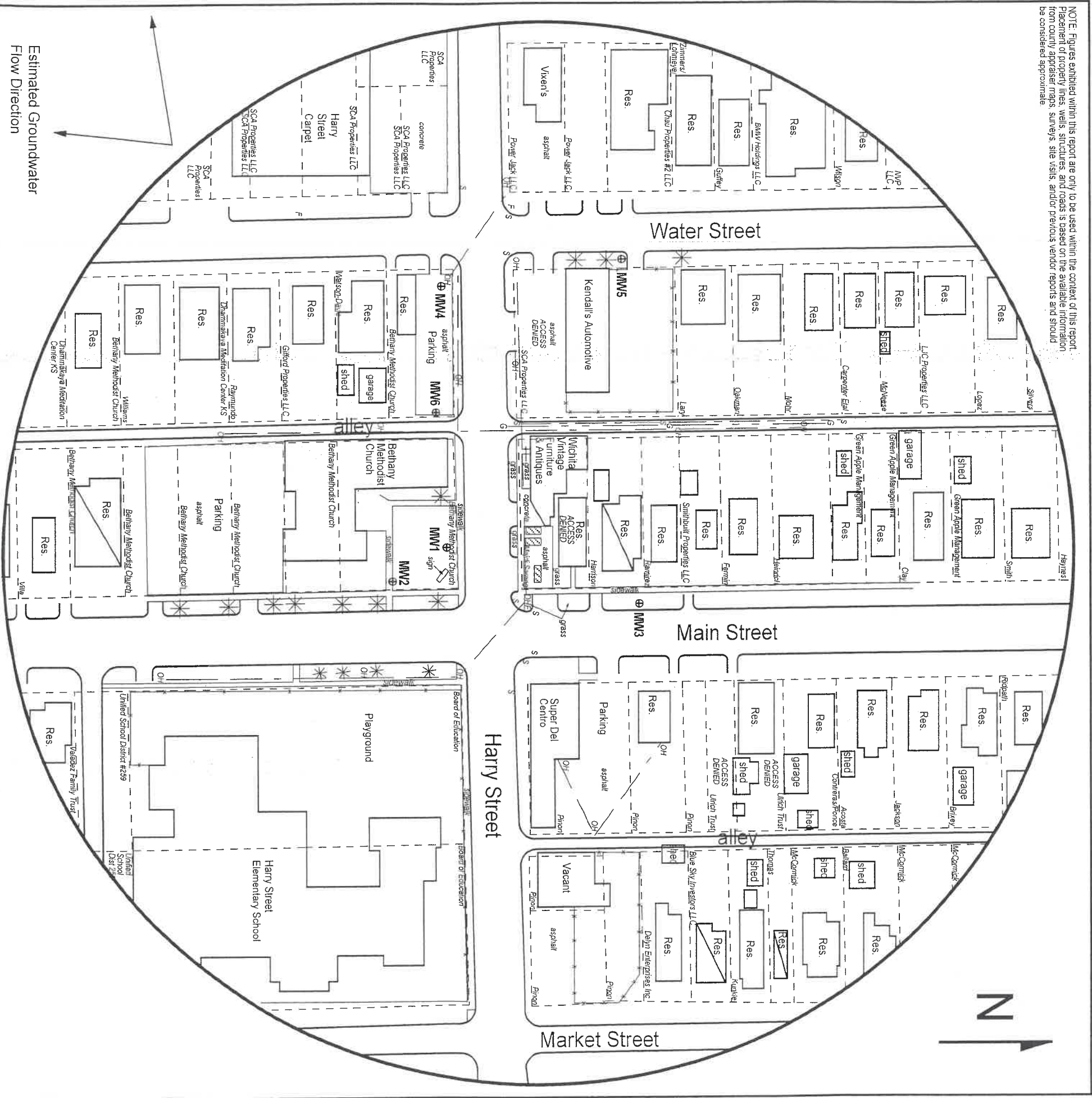

FIGURE 2.2 - 500 FT RADIUS AREA BASE MAP

<p>larsen & ASSOCIATES, INC.</p>	<p>PROJECT: Derby Station 110 W Harry Wichita, KS KDHE ID: U2-087-12671 Date: 4/11/18</p>	<p>1311 E 25th St., Suite B Lawrence, KS 66046</p> <p>(785) 841-8707 office (785) 865-4282 fax</p>
<p>RECEIVED MAY 1 2 2018 BUREAU OF WATER</p>		
<p>LEGEND:</p> <ul style="list-style-type: none"> Approximate Location of Former UST Basin Building with Basement Approximate Location of Property Line Monitoring Well (Installed 4/9-10/18) Fire Hydrant Gas Lines (2 - 6 ft BGS) Overhead Lines (25-40 ft high) Sanitary Sewer (2 - 6 ft BGS) 		<p>0 100 feet</p> <p>NOTE: Utility depths, heights and locations are approximate.</p>