

WATER WELL RECORD

Form WWC-5

Division of Water Resources App. No.

Well ID

MW6

Original Record  Correction  Change in Well Use

1 LOCATION OF WATER WELL: County Sedgwick Fraction NE 1/4 NW 1/4 NE 1/4 NE 1/4 Section Number 32 Township Number T 27 S Range Number R 1 E W

2 WELL OWNER: Last Name: Business: KDHE (Derby Station) Address: 1000 SW Jackson, Suite 410 City Topeka State: KS ZIP: 66612 Street or Rural Address where well is located (if unknown, distance and direction from nearest town or intersection): 1601 S. Main St Wichita, Kansas 67213

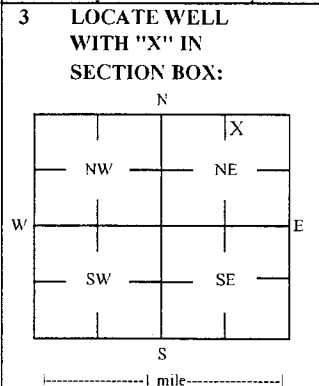

3 LOCATE WELL WITH "X" IN SECTION BOX: 4 DEPTH OF COMPLETED WELL: 25 ft Depth(s) Groundwater Encountered: 1) 25 ft 2) 3) 4) Dry Well WELL'S STATIC WATER LEVEL: 19.35 ft. X below land surface, measured on (mo-day-yr) 4/11/18

5 Latitude: 37.66417 (decimal degrees) Longitude: 97.33885 (decimal degrees) Horizontal Datum: WGS 84 NAD 83 X NAD 27 Source for Latitude/Longitude: GPS (unit make/model) Land Survey X Topographic Map Online Mapper

6 Elevation 1281.84 ft Ground Level X TOC Source X Land Survey GPS Topographic Map Other

7 WELL WATER TO BE USED AS: 1 Domestic: Household Lawn & Garden Livestock Irrigation Feedlot Industrial 5 Public Water Supply: well ID 6 Dewatering: how many wells? 7 Aquifer Recharge: well ID 8 X Monitoring: well ID MW6 9 Environmental Remediation: well ID Air Sparge Soil Vapor Extraction Recovery Injection 10 Oil Field Water Supply: lease 11 Test Hole: well ID Cased Uncased Geotechnical 12 Geothermal: How many bores? a) Closed Loop Horizontal Vertical b) Open Loop Surface Discharge Inj. of Water Other (specify):

Was a chemical/bacteriological sample submitted to KDHE? Yes No X No If yes, date sample was submitted: Water well disinfected? Yes No X No

8 TYPE OF CASING USED: Steel PVC X Other CASING JOINTS: Glued Clamped Welded X Threaded Casing diameter 2 in. to 15 ft. Diameter in. to ft. Diameter in. to ft. Casing height above land surface -0.33 in. Weight lbs./ft. Well thickness or gauge No TYPE OF SCREEN OR PERFORATION MATERIAL: Steel Stainless Steel Fiberglass PVC X Other (Specify) Brass Galvanized Steel Concrete tile None used (open hole) SCREEN OR PERFORATION OPENINGS ARE: Continuous Slot X Mill Slot Gauze Wrapped Torch Cut Drilled Holes Other (Specify) Louvered Shutter Key Punched Wire Wrapped Saw Cut None (Open Hole) SCREEN-PERFORATED INTERVALS: From 15 ft. to 25 ft. GRAVEL PACK INTERVALS: From 13 ft. to 25 ft.

9 GROUT MATERIAL: Neat cement Cement grout X Bentonite X Other Concrete: 0-0.7' Grout intervals: From 0.7 ft. to 13 ft. From ft. to ft. From ft. to ft.

Nearest source of possible contamination: Septic Tank Lateral Lines Pit Privy Livestock Pens Insecticide Storage Sewer Lines Cess Pool Sewage Lagoon X Fuel Storage Abandoned Water Well Watertight Sewer Lines Seepage Pit Feedyard Fertilizer Storage Oil Well / Gas Well Other (Specify): Direction from well? NE Distance from well? ~140 ft

Table with columns: FROM, TO, LITHOLOGIC LOG, FROM, TO, LITHO. LOG (cont.) or PLUGGING INTERVALS. Rows include: 0-0.33 Asphalt, 0.33-6 Silty clay, 6-11 Silty clay with increasing silt, 11-12.5 Clayey silt, 12.5-16 Fine silty sand, 16-25 Coarse clayey sand.

Notes: KDHE ID: Derby Station; U2-087-12671 Target of monitoring well is shallow groundwater, <20' of grout was installed at the direction of KDHE.

11 CONTRACTOR'S OR LANDOWNER'S CERTIFICATION: This water well was X constructed, reconstructed, or plugged under my jurisdiction and was completed on (mo-day-year) 4/10/18 and this record is true to the best of my knowledge and belief. Kansas Water Well Contractor's License No 757 This Water Well Record was completed on (mo-day-year) 5/2/18 under the business name of Larsen & Associates, Inc. Signature

SEDCI WICK

# DENNIS L HANDKE

1820 NW 59th Terrace  
TOPEKA, KANSAS 66618  
785-286-4047 Home  
785-286-1990 Fax

Jessica Chapman  
Larsen & Associates  
1311 E. 25<sup>th</sup> Street, Suite B  
Lawrence, Kansas, 66046

April 24, 2018  
Revised May 1, 2018

RE: Monitor Well Elevation Survey  
110 W. Harry, Wichita, Kansas

Proj. 18-00L  
Derby Station  
U2-087-12671

Bench Mark: Chisled Sq. on NW corner of concrete signal light base at Southeast corner of property.  
Elev: 1146.95      North 26      West 782      (from SE Cor. Sec. 29-27-1E)

|      |          |         |       |      |   |
|------|----------|---------|-------|------|---|
| MW-1 | rim      | 1282.27 | South | 47   | NE1/4,NW1/4,NE1/4,NE1/4 (Sec. 32-27-1E) |
|      | top pipe | 1281.73 | West  | 835  | Lat= 37.66420 Long = 97.33842           |
| MW-2 | rim      | 1282.73 | South | 97   | NE1/4,NW1/4,NE1/4,NE1/4 (Sec. 32-27-1E) |
|      | top pipe | 1282.48 | West  | 804  | Lat= 37.66406 Long = 97.33832           |
| MW-3 | rim      | 1282.07 | North | 129  | SE1/4,SW1/4,SE1/4,SE1/4                 |
|      | top pipe | 1281.72 | West  | 781  | Lat= 37.66468 Long = 97.33824           |
| MW-4 | rim      | 1282.57 | South | 55   | NW1/4,NW1/4,NE1/4,NE1/4 (Sec. 32-27-1E) |
|      | top pipe | 1282.23 | West  | 1085 | Lat= 37.66418 Long = 97.33929           |
| MW-5 | rim      | 1282.54 | North | 124  | SW1/4,SW1/4,SE1/4,SE1/4                 |
|      | top pipe | 1282.32 | West  | 1100 | Lat= 37.66467 Long = 97.33934           |
| MW-6 | rim      | 1282.17 | South | 58   | NE1/4,NW1/4,NE1/4,NE1/4 (Sec. 32-27-1E) |
|      | top pipe | 1281.84 | West  | 959  | Lat= 37.66417 Long = 97.33885           |

MAY 12 2018

Lat & Long derived existing Wichita East 7.5' quad map. WGS 84.

BUREAU OF WATER

Elevation established from City of Wichita BM. NAVD 27.

If you have any questions, please feel free to call me. Thank you for the opportunity to be of service to you.

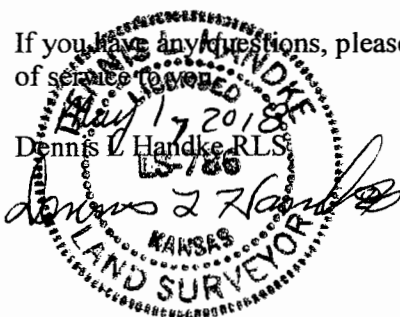

SENECA County  
 sec 29 27S 1E  
 SEDGWICK

NOTE: Figures exhibited within this report are only to be used within the context of this report. Placement of property lines, wells, structures, and roads is based on the available information from county appraiser maps, surveys, site visits, and/or previous vendor reports and should be considered approximate.

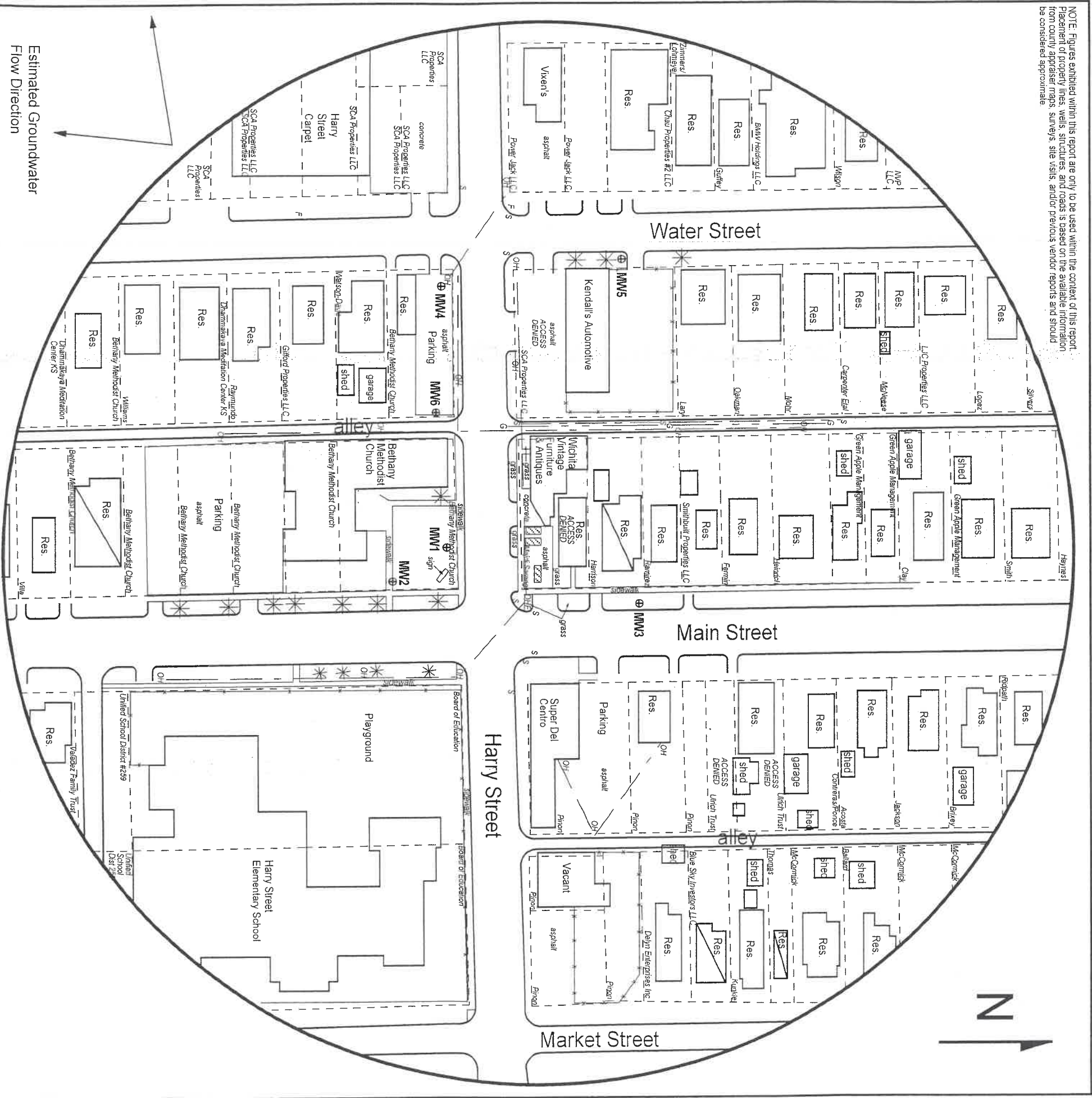

FIGURE 2.2 - 500 FT RADIUS AREA BASE MAP

1311 E 25th St., Suite B  
Lawrence, KS 66046

(785) 841-8707 office  
(785) 865-4282 fax

**PROJECT:**  
 Derby Station  
 110 W Harry  
 Wichita, KS  
 KDHE ID: U2-087-12671  
 Date: 4/11/18

**LEGEND:**

- Approximate Location of Former UST Basin
- Building with Basement
- Approximate Location of Property Line
- Monitoring Well (Installed 4/9-10/18)
- Fire Hydrant
- Gas Lines (2 - 6 ft BGS)
- Overhead Lines (25-40 ft high)
- Sanitary Sewer (2 - 6 ft BGS)

NOTE: Utility depths, heights and locations are approximate.

0 100 feet

**RECEIVED**  
 MAY 1 2 2018  
 BUREAU OF WATER