

| | | | | |
|---|--|-----------------------------|----------------------------------|---|
| 1 LOCATION OF WATER WELL: County: Sedgwick | Fraction se ¼ se ¼ se ¼ sw ¼ | Section Number 31 | Township Number T 27 S | Range Number 1 <input checked="" type="checkbox"/> E <input type="checkbox"/> W |
|---|--|-----------------------------|----------------------------------|---|

Street/Rural Address of Well Location; if unknown, distance & direction from nearest town or intersection: If at owner's address, check here basement - 2102 W Pawnee Ct Wichita KS 67213

Global Positioning Systems (GPS) information:
 Latitude: _____ (in decimal degrees)
 Longitude: _____ (in decimal degrees)
 Elevation: _____
 Horizontal Datum: WGS84, NAD83, NAD27
 Collection Method: _____
 GPS unit (Make/Model: _____)
 Digital Map/Photo, Topographic Map, Land Survey
 Est. Accuracy: < 3 m, 3-5 m, 5-15 m, > 15 m

2 WATER WELL OWNER: Delmar Chrans Est
 RR#, St. Address, Box #: PO BOX 1002
 City, State ZIP Code: Derby KS 67037

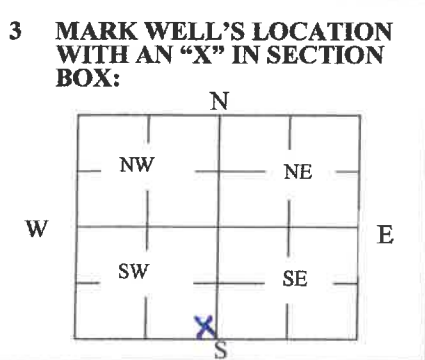

4 DEPTH OF WELL 12 ft.
 WELL'S STATIC WATER LEVEL 7 ft
 WELL WAS USED AS:
 Domestic Public Water Supply Dewatering
 Irrigation Oil Field Water Supply Monitoring
 Feedlot Domestic (Lawn & Garden) Injection Well
 Industrial Air Conditioning Other _____
 Was a chemical/bacteriological sample submitted to Department? Yes No

5 TYPE OF BLANK CASING USED:

Steel RMP (SR) Wrought Fiberglass Other (Specify below)
 PVC ABS Asbestos-Cement Concrete Tile Tin

Blank casing diameter 6 in. Was casing pulled? Yes No If yes, how much 2.5 ft
 Casing height above or below land surface 30 below in.

6 GROUT PLUG MATERIAL: Neat cement Cement grout Bentonite Other _____

Grout Plug Intervals: From 7 ft. to 5 ft., From 2 ft. to 0 ft., From _____ ft. to _____ ft.

What is the nearest source of possible contamination:
 Septic tank Seepage pit Fuel storage Other (specify below)
 Sewer lines Pit privy Fertilizer storage sump pit
 Watertight sewer lines Sewage lagoon Insecticide storage _____
 Lateral lines Feedyard Abandoned water well _____
 Cess pool Livestock pens Oil well/Gas well _____
 Direction from well? _____
 How many feet? 6

| FROM | TO | PLUGGING MATERIALS | FROM | TO | PLUGGING MATERIALS |
|------|----|--------------------|------|----|--------------------|
| 2 | 0 | Cement | | | |
| 5 | 2 | Sand | | | |
| 7 | 5 | Bentonite | | | |
| 12 | 7 | Sand | | | |
| | | | | | |
| | | | | | |

7 CONTRACTOR'S OR LANDOWNER'S CERTIFICATION: This water well was plugged under my jurisdiction and was completed on (mo/day/year) 5/26/18 and this record is true to the best of my knowledge and belief. Kansas Water Well Contractor's License No. 628. This Water Well Record was completed on (mo/day/year) 5/29/18 under the business name of JMEnterprises by (signature)

Send one white copy to Kansas Department of Health & Environment, Geology Section, 1000 SW Jackson Street, Ste. 420, Topeka, KS 66612-1367. Send one copy to WATER WELL OWNER and retain one for your records.
 Visit us at <http://www.kdheks.gov/waterwell/index.html> Telephone 785-296-5524.