

WATER WELL RECORD Form WWC-5

Original Record Correction Change in Well Use

Division of Water Resources App. No.

Well ID

1 LOCATION OF WATER WELL: County: Sedgewick	Fraction SE ¼ SE ¼ SE ¼ NE ¼	Section Number 25	Township Number T 27 S	Range Number R 1 <input checked="" type="checkbox"/> E <input type="checkbox"/> W
--	---------------------------------	-----------------------------	----------------------------------	---

2 WELL OWNER: Last Name: D & T Station Address: 895 South Woodlawn City: Wichita State: KS ZIP: 67218	Street or Rural Address where well is located (if unknown, distance and direction from nearest town or intersection): If at owner's address, check here: <input type="checkbox"/> 877 Hillcrest St Wichita, KS
---	--

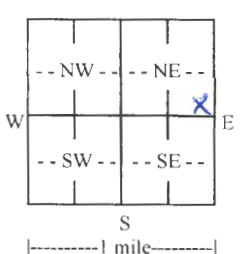
3 LOCATE WELL WITH "X" IN SECTION BOX: N  S ----- 1 mile -----	4 DEPTH OF COMPLETED WELL: 16 ft. Depth(s) Groundwater Encountered: 1) ft. 2) N/A ft. 3) N/A ft., or 4) <input type="checkbox"/> Dry Well WELL'S STATIC WATER LEVEL: ft. <input checked="" type="checkbox"/> below land surface, measured on (mo-day-yr)..... <input type="checkbox"/> above land surface, measured on (mo-day-yr)..... Pump test data: Well water was N/A ft. after N/A hours pumping N/A gpm Well water was N/A ft. after N/A hours pumping N/A gpm Estimated Yield: N/A gpm Bore Hole Diameter: 8.25 in. to 16 ft. and N/A in. to N/A ft.	5 Latitude: 37.672392 (decimal degrees) Longitude: -97.263039 (decimal degrees) Horizontal Datum: <input type="checkbox"/> WGS 84 <input checked="" type="checkbox"/> NAD 83 <input type="checkbox"/> NAD 27 Source for Latitude/Longitude: <input type="checkbox"/> GPS (unit make/model:) (WAAS enabled? <input type="checkbox"/> Yes <input type="checkbox"/> No) <input type="checkbox"/> Land Survey <input checked="" type="checkbox"/> Topographic Map <input type="checkbox"/> Online Mapper:
		6 Elevation: 1343 ft. <input checked="" type="checkbox"/> Ground Level <input type="checkbox"/> TOC Source: <input type="checkbox"/> Land Survey <input type="checkbox"/> GPS <input checked="" type="checkbox"/> Topographic Map <input type="checkbox"/> Other

7 WELL WATER TO BE USED AS:

<input type="checkbox"/> Household <input type="checkbox"/> Lawn & Garden <input type="checkbox"/> Livestock	<input type="checkbox"/> Public Water Supply: well ID	<input type="checkbox"/> Oil Field Water Supply: lease
<input type="checkbox"/> Irrigation	<input type="checkbox"/> Dewatering: how many wells?	<input type="checkbox"/> Test Hole: well ID
<input type="checkbox"/> Feedlot	<input type="checkbox"/> Aquifer Recharge: well ID	<input type="checkbox"/> Cased <input type="checkbox"/> Uncased <input type="checkbox"/> Geotechnical
<input type="checkbox"/> Industrial	<input checked="" type="checkbox"/> Monitoring: well ID MW-13	<input type="checkbox"/> Geothermal: how many bores?
	<input type="checkbox"/> Environmental Remediation: well ID	a) Closed Loop <input type="checkbox"/> Horizontal <input type="checkbox"/> Vertical
	<input type="checkbox"/> Air Sparge <input type="checkbox"/> Soil Vapor Extraction	b) Open Loop <input type="checkbox"/> Surface Discharge <input type="checkbox"/> Inj. of Water
	<input type="checkbox"/> Recovery <input type="checkbox"/> Injection	<input type="checkbox"/> Other (specify):

Was a chemical/bacteriological sample submitted to KDHE? Yes No If yes, date sample was submitted:

Water well disinfected? Yes No

8 TYPE OF CASING USED: Steel PVC Other CASING JOINTS: Glued Clamped Welded Threaded

Casing diameter **2** in. to **3** ft., Diameter **N/A** in. to **N/A** ft., Diameter **N/A** in. to **N/A** ft.

Casing height above land surface **0** in. Weight **N/A** lbs./ft. Wall thickness or gauge No. **Sch. 40**

TYPE OF SCREEN OR PERFORATION MATERIAL:
 Steel Stainless Steel Fiberglass PVC Other (Specify)

Brass Galvanized Steel Concrete tile None used (open hole)

SCREEN OR PERFORATION OPENINGS ARE:
 Continuous Slot Mill Slot Gauze Wrapped Torch Cut Drilled Holes Other (Specify)

Louvered Shutter Key Punched Wire Wrapped Saw Cut None (Open Hole)

SCREEN-PERFORATED INTERVALS: From **3** ft. to **16** ft., From **N/A** ft. to **N/A** ft., From **N/A** ft. to **N/A** ft.

GRAVEL PACK INTERVALS: From **2.5** ft. to **16** ft., From **N/A** ft. to **N/A** ft., From **N/A** ft. to **N/A** ft.

9 GROUT MATERIAL: Neat cement Cement grout Bentonite Other **Concrete 0 to 2**

Grout Intervals: From **2** ft. to **2.5** ft., From **N/A** ft. to **N/A** ft., From **N/A** ft. to **N/A** ft.

Nearest source of possible contamination:

<input type="checkbox"/> Septic Tank	<input type="checkbox"/> Lateral Lines	<input type="checkbox"/> Pit Privy	<input type="checkbox"/> Livestock Pens	<input type="checkbox"/> Insecticide Storage
<input type="checkbox"/> Sewer Lines	<input type="checkbox"/> Cess Pool	<input type="checkbox"/> Sewage Lagoon	<input checked="" type="checkbox"/> Fuel Storage	<input type="checkbox"/> Abandoned Water Well
<input type="checkbox"/> Watertight Sewer Lines	<input type="checkbox"/> Seepage Pit	<input type="checkbox"/> Feedyard	<input type="checkbox"/> Fertilizer Storage	<input type="checkbox"/> Oil Well/Gas Well
<input type="checkbox"/> Other (Specify)				

Direction from well? **West** Distance from well? **175** ft.

10 FROM	TO	LITHOLOGIC LOG	FROM	TO	LITHO. LOG (cont.) or PLUGGING INTERVALS
0	1.5	soft, moist, dk brn, non-plastic silty CLAY			
1.5	8	med, moist, brn, low plastic, silty CLAY			
8	16	stiff, moist, ong-brn, low plastic silty CLAY			
Notes:					

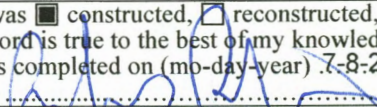
11 CONTRACTOR'S OR LANDOWNER'S CERTIFICATION: This water well was constructed, reconstructed, or plugged under my jurisdiction and was completed on (mo-day-year) **6-7-2018** and this record is true to the best of my knowledge and belief. Kansas Water Well Contractor's License No. **759** This Water Well Record was completed on (mo-day-year) **7-8-2018** under the business name of **RAZEK Environmental, LLC** Signature 

Mail 1 white copy along with a fee of \$5.00 for each constructed well to: Kansas Department of Health and Environment, Bureau of Water, GWTS Section, 1000 SW Jackson St., Suite 420, Topeka, Kansas 66612-1367. Mail one to Water Well Owner and retain one for your records. Telephone 785-296-5524.

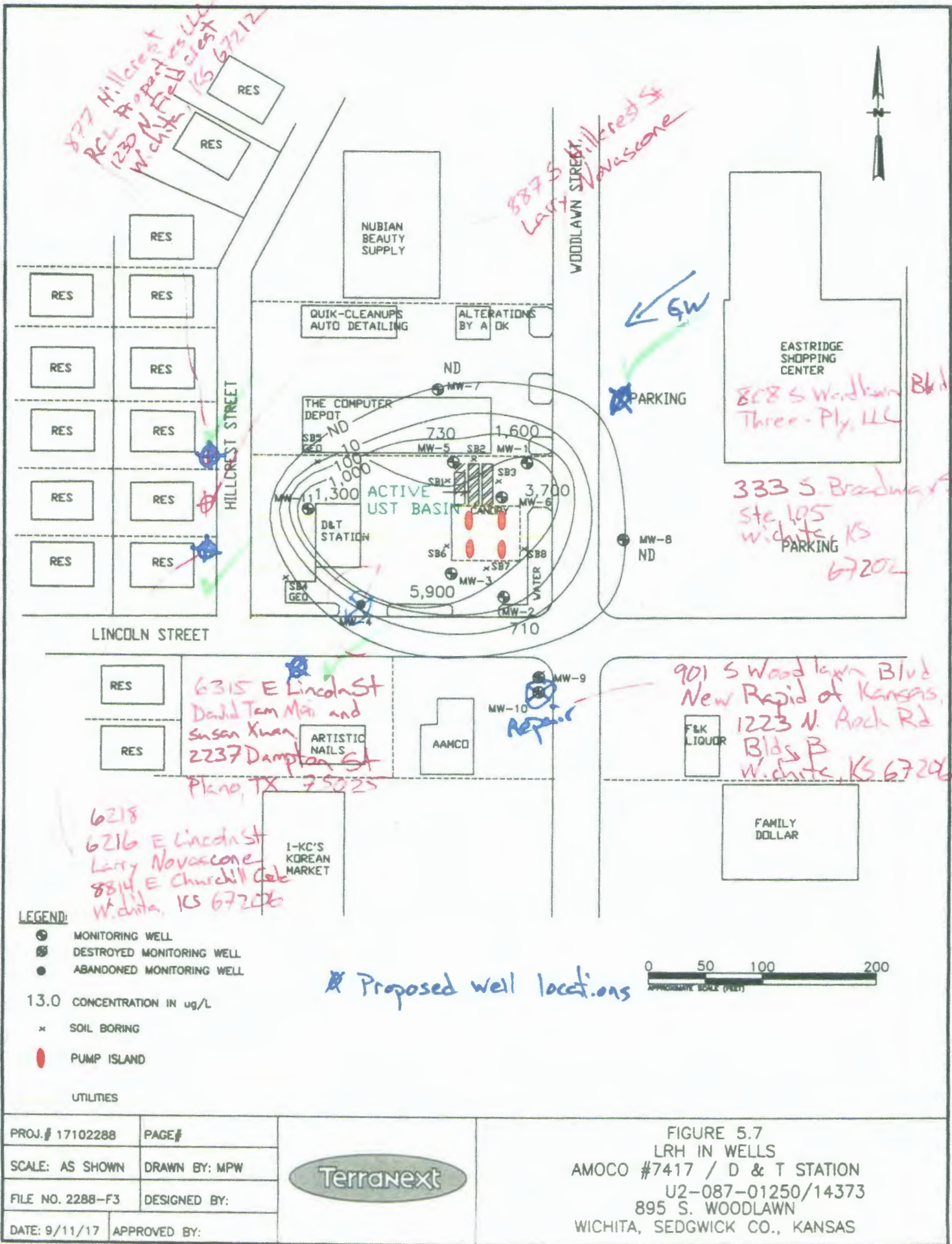

877 Hillcrest
 RCL Property LLC
 1230 N. Fieldcrest
 Wichita, KS 67212

887 S. Hillcrest St
 Larry Novascone

808 S Woodlawn Blvd
 Three-Ply, LLC

333 S. Broadway St
 Ste 105
 Wichita, KS
 67202

6315 E Lincoln St
 David Tam Mai and
 Susan Xuan
 2237 Dampson St
 Plano, TX 75025

901 S Woodlawn Blvd
 New Rapid of Kansas, LLC
 1223 N. Rock Rd
 Bldg B
 Wichita, KS 67206

6218
 6216 E Lincoln St
 Larry Novascone
 8814 E Churchill Cole
 Wichita, KS 67206

LEGEND:

- ⊕ MONITORING WELL
- ⊖ DESTROYED MONITORING WELL
- ABANDONED MONITORING WELL
- 13.0 CONCENTRATION IN ug/L
- x SOIL BORING
- PUMP ISLAND
- UTILITIES

⊕ Proposed well locations

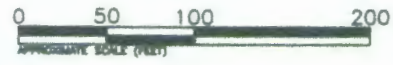

PROJ.# 17102288	PAGE#
SCALE: AS SHOWN	DRAWN BY: MPW
FILE NO. 2288-F3	DESIGNED BY:
DATE: 9/11/17	APPROVED BY:



FIGURE 5.7
 LRH IN WELLS
 AMOCO #7417 / D & T STATION
 U2-087-01250/14373
 895 S. WOODLAWN
 WICHITA, SEDGWICK CO., KANSAS