

**WATER WELL RECORD Form WWC-5**

Division of Water Resources App. No.

Well ID VIM-MIP-1

Original Record  Correction  Change in Well Use

<b>1 LOCATION OF WATER WELL:</b> County: <u>Segwick</u>	Fraction SW ¼ SW ¼ NW ¼ NE ¼	Section Number <u>4</u>	Township Number T <u>27</u> S	Range Number R <u>1</u> <input checked="" type="checkbox"/> E <input type="checkbox"/> W
--	---------------------------------	----------------------------	----------------------------------	---

<b>2 WELL OWNER:</b> Last Name: <u>City of Wichita</u> Business: <u>City of Wichita</u> Address: <u>1900 E. 9th Street</u> Address: City: <u>Wichita</u> State: <u>KS</u> ZIP: <u>67214</u>	First: _____ Street or Rural Address where well is located (if unknown, distance and direction from nearest town or intersection): If at owner's address, check here: <input type="checkbox"/> <u>2811 N Ohio. Waste Connections</u>
---	--

**3 LOCATE WELL WITH "X" IN SECTION BOX:**

N

W	NW	X	NE	E
	--	--	--	
	SW	SE		
	S			

-----1 mile-----

**4 DEPTH OF COMPLETED WELL:** 13 ft.

Depth(s) Groundwater Encountered: 1) 13 ft.  
 2) \_\_\_\_\_ ft. 3) \_\_\_\_\_ ft., or 4)  Dry Well

WELL'S STATIC WATER LEVEL: \_\_\_\_\_ ft.

below land surface, measured on (mo-day-yr) \_\_\_\_\_  
 above land surface, measured on (mo-day-yr) \_\_\_\_\_

Pump test data: Well water was \_\_\_\_\_ ft.  
 after \_\_\_\_\_ hours pumping \_\_\_\_\_ gpm  
 Well water was \_\_\_\_\_ ft.  
 after \_\_\_\_\_ hours pumping \_\_\_\_\_ gpm

Estimated Yield: \_\_\_\_\_ gpm  
 Bore Hole Diameter: 3.25 in. to 13 ft. and \_\_\_\_\_ in. to \_\_\_\_\_ ft.

**5 Latitude:** 37.733892 (decimal degrees)  
**Longitude:** -97.326174 (decimal degrees)  
 Horizontal Datum:  WGS 84  NAD 83  NAD 27  
 Source for Latitude/Longitude:  
 GPS (unit make/model: \_\_\_\_\_)  
 (WAAS enabled?  Yes  No)  
 Land Survey  Topographic Map  
 Online Mapper: \_\_\_\_\_

**6 Elevation:** NA ft.  Ground Level  TOC  
 Source:  Land Survey  GPS  Topographic Map  
 Other \_\_\_\_\_

**7 WELL WATER TO BE USED AS:**

1. Domestic: <input type="checkbox"/> Household <input type="checkbox"/> Lawn & Garden <input type="checkbox"/> Livestock 2. <input type="checkbox"/> Irrigation 3. <input type="checkbox"/> Feedlot 4. <input type="checkbox"/> Industrial	5. <input type="checkbox"/> Public Water Supply: well ID _____ 6. <input type="checkbox"/> Dewatering: how many wells? _____ 7. <input type="checkbox"/> Aquifer Recharge: well ID _____ 8. <input checked="" type="checkbox"/> Monitoring: well ID <u>VIM-MIP-1</u> 9. Environmental Remediation: well ID _____ <input type="checkbox"/> Air Sparge <input type="checkbox"/> Soil Vapor Extraction <input type="checkbox"/> Recovery <input type="checkbox"/> Injection	10. <input type="checkbox"/> Oil Field Water Supply: lease _____ 11. Test Hole: well ID _____ <input type="checkbox"/> Cased <input type="checkbox"/> Uncased <input type="checkbox"/> Geotechnical 12. Geothermal: how many bores? _____ a) Closed Loop <input type="checkbox"/> Horizontal <input type="checkbox"/> Vertical b) Open Loop <input type="checkbox"/> Surface Discharge <input type="checkbox"/> Inj. of Water 13. <input type="checkbox"/> Other (specify): _____
---	--	---

**Was a chemical/bacteriological sample submitted to KDHE?**  Yes  No If yes, date sample was submitted: \_\_\_\_\_

Water well disinfected?  Yes  No

**8 TYPE OF CASING USED:**  Steel  PVC  Other \_\_\_\_\_ CASING JOINTS:  Glued  Clamped  Welded  Threaded

Casing diameter 1 in. to 6 ft., Diameter \_\_\_\_\_ in. to \_\_\_\_\_ ft., Diameter \_\_\_\_\_ in. to \_\_\_\_\_ ft.  
 Casing height above land surface 36 in. Weight \_\_\_\_\_ lbs./ft. Wall thickness or gauge No. Sch 40

**TYPE OF SCREEN OR PERFORATION MATERIAL:**  
 Steel  Stainless Steel  Fiberglass  PVC  Other (Specify) \_\_\_\_\_  
 Brass  Galvanized Steel  Concrete tile  None used (open hole)

**SCREEN OR PERFORATION OPENINGS ARE:**  
 Continuous Slot  Mill Slot  Gauze Wrapped  Torch Cut  Drilled Holes  Other (Specify) \_\_\_\_\_  
 Louvered Shutter  Key Punched  Wire Wrapped  Saw Cut  None (Open Hole)

**SCREEN-PERFORATED INTERVALS:** From 6 ft. to 13 ft., From \_\_\_\_\_ ft. to \_\_\_\_\_ ft., From \_\_\_\_\_ ft. to \_\_\_\_\_ ft.  
**GRAVEL PACK INTERVALS:** From 4 ft. to 13 ft., From \_\_\_\_\_ ft. to \_\_\_\_\_ ft., From \_\_\_\_\_ ft. to \_\_\_\_\_ ft.

**9 GROUT MATERIAL:**  Neat cement  Cement grout  Bentonite  Other \_\_\_\_\_

Grout Intervals: From 0 ft. to 4 ft., From \_\_\_\_\_ ft. to \_\_\_\_\_ ft., From \_\_\_\_\_ ft. to \_\_\_\_\_ ft.

**Nearest source of possible contamination:**  
 Septic Tank  Lateral Lines  Pit Privy  Livestock Pens  Insecticide Storage  
 Sewer Lines  Cess Pool  Sewage Lagoon  Fuel Storage  Abandoned Water Well  
 Watertight Sewer Lines  Seepage Pit  Feedyard  Fertilizer Storage  Oil Well/Gas Well  
 Other (Specify) \_\_\_\_\_

Direction from well? \_\_\_\_\_ Distance from well? \_\_\_\_\_ ft.

10 FROM	TO	LITHOLOGIC LOG	FROM	TO	LITHO. LOG (cont.) or PLUGGING INTERVALS
0	1	Gravel			
1	7.5	Clay, dark brown, moist, dense			
7.5	8.5	Sand, light brown, fine, friable			
8.5	12	Clay, brown, soft, moist, petroleum stain			
12	13	Sand, brown, fine, silty, free petroleum product			
<b>Notes:</b>					

**11 CONTRACTOR'S OR LANDOWNER'S CERTIFICATION:** This water well was  constructed,  reconstructed, or  plugged under my jurisdiction and was completed on (mo-day-year) 3-16-2020 and this record is true to the best of my knowledge and belief. Kansas Water Well Contractor's License No. 604. This Water Well Record was completed on (mo-day-year) 5/15/2020 under the business name of Environmental Priority Service, Inc. Signature [Signature]

Mail 1 white copy along with a fee of \$5.00 for each constructed well to: Kansas Department of Health and Environment, Bureau of Water, GWTS Section, 1000 SW Jackson St., Suite 420, Topeka, Kansas 66612-1367. Mail one to Water Well Owner and retain one for your records. Telephone 785-296-5524. Visit us at <http://www.kdheks.gov/waterwell/index.html> KSA 82a-1212 **Revised 7/10/2015**

NOTE: Figures exhibited within this report are only to be used within the context of this report. Placement of property lines, wells, structures, and roads is based on the available information from county appraiser maps, surveys, site visits, and/or previous vendor reports and should be considered approximate.

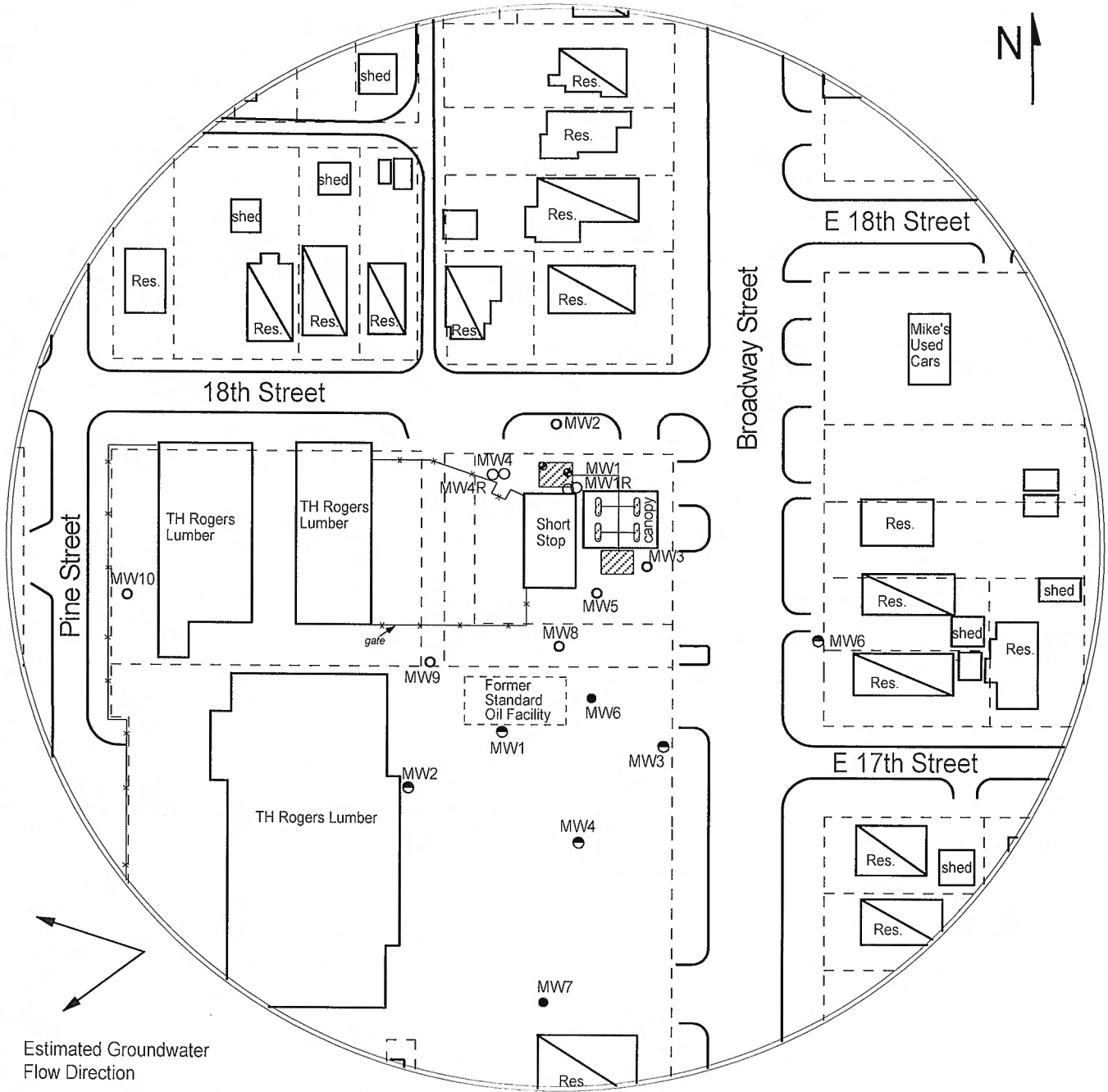
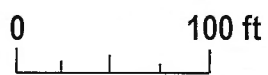

FIGURE 1 - 350 FT RADIUS AREA BASE MAP

- LEGEND:**
- Approximate Location of Active UST Basin, Product Lines & Pump Islands
  - Building with Basement
  - Approximate Location of Property Line
  - Existing Monitoring Well
  - Former Standard Oil Wells(U3-019-14985)
  - Observation Well
  - Plugged/Destroyed Well



**PROJECT:**  
 Short Stop  
 1711 N. Broadway  
 Pittsburg, KS  
 KDHE ID: U3-019-13788/  
 14228  
 Date: 5/18-19/20



1311 E 25th St. Suite B    785-841-8707 office  
 Lawrence, KS 66046    785-865-4282 fax