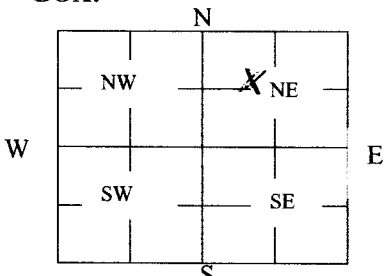

1 LOCATION OF WATER WELL: County: <u>Sedgwick</u>	Fraction <u>SW 1/4 SE 1/4 NW 1/4 NE 1/4</u>	Section Number <u>9</u>	Township Number <u>T 27 S</u>	Range Number <u>1</u> <input checked="" type="checkbox"/> E <input type="checkbox"/> W
---	--	----------------------------	----------------------------------	---

Street/Rural Address of Well Location; if unknown, distance & direction from nearest town or intersection: If at owner's address, check here <input type="checkbox"/> Former Coastal Refinery, 2461 N. New York Street, Wichita, Ks.	Global Positioning Systems (GPS) information: Latitude: <u>37.71982282</u> (in decimal degrees) Longitude: <u>-97.32315102</u> (in decimal degrees) Elevation: <u>1309.19</u> Horizontal Datum: <input type="checkbox"/> WGS84, <input checked="" type="checkbox"/> NAD83, <input type="checkbox"/> NAD27 Collection Method: _____ Est. Accuracy: <input type="checkbox"/> < 3 m, <input type="checkbox"/> 3-5 m, <input type="checkbox"/> 5-15 m, <input type="checkbox"/> > 15 m
--	---

2 WATER WELL OWNER: <u>El Paso, LLC</u> RR#, St. Address, Box #: <u>1515 Des Peres Road, Suite 300</u> City, State ZIP Code: <u>St. Louis, MO. 63131</u>	<input type="checkbox"/> GPS unit (Make/Model: _____) <input checked="" type="checkbox"/> Digital Map/Photo, <input type="checkbox"/> Topographic Map, <input type="checkbox"/> Land Survey Est. Accuracy: <input type="checkbox"/> < 3 m, <input type="checkbox"/> 3-5 m, <input type="checkbox"/> 5-15 m, <input type="checkbox"/> > 15 m
---	---

3 MARK WELL'S LOCATION WITH AN "X" IN SECTION BOX: 	4 DEPTH OF WELL <u>19.17</u> ft. WELL'S STATIC WATER LEVEL <u>14.31</u> ft WELL WAS USED AS: <input type="checkbox"/> Domestic <input type="checkbox"/> Public Water Supply <input type="checkbox"/> Dewatering <input type="checkbox"/> Irrigation <input type="checkbox"/> Oil Field Water Supply <input checked="" type="checkbox"/> Monitoring <input type="checkbox"/> Feedlot <input type="checkbox"/> Domestic (Lawn & Garden) <input type="checkbox"/> Injection Well <input type="checkbox"/> Industrial <input type="checkbox"/> Air Conditioning <input type="checkbox"/> Other _____ Was a chemical/bacteriological sample submitted to Department? Yes <input type="checkbox"/> No <input checked="" type="checkbox"/>
---	---

5 TYPE OF BLANK CASING USED:

<input type="checkbox"/> Steel	<input type="checkbox"/> RMP (SR)	<input type="checkbox"/> Wrought	<input type="checkbox"/> Fiberglass	<input checked="" type="checkbox"/> Other (Specify below)
<input checked="" type="checkbox"/> PVC	<input type="checkbox"/> ABS	<input type="checkbox"/> Asbestos-Cement	<input type="checkbox"/> Concrete Tile	<u>removed 1 ft. steel surface casing prote</u>

Blank casing diameter 4 in. Was casing pulled? Yes No If yes, how much 6 ft.
 Casing height above or below land surface 0 in.

6 GROUT PLUG MATERIAL: Neat cement Cement grout Bentonite Other _____

Grout Plug Intervals: From 0 ft. to 19.17 ft., From _____ ft. to _____ ft., From _____ ft. to _____ ft.

What is the nearest source of possible contamination:

<input type="checkbox"/> Septic tank	<input type="checkbox"/> Seepage pit	<input checked="" type="checkbox"/> Fuel storage	<input type="checkbox"/> Other (specify below)
<input type="checkbox"/> Sewer lines	<input type="checkbox"/> Pit privy	<input type="checkbox"/> Fertilizer storage	_____
<input type="checkbox"/> Watertight sewer lines	<input type="checkbox"/> Sewage lagoon	<input type="checkbox"/> Insecticide storage	_____
<input type="checkbox"/> Lateral lines	<input type="checkbox"/> Feedyard	<input type="checkbox"/> Abandoned water well	Direction from well? <u>N</u>
<input type="checkbox"/> Cess pool	<input type="checkbox"/> Livestock pens	<input type="checkbox"/> Oil well/Gas well	How many feet? <u>1000</u>

FROM	TO	PLUGGING MATERIALS	FROM	TO	PLUGGING MATERIALS
<u>0</u>	<u>19.17</u>	<u>Bentonite</u>			

7 CONTRACTOR'S OR LANDOWNER'S CERTIFICATION: This water well was plugged under my jurisdiction and was completed on (mo/day/year) 10-7-2020 and this record is true to the best of my knowledge and belief. Kansas Water Well Contractor's License No. 604. This Water Well Record was completed on (mo/day/year) 12/7/2020 under the business name of Environmental Priority Service, Inc. by (signature) [Signature]

Send one white copy to Kansas Department of Health & Environment, Geology Section, 1000 SW Jackson Street, Ste. 420, Topeka, KS 66612-1367. Send one copy to WATER WELL OWNER and retain one for your records.
 Visit us at <http://www.kdheks.gov/waterwell/index.html> Telephone 785-296-5524.

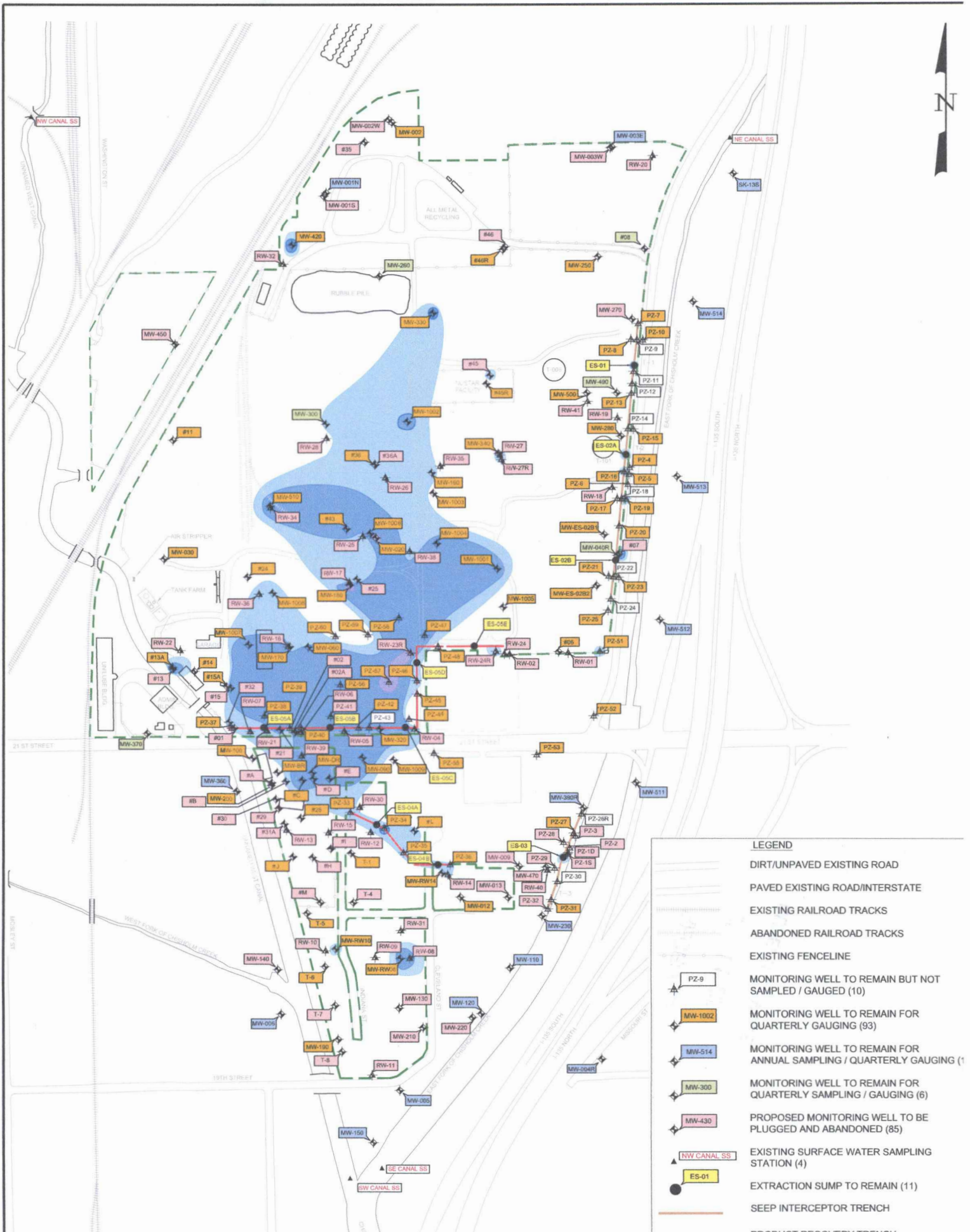

LEGEND	
	DIRT/UNPAVED EXISTING ROAD
	PAVED EXISTING ROAD/INTERSTATE
	EXISTING RAILROAD TRACKS
	ABANDONED RAILROAD TRACKS
	EXISTING FENCELINE
	MONITORING WELL TO REMAIN BUT NOT SAMPLED / GAUGED (10)
	MONITORING WELL TO REMAIN FOR QUARTERLY GAUGING (93)
	MONITORING WELL TO REMAIN FOR ANNUAL SAMPLING / QUARTERLY GAUGING (1)
	MONITORING WELL TO REMAIN FOR QUARTERLY SAMPLING / GAUGING (6)
	PROPOSED MONITORING WELL TO BE PLUGGED AND ABANDONED (85)
	EXISTING SURFACE WATER SAMPLING STATION (4)
	EXTRACTION SUMP TO REMAIN (11)
	SEEP INTERCEPTOR TRENCH

