

**WATER WELL PLUGGING RECORD Form WWC-5P**

KSA 82a-1212

ID NO.

RW-11

<b>1 LOCATION OF WATER WELL:</b> County: Sedgwick	Fraction SE ¼ SE ¼ NW ¼ NE ¼	Section Number 9	Township Number T 27 S	Range Number 1 <input checked="" type="checkbox"/> E <input type="checkbox"/> W
--	---------------------------------	---------------------	---------------------------	--

Street/Rural Address of Well Location; if unknown, distance & direction from nearest town or intersection: If at owner's address, check here  Former Coastal Refinery, 2461 N. New York Street, Wichita, Ks.

**Global Positioning Systems (GPS) information:**  
 Latitude: 37.719073 (in decimal degrees)  
 Longitude: -97.32266502 (in decimal degrees)  
 Elevation: 1312.49  
 Horizontal Datum:  WGS84,  NAD83,  NAD27  
 Collection Method:  
 GPS unit (Make/Model: \_\_\_\_\_)  
 Digital Map/Photo,  Topographic Map,  Land Survey  
 Est. Accuracy:  < 3 m,  3-5 m,  5-15 m,  > 15 m

**2 WATER WELL OWNER:** El Paso, LLC  
 RR#, St. Address, Box #: 1515 Des Peres Road, Suite 300  
 City, State ZIP Code: St. Louis, MO. 63131

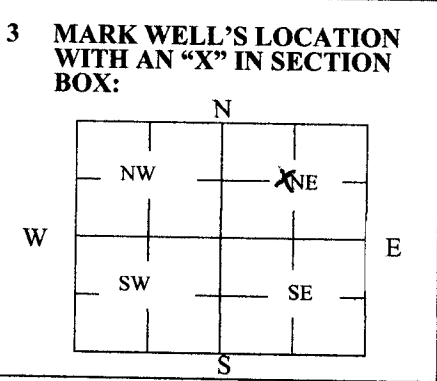

**4 DEPTH OF WELL** 29.49 ft.  
 WELL'S STATIC WATER LEVEL 18.22 ft.  
 WELL WAS USED AS:  
 Domestic  Public Water Supply  Dewatering  
 Irrigation  Oil Field Water Supply  Monitoring  
 Feedlot  Domestic (Lawn & Garden)  Injection Well  
 Industrial  Air Conditioning  Other recovery  
 Was a chemical/bacteriological sample submitted to Department? Yes  No

**5 TYPE OF BLANK CASING USED:**  
 Steel  RMP (SR)  Wrought  Fiberglass  Other (Specify below)  
 PVC  ABS  Asbestos-Cement  Concrete Tile  
 Blank casing diameter 12 in. Was casing pulled? Yes  No  If yes, how much 5.5 ft.  
 Casing height above or below land surface 30 in.

**6 GROUT PLUG MATERIAL:**  Neat cement  Cement grout  Bentonite  Other \_\_\_\_\_  
 Grout Plug Intervals: From 0 ft. to 29.49 ft., From \_\_\_\_\_ ft. to \_\_\_\_\_ ft., From \_\_\_\_\_ ft. to \_\_\_\_\_ ft.  
 What is the nearest source of possible contamination:  
 Septic tank  Seepage pit  Fuel storage  Other (specify below) contaminated site  
 Sewer lines  Pit privy  Fertilizer storage  
 Watertight sewer lines  Sewage lagoon  Insecticide storage  
 Lateral lines  Feedyard  Abandoned water well  
 Cess pool  Livestock pens  Oil well/Gas well  
 Direction from well? NA  
 How many feet? 0

FROM	TO	PLUGGING MATERIALS	FROM	TO	PLUGGING MATERIALS
0	29.49	Bentonite			

**7 CONTRACTOR'S OR LANDOWNER'S CERTIFICATION:** This water well was plugged under my jurisdiction and was completed on (mo/day/year) 10-28-2020 and this record is true to the best of my knowledge and belief. Kansas Water Well Contractor's License No. 604. This Water Well Record was completed on (mo/day/year) 12/7/2020 under the business name of Environmental Priority Service, Inc. by (signature) *[Signature]*

Send one white copy to Kansas Department of Health & Environment, Geology Section, 1000 SW Jackson Street, Ste. 420, Topeka, KS 66612-1367. Send one copy to WATER WELL OWNER and retain one for your records.  
 Visit us at <http://www.kdheks.gov/waterwell/index.html> Telephone 785-296-5524.

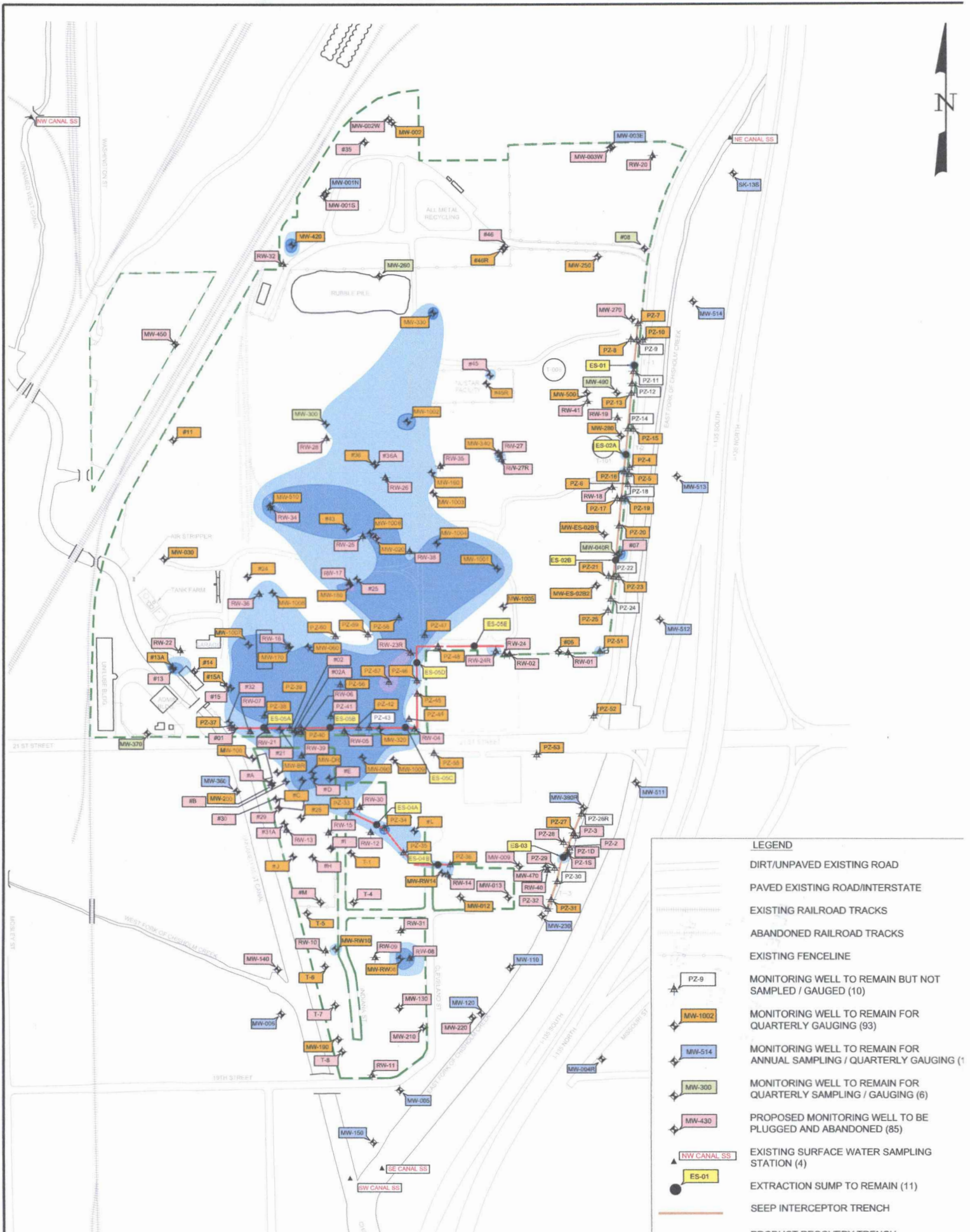

LEGEND	
	DIRT/UNPAVED EXISTING ROAD
	PAVED EXISTING ROAD/INTERSTATE
	EXISTING RAILROAD TRACKS
	ABANDONED RAILROAD TRACKS
	EXISTING FENCELINE
	MONITORING WELL TO REMAIN BUT NOT SAMPLED / GAUGED (10)
	MONITORING WELL TO REMAIN FOR QUARTERLY GAUGING (93)
	MONITORING WELL TO REMAIN FOR ANNUAL SAMPLING / QUARTERLY GAUGING (1)
	MONITORING WELL TO REMAIN FOR QUARTERLY SAMPLING / GAUGING (6)
	PROPOSED MONITORING WELL TO BE PLUGGED AND ABANDONED (85)
	EXISTING SURFACE WATER SAMPLING STATION (4)
	EXTRACTION SUMP TO REMAIN (11)
	SEEP INTERCEPTOR TRENCH

