

WATER WELL PLUGGING RECORD Form WWC-5P

KSA 82a-1212 ID NO.

RW-30

1 LOCATION OF WATER WELL: Fraction NE 1/4 NE 1/4 NW 1/4 NE 1/4 Section Number 9 Township Number T 27 S Range Number 1 E W
 County: Sedgwick

Street/Rural Address of Well Location; if unknown, distance & direction from nearest town or intersection: If at owner's address, check here Former Coastal Refinery, 2461 N. New York Street, Wichita, Ks.

Global Positioning Systems (GPS) information:
 Latitude: 37.72195064 (in decimal degrees)
 Longitude: -97.32278602 (in decimal degrees)
 Elevation: 1309.45
 Horizontal Datum: WGS84, NAD83, NAD27
 Collection Method:

2 WATER WELL OWNER: El Paso, LLC
 RR#, St. Address, Box #: 1515 Des Peres Road, Suite 300
 City, State ZIP Code: St. Louis, MO. 63131

GPS unit (Make/Model): _____
 Digital Map/Photo, Topographic Map, Land Survey
 Est. Accuracy: < 3 m, 3-5 m, 5-15 m, > 15 m

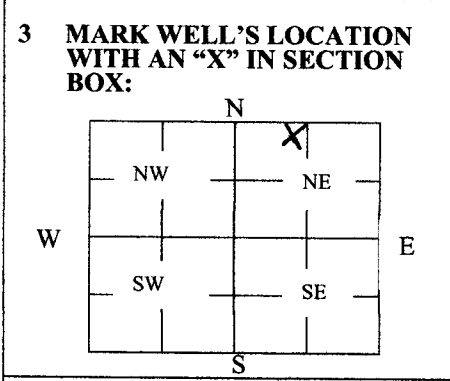

4 DEPTH OF WELL 30.78 ft.
 WELL'S STATIC WATER LEVEL 13.17 ft

WELL WAS USED AS:

Domestic Public Water Supply Dewatering
 Irrigation Oil Field Water Supply Monitoring
 Feedlot Domestic (Lawn & Garden) Injection Well
 Industrial Air Conditioning Other recovery

Was a chemical/bacteriological sample submitted to Department? Yes No

5 TYPE OF BLANK CASING USED:

Steel RMP (SR) Wrought Fiberglass Other (Specify below) _____
 PVC ABS Asbestos-Cement Concrete Tile

Blank casing diameter 14 in. Was casing pulled? Yes No If yes, how much 15 ft.
 Casing height above or below land surface 30 in.

6 GROUT PLUG MATERIAL: Neat cement Cement grout Bentonite Other _____

Grout Plug Intervals: From 0 ft. to 30.78 ft., From _____ ft. to _____ ft., From _____ ft. to _____ ft.

What is the nearest source of possible contamination:

Septic tank Seepage pit Fuel storage Other (specify below) contaminated site
 Sewer lines Pit privy Fertilizer storage
 Watertight sewer lines Sewage lagoon Insecticide storage
 Lateral lines Feedyard Abandoned water well Direction from well? NA
 Cess pool Livestock pens Oil well/Gas well How many feet? 0

FROM	TO	PLUGGING MATERIALS	FROM	TO	PLUGGING MATERIALS
0	30.78	Bentonite			

7 CONTRACTOR'S OR LANDOWNER'S CERTIFICATION: This water well was plugged under my jurisdiction and was completed on (mo/day/year) 10-28-2020 and this record is true to the best of my knowledge and belief. Kansas Water Well Contractor's License No. 604. This Water Well Record was completed on (mo/day/year) 12/7/2020 under the business name of Environmental Priority Service, Inc. by (signature) [Signature]

Send one white copy to Kansas Department of Health & Environment, Geology Section, 1000 SW Jackson Street, Ste. 420, Topeka, KS 66612-1367. Send one copy to WATER WELL OWNER and retain one for your records.
 Visit us at <http://www.kdheks.gov/waterwell/index.html> Telephone 785-296-5524.

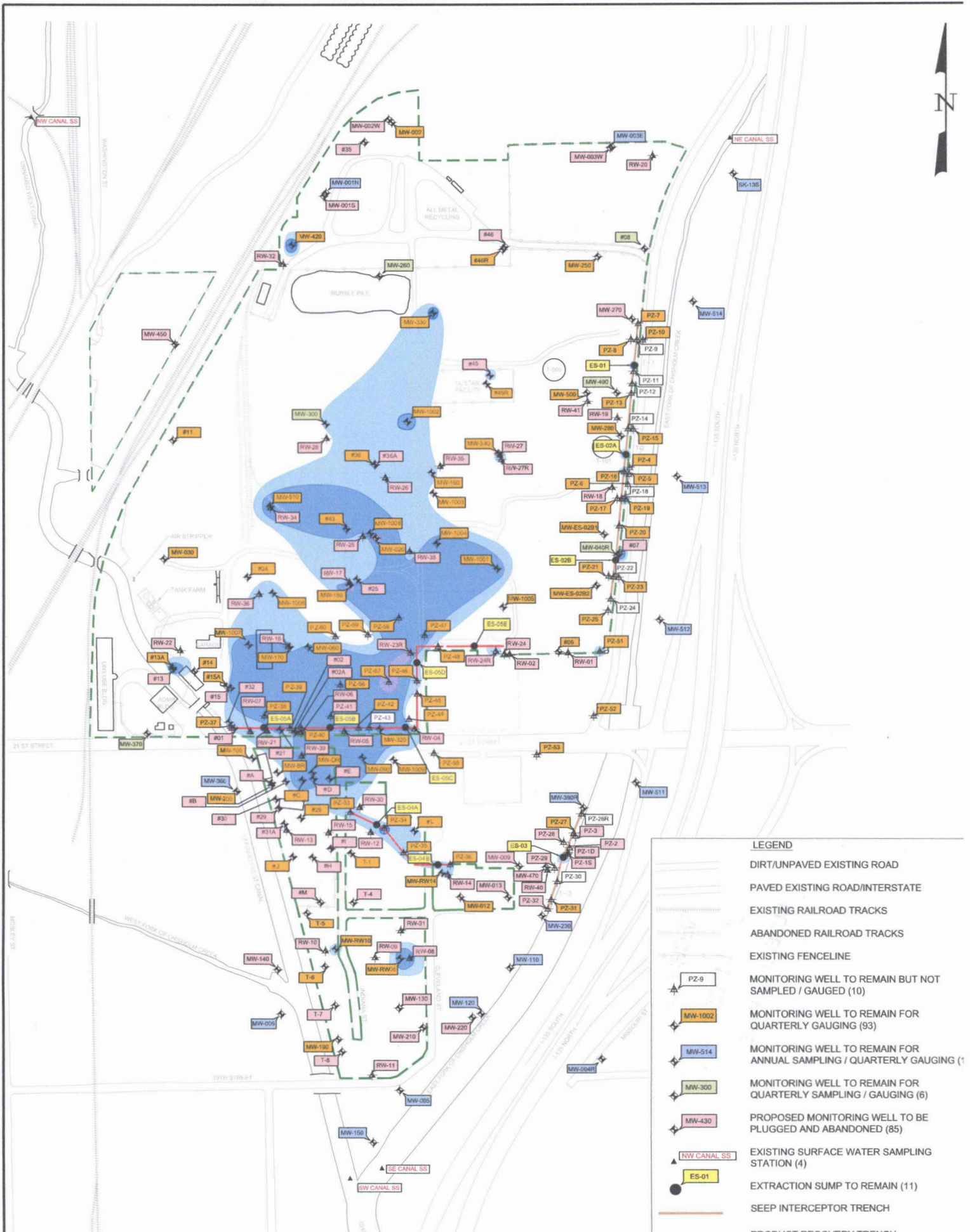

LEGEND	
	DIRT/UNPAVED EXISTING ROAD
	PAVED EXISTING ROAD/INTERSTATE
	EXISTING RAILROAD TRACKS
	ABANDONED RAILROAD TRACKS
	EXISTING FENCELINE
	MONITORING WELL TO REMAIN BUT NOT SAMPLED / GAUGED (10)
	MONITORING WELL TO REMAIN FOR QUARTERLY GAUGING (93)
	MONITORING WELL TO REMAIN FOR ANNUAL SAMPLING / QUARTERLY GAUGING (1)
	MONITORING WELL TO REMAIN FOR QUARTERLY SAMPLING / GAUGING (6)
	PROPOSED MONITORING WELL TO BE PLUGGED AND ABANDONED (85)
	EXISTING SURFACE WATER SAMPLING STATION (4)
	EXTRACTION SUMP TO REMAIN (11)
	SEEP INTERCEPTOR TRENCH

