

WATER WELL PLUGGING RECORD Form WWC-5P

KSA 82a-1212 ID NO.

RW-15

1 LOCATION OF WATER WELL: County: Sedgwick	Fraction NW 1/4 NE 1/4 NW 1/4 NE 1/4	Section Number 9	Township Number T 27 S	Range Number 1 <input checked="" type="checkbox"/> E <input type="checkbox"/> W
--	---	---------------------	---------------------------	--

Street/Rural Address of Well Location; if unknown, distance & direction from nearest town or intersection: If at owner's address, check here Former Coastal Refinery, 2461 N. New York Street, Wichita, Ks.

Global Positioning Systems (GPS) information:
 Latitude: 37.72168023 (in decimal degrees)
 Longitude: -97.32321095 (in decimal degrees)
 Elevation: 1309.54
 Horizontal Datum: WGS84, NAD83, NAD27
 Collection Method:

2 WATER WELL OWNER: El Paso, LLC
 RR#, St. Address, Box #: 1515 Des Peres Road, Suite 300
 City, State ZIP Code: St. Louis, MO. 63131

GPS unit (Make/Model: _____)
 Digital Map/Photo, Topographic Map, Land Survey
 Est. Accuracy: < 3 m, 3-5 m, 5-15 m, > 15 m

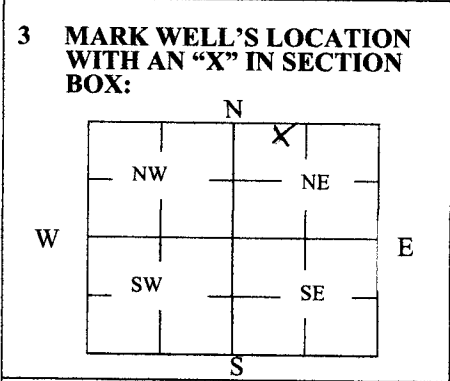

4 DEPTH OF WELL 31.0 ft.
 WELL'S STATIC WATER LEVEL 12.95 ft
 WELL WAS USED AS:

<input type="checkbox"/> Domestic	<input type="checkbox"/> Public Water Supply	<input type="checkbox"/> Dewatering
<input type="checkbox"/> Irrigation	<input type="checkbox"/> Oil Field Water Supply	<input checked="" type="checkbox"/> Monitoring
<input type="checkbox"/> Feedlot	<input type="checkbox"/> Domestic (Lawn & Garden)	<input type="checkbox"/> Injection Well
<input type="checkbox"/> Industrial	<input type="checkbox"/> Air Conditioning	<input checked="" type="checkbox"/> Other <u>recovery</u>

Was a chemical/bacteriological sample submitted to Department? Yes No

5 TYPE OF BLANK CASING USED:

Steel RMP (SR) Wrought Fiberglass Other (Specify below) _____
 PVC ABS Asbestos-Cement Concrete Tile

Blank casing diameter 24 in. Was casing pulled? Yes No If yes, how much 5 ft.
 Casing height above or below land surface 30 in.

6 GROUT PLUG MATERIAL: Neat cement Cement grout Bentonite Other _____

Grout Plug Intervals: From 0 ft. to 31.0 ft., From _____ ft. to _____ ft., From _____ ft. to _____ ft.

What is the nearest source of possible contamination:

<input type="checkbox"/> Septic tank	<input type="checkbox"/> Seepage pit	<input checked="" type="checkbox"/> Fuel storage	<input checked="" type="checkbox"/> Other (specify below) <u>contaminated site</u>
<input type="checkbox"/> Sewer lines	<input type="checkbox"/> Pit privy	<input type="checkbox"/> Fertilizer storage	
<input type="checkbox"/> Watertight sewer lines	<input type="checkbox"/> Sewage lagoon	<input type="checkbox"/> Insecticide storage	
<input type="checkbox"/> Lateral lines	<input type="checkbox"/> Feedyard	<input type="checkbox"/> Abandoned water well	Direction from well? <u>NA</u>
<input type="checkbox"/> Cess pool	<input type="checkbox"/> Livestock pens	<input type="checkbox"/> Oil well/Gas well	How many feet? <u>0</u>

FROM	TO	PLUGGING MATERIALS	FROM	TO	PLUGGING MATERIALS
0	31.0	Bentonite			

7 CONTRACTOR'S OR LANDOWNER'S CERTIFICATION: This water well was plugged under my jurisdiction and was completed on (mo/day/year) 10-28-2020 and this record is true to the best of my knowledge and belief. Kansas Water Well Contractor's License No. 604. This Water Well Record was completed on (mo/day/year) 12/7/2020 under the business name of Environmental Priority Service, Inc. by (signature) [Signature]

Send one white copy to Kansas Department of Health & Environment, Geology Section, 1000 SW Jackson Street, Ste. 420, Topeka, KS 66612-1367. Send one copy to WATER WELL OWNER and retain one for your records.
 Visit us at <http://www.kdheks.gov/waterwell/index.html> Telephone 785-296-5524.

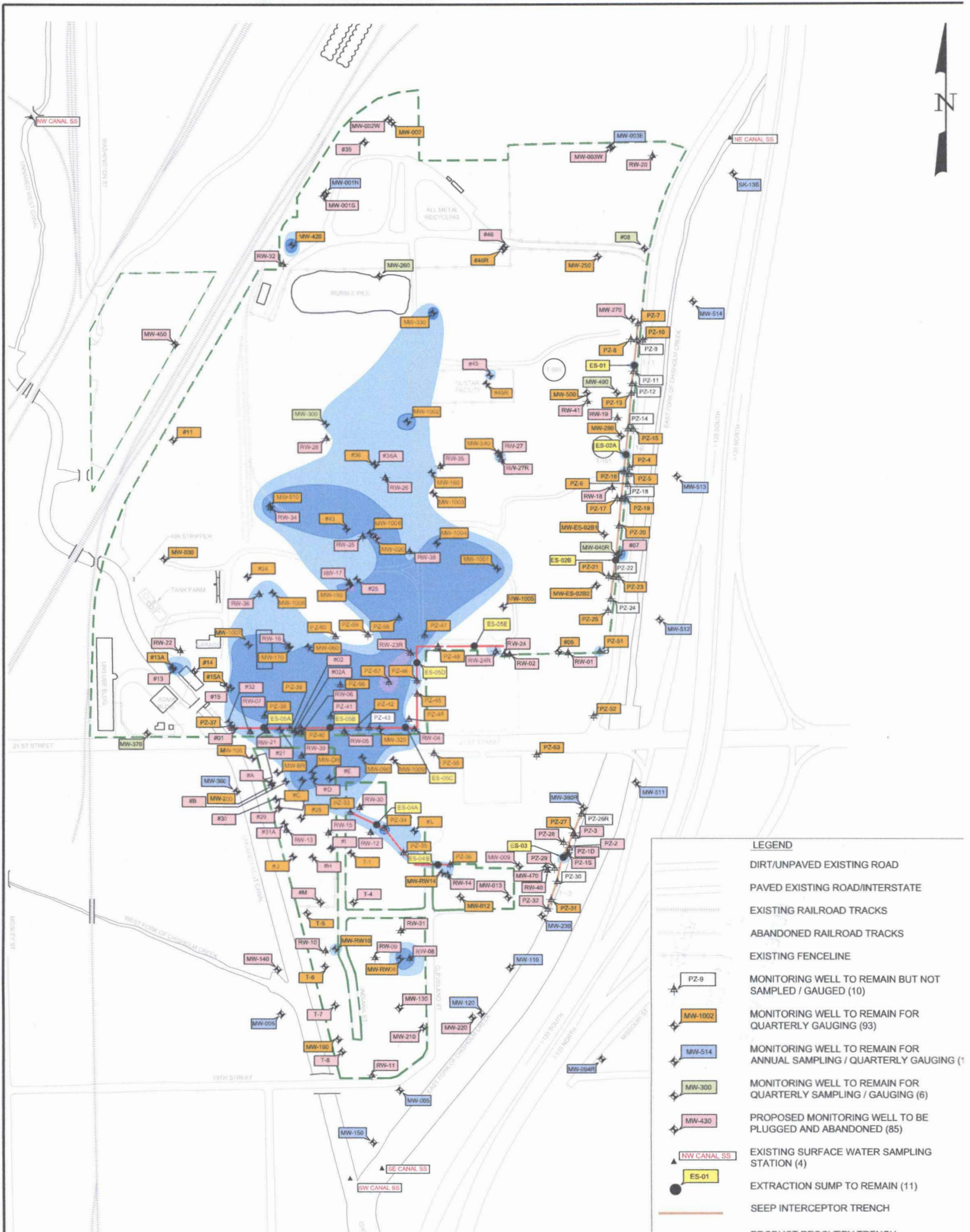

LEGEND	
	DIRT/UNPAVED EXISTING ROAD
	PAVED EXISTING ROAD/INTERSTATE
	EXISTING RAILROAD TRACKS
	ABANDONED RAILROAD TRACKS
	EXISTING FENCELINE
	MONITORING WELL TO REMAIN BUT NOT SAMPLED / GAUGED (10)
	MONITORING WELL TO REMAIN FOR QUARTERLY GAUGING (93)
	MONITORING WELL TO REMAIN FOR ANNUAL SAMPLING / QUARTERLY GAUGING (1)
	MONITORING WELL TO REMAIN FOR QUARTERLY SAMPLING / GAUGING (6)
	PROPOSED MONITORING WELL TO BE PLUGGED AND ABANDONED (85)
	EXISTING SURFACE WATER SAMPLING STATION (4)
	EXTRACTION SUMP TO REMAIN (11)
	SEEP INTERCEPTOR TRENCH

