

WATER WELL PLUGGING RECORD Form WWC-5P

KSA 82a-1212 ID NO.

RW-13

1 LOCATION OF WATER WELL: County: <u>Sedgwick</u>	Fraction <u>NE 1/4 NE 1/4 NW 1/4 NE 1/4</u>	Section Number <u>9</u>	Township Number <u>T 27 S</u>	Range Number <u>1</u> <input checked="" type="checkbox"/> E <input type="checkbox"/> W
-------------------------------------------------------------	------------------------------------------------	----------------------------	----------------------------------	-------------------------------------------------------------------------------------------

Street/Rural Address of Well Location; if unknown, distance & direction from nearest town or intersection: If at owner's address, check here Former Coastal Refinery, 2461 N. New York Street, Wichita, Ks.

Global Positioning Systems (GPS) information:
 Latitude: 37.72171269 (in decimal degrees)
 Longitude: -97.32377582 (in decimal degrees)
 Elevation: 1308.72
 Horizontal Datum: WGS84, NAD83, NAD27
 Collection Method:

2 WATER WELL OWNER: El Paso, LLC
 RR#, St. Address, Box #: 1515 Des Peres Road, Suite 300
 City, State ZIP Code: St. Louis, MO. 63131

GPS unit (Make/Model: _____)
 Digital Map/Photo, Topographic Map, Land Survey
 Est. Accuracy: < 3 m, 3-5 m, 5-15 m, > 15 m

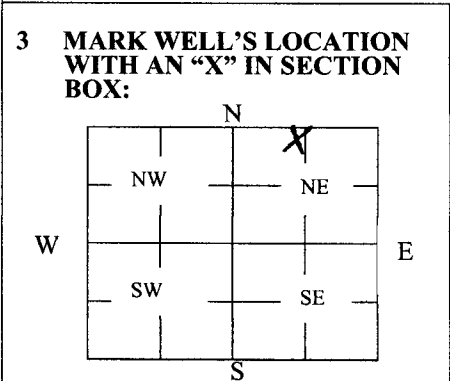

4 DEPTH OF WELL 29.0 ft.
 WELL'S STATIC WATER LEVEL 12.37 ft
 WELL WAS USED AS:

<input type="checkbox"/> Domestic	<input type="checkbox"/> Public Water Supply	<input type="checkbox"/> Dewatering
<input type="checkbox"/> Irrigation	<input type="checkbox"/> Oil Field Water Supply	<input checked="" type="checkbox"/> Monitoring
<input type="checkbox"/> Feedlot	<input type="checkbox"/> Domestic (Lawn & Garden)	<input type="checkbox"/> Injection Well
<input type="checkbox"/> Industrial	<input type="checkbox"/> Air Conditioning	<input checked="" type="checkbox"/> Other <u>recovery</u>

Was a chemical/bacteriological sample submitted to Department? Yes No

5 TYPE OF BLANK CASING USED:

<input checked="" type="checkbox"/> Steel	<input type="checkbox"/> RMP (SR)	<input type="checkbox"/> Wrought	<input type="checkbox"/> Fiberglass	<input type="checkbox"/> Other (Specify below)
<input checked="" type="checkbox"/> PVC	<input type="checkbox"/> ABS	<input type="checkbox"/> Asbestos-Cement	<input type="checkbox"/> Concrete Tile	

Blank casing diameter 24 in. Was casing pulled? Yes No If yes, how much 5 ft.
 Casing height above or below land surface 30 in.

6 GROUT PLUG MATERIAL: Neat cement Cement grout Bentonite Other _____

Grout Plug Intervals: From 0 ft. to 29.0 ft., From _____ ft. to _____ ft., From _____ ft. to _____ ft.

What is the nearest source of possible contamination:

<input type="checkbox"/> Septic tank	<input type="checkbox"/> Seepage pit	<input checked="" type="checkbox"/> Fuel storage	<input checked="" type="checkbox"/> Other (specify below)
<input type="checkbox"/> Sewer lines	<input type="checkbox"/> Pit privy	<input type="checkbox"/> Fertilizer storage	<u>contaminated site</u>
<input type="checkbox"/> Watertight sewer lines	<input type="checkbox"/> Sewage lagoon	<input type="checkbox"/> Insecticide storage	
<input type="checkbox"/> Lateral lines	<input type="checkbox"/> Feedyard	<input type="checkbox"/> Abandoned water well	Direction from well? <u>NA</u>
<input type="checkbox"/> Cess pool	<input type="checkbox"/> Livestock pens	<input type="checkbox"/> Oil well/Gas well	How many feet? <u>0</u>

FROM	TO	PLUGGING MATERIALS	FROM	TO	PLUGGING MATERIALS
0	29.0	Bentonite			

7 CONTRACTOR'S OR LANDOWNER'S CERTIFICATION: This water well was plugged under my jurisdiction and was completed on (mo/day/year) 10-28-2020 and this record is true to the best of my knowledge and belief. Kansas Water Well Contractor's License No. 604. This Water Well Record was completed on (mo/day/year) 12/7/2020 under the business name of Environmental Priority Service, Inc. by (signature) [Signature]

Send one white copy to Kansas Department of Health & Environment, Geology Section, 1000 SW Jackson Street, Ste. 420, Topeka, KS 66612-1367. Send one copy to WATER WELL OWNER and retain one for your records.
 Visit us at <http://www.kdheks.gov/waterwell/index.html> Telephone 785-296-5524.

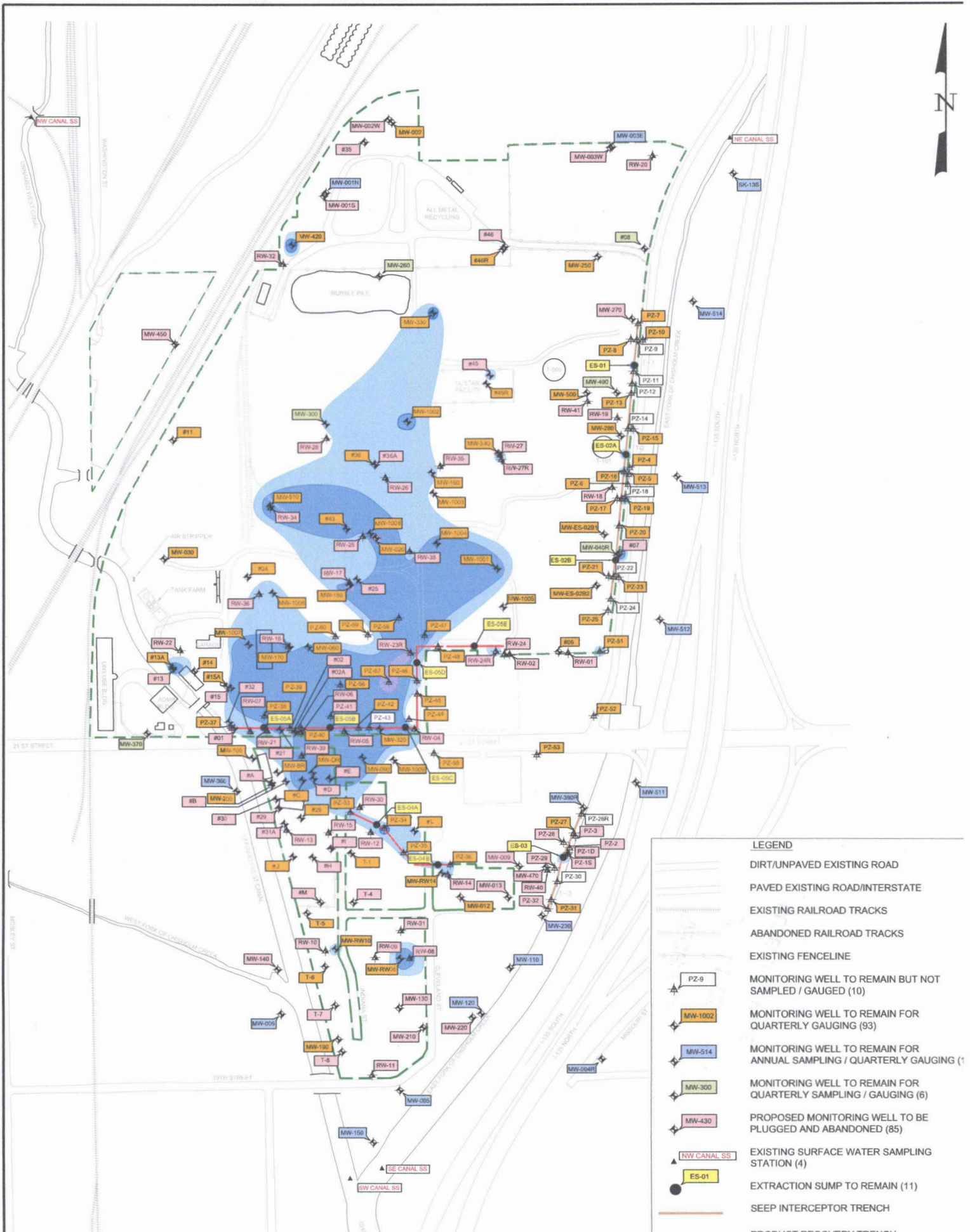

- LEGEND**
- DIRT/UNPAVED EXISTING ROAD
 - PAVED EXISTING ROAD/INTERSTATE
 - EXISTING RAILROAD TRACKS
 - ABANDONED RAILROAD TRACKS
 - EXISTING FENCELINE
 - ▲ PZ-9 MONITORING WELL TO REMAIN BUT NOT SAMPLED / GAUGED (10)
 - ◆ MW-1002 MONITORING WELL TO REMAIN FOR QUARTERLY GAUGING (93)
 - ◆ MW-514 MONITORING WELL TO REMAIN FOR ANNUAL SAMPLING / QUARTERLY GAUGING (1)
 - ◆ MW-300 MONITORING WELL TO REMAIN FOR QUARTERLY SAMPLING / GAUGING (6)
 - ◆ MW-430 PROPOSED MONITORING WELL TO BE PLUGGED AND ABANDONED (85)
 - ▲ NW CANAL SS EXISTING SURFACE WATER SAMPLING STATION (4)
 - ES-01 EXTRACTION SUMP TO REMAIN (11)
 - SEEP INTERCEPTOR TRENCH

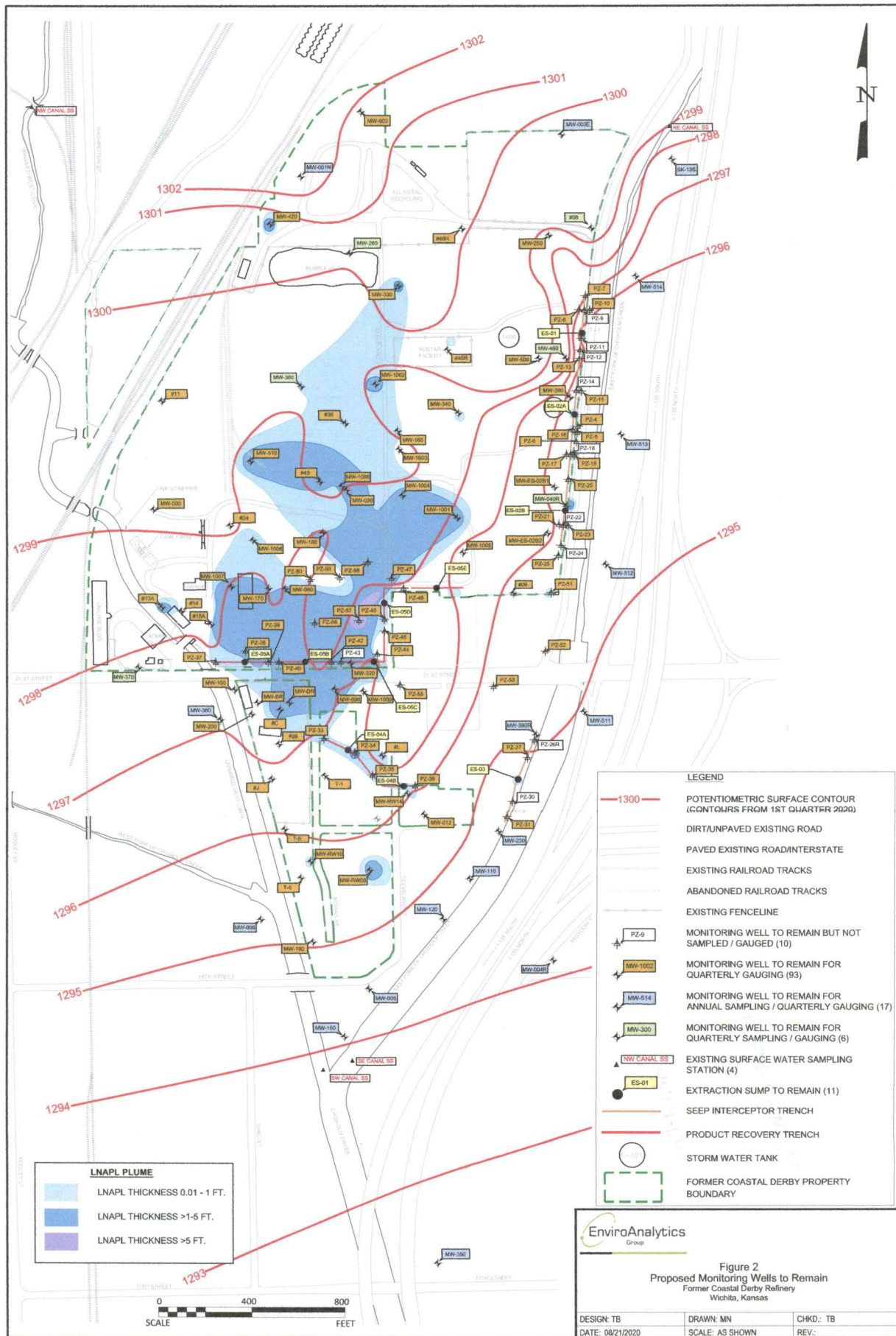

LNAPL PLUME

- LNAPL THICKNESS 0.01 - 1 FT.
- LNAPL THICKNESS >1-5 FT.
- LNAPL THICKNESS >5 FT.

- LEGEND**
- 1300 — POTENTIOMETRIC SURFACE CONTOUR (CONTOURS FROM 1ST QUARTER 2020)
 - DIRT/UNPAVED EXISTING ROAD
 - PAVED EXISTING ROAD/INTERSTATE
 - EXISTING RAILROAD TRACKS
 - ABANDONED RAILROAD TRACKS
 - EXISTING FENCELINE
 - ▲ PZ-9 MONITORING WELL TO REMAIN BUT NOT SAMPLED / GAUGED (10)
 - ▲ MW-1002 MONITORING WELL TO REMAIN FOR QUARTERLY GAUGING (93)
 - ▲ MW-514 MONITORING WELL TO REMAIN FOR ANNUAL SAMPLING / QUARTERLY GAUGING (17)
 - ▲ MW-300 MONITORING WELL TO REMAIN FOR QUARTERLY SAMPLING / GAUGING (6)
 - ▲ NW CANAL SS EXISTING SURFACE WATER SAMPLING STATION (4)
 - ES-01 EXTRACTION SUMP TO REMAIN (11)
 - SEEP INTERCEPTOR TRENCH
 - PRODUCT RECOVERY TRENCH
 - STORM WATER TANK
 - FORMER COASTAL DERBY PROPERTY BOUNDARY

EnviroAnalytics
Group

Figure 2
Proposed Monitoring Wells to Remain
Former Coastal Derby Refinery
Wichita, Kansas

DESIGN: TB	DRAWN: MN	CHKD: TB
DATE: 08/21/2020	SCALE: AS SHOWN	REV: