

**WATER WELL PLUGGING RECORD Form WWC-5P**

KSA 82a-1212 ID NO.

RW-14

**1 LOCATION OF WATER WELL:** Fraction SW 1/4 NW 1/4 NE 1/4 NE 1/4 Section Number 9 Township Number T 27 S Range Number 1  E  W  
 County: Sedgwick

Street/Rural Address of Well Location; if unknown, distance & direction from nearest town or intersection: If at owner's address, check here  Former Coastal Refinery, 2461 N. New York Street, Wichita, Ks.

**Global Positioning Systems (GPS) information:**  
 Latitude: 37.72121701 (in decimal degrees)  
 Longitude: -97.32160756 (in decimal degrees)  
 Elevation: 1310.31  
 Horizontal Datum:  WGS84,  NAD83,  NAD27  
 Collection Method:

**2 WATER WELL OWNER:** El Paso, LLC  
 RR#, St. Address, Box #: 1515 Des Peres Road, Suite 300  
 City, State ZIP Code: St. Louis, MO. 63131

GPS unit (Make/Model: \_\_\_\_\_)  
 Digital Map/Photo,  Topographic Map,  Land Survey  
 Est. Accuracy:  < 3 m,  3-5 m,  5-15 m,  > 15 m

**3 MARK WELL'S LOCATION WITH AN "X" IN SECTION BOX:**

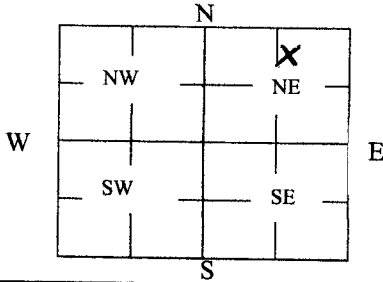

**4 DEPTH OF WELL** 31.5 ft.

WELL'S STATIC WATER LEVEL NA ft

WELL WAS USED AS:

- Domestic
- Public Water Supply
- Dewatering
- Irrigation
- Oil Field Water Supply
- Monitoring
- Feedlot
- Domestic (Lawn & Garden)
- Injection Well
- Industrial
- Air Conditioning
- Other recovery

Was a chemical/bacteriological sample submitted to Department? Yes  No

**5 TYPE OF BLANK CASING USED:**

- Steel
- RMP (SR)
- Wrought
- Fiberglass
- Other (Specify below) \_\_\_\_\_
- PVC
- ABS
- Asbestos-Cement
- Concrete Tile

Blank casing diameter 24 in. Was casing pulled? Yes  No  If yes, how much 5 ft.  
 Casing height above or below land surface 30 in.

**6 GROUT PLUG MATERIAL:**  Neat cement  Cement grout  Bentonite  Other \_\_\_\_\_

Grout Plug Intervals: From 0 ft. to 31.50 ft., From \_\_\_\_\_ ft. to \_\_\_\_\_ ft., From \_\_\_\_\_ ft. to \_\_\_\_\_ ft.

What is the nearest source of possible contamination:

- Septic tank
  - Seepage pit
  - Fuel storage
  - Sewer lines
  - Pit privy
  - Fertilizer storage
  - Watertight sewer lines
  - Sewage lagoon
  - Insecticide storage
  - Lateral lines
  - Feedyard
  - Abandoned water well
  - Cess pool
  - Livestock pens
  - Oil well/Gas well
  - Other (specify below) contaminated site
- Direction from well? NA  
 How many feet? 0

FROM	TO	PLUGGING MATERIALS	FROM	TO	PLUGGING MATERIALS
0	31.5	Bentonite			

**7 CONTRACTOR'S OR LANDOWNER'S CERTIFICATION:** This water well was plugged under my jurisdiction and was completed on (mo/day/year) 10-28-2020 and this record is true to the best of my knowledge and belief. Kansas Water Well Contractor's License No. 604. This Water Well Record was completed on (mo/day/year) 12/7/2020 under the business name of Environmental Priority Service, Inc. by (signature) PJA mt

Send one white copy to Kansas Department of Health & Environment, Geology Section, 1000 SW Jackson Street, Ste. 420, Topeka, KS 66612-1367. Send one copy to WATER WELL OWNER and retain one for your records.  
 Visit us at <http://www.kdheks.gov/waterwell/index.html> Telephone 785-296-5524.

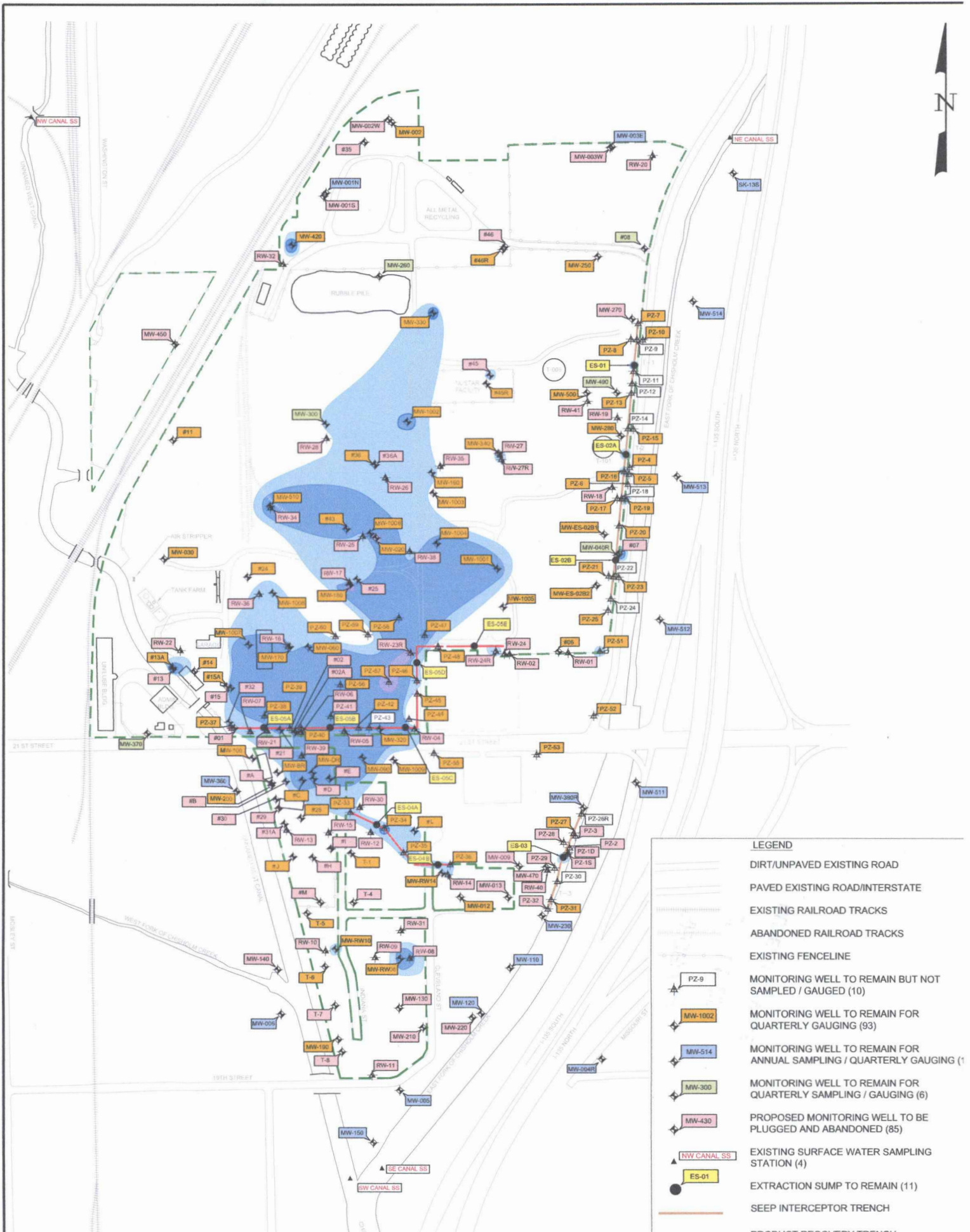

LEGEND	
	DIRT/UNPAVED EXISTING ROAD
	PAVED EXISTING ROAD/INTERSTATE
	EXISTING RAILROAD TRACKS
	ABANDONED RAILROAD TRACKS
	EXISTING FENCELINE
	MONITORING WELL TO REMAIN BUT NOT SAMPLED / GAUGED (10)
	MONITORING WELL TO REMAIN FOR QUARTERLY GAUGING (93)
	MONITORING WELL TO REMAIN FOR ANNUAL SAMPLING / QUARTERLY GAUGING (1)
	MONITORING WELL TO REMAIN FOR QUARTERLY SAMPLING / GAUGING (6)
	PROPOSED MONITORING WELL TO BE PLUGGED AND ABANDONED (85)
	EXISTING SURFACE WATER SAMPLING STATION (4)
	EXTRACTION SUMP TO REMAIN (11)
	SEEP INTERCEPTOR TRENCH

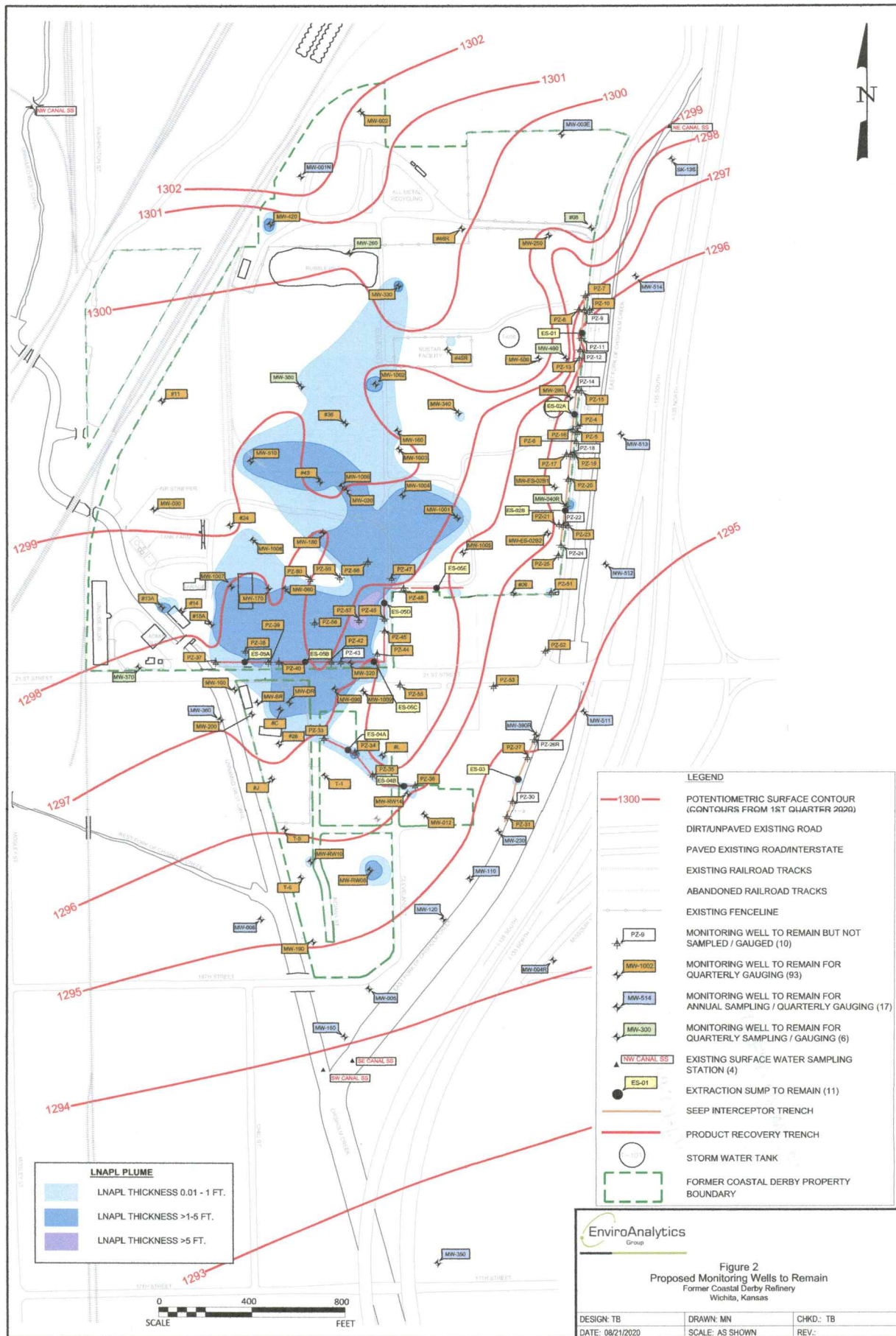

EnviroAnalytics Group

Figure 2  
Proposed Monitoring Wells to Remain  
Former Coastal Derby Refinery  
Wichita, Kansas

DESIGN: TB	DRAWN: MN	CHKD: TB
DATE: 08/21/2020	SCALE: AS SHOWN	REV: