

WATER WELL RECORD Form WWC-5

Original Record Correction Change in Well Use

Division of Water Resources App. No.

Well ID

Well ID

1 LOCATION OF WATER WELL: County: Fraction Section Number Township Number Range Number

2 WELL OWNER: Last Name: Business: Address: City: State: ZIP: Street or Rural Address where well is located

3 LOCATE WELL WITH "X" IN SECTION BOX: NW NE SW SE S

4 DEPTH OF COMPLETED WELL: Depth(s) Groundwater Encountered: WELL'S STATIC WATER LEVEL: Pump test data: Estimated Yield: Bore Hole Diameter:

5 Latitude: Longitude: Datum: Source for Latitude/Longitude: 6 Elevation: Source:

7 WELL WATER TO BE USED AS: 1. Domestic: 2. Irrigation: 3. Feedlot: 4. Industrial: 5. Public Water Supply: 6. Dewatering: 7. Aquifer Recharge: 8. Monitoring: 9. Environmental Remediation: 10. Oil Field Water Supply: 11. Test Hole: 12. Geothermal: 13. Other

Was a chemical/bacteriological sample submitted to KDHE? Water well disinfected?

8 TYPE OF CASING USED: CASING JOINTS: TYPE OF SCREEN OR PERFORATION MATERIAL: SCREEN OR PERFORATION OPENINGS ARE: SCREEN-PERFORATED INTERVALS: GRAVEL PACK INTERVALS:

9 GROUT MATERIAL: Grout Intervals: Nearest source of possible contamination: Direction from well? Distance from well?

Table with 6 columns: FROM, TO, LITHOLOGIC LOG, FROM, TO, LITHO. LOG (cont.) or PLUGGING INTERVALS. Includes a Notes section.

11 CONTRACTOR'S OR LANDOWNER'S CERTIFICATION: This water well was constructed, reconstructed, or plugged under my jurisdiction and was completed on (mo-day-year) and this record is true to the best of my knowledge and belief.

Save: 6-20-2019 3:33:05 PM by CSJ
U:\Wichita_Feb2019\18177\200PECD\DWG\18177-000-CU101

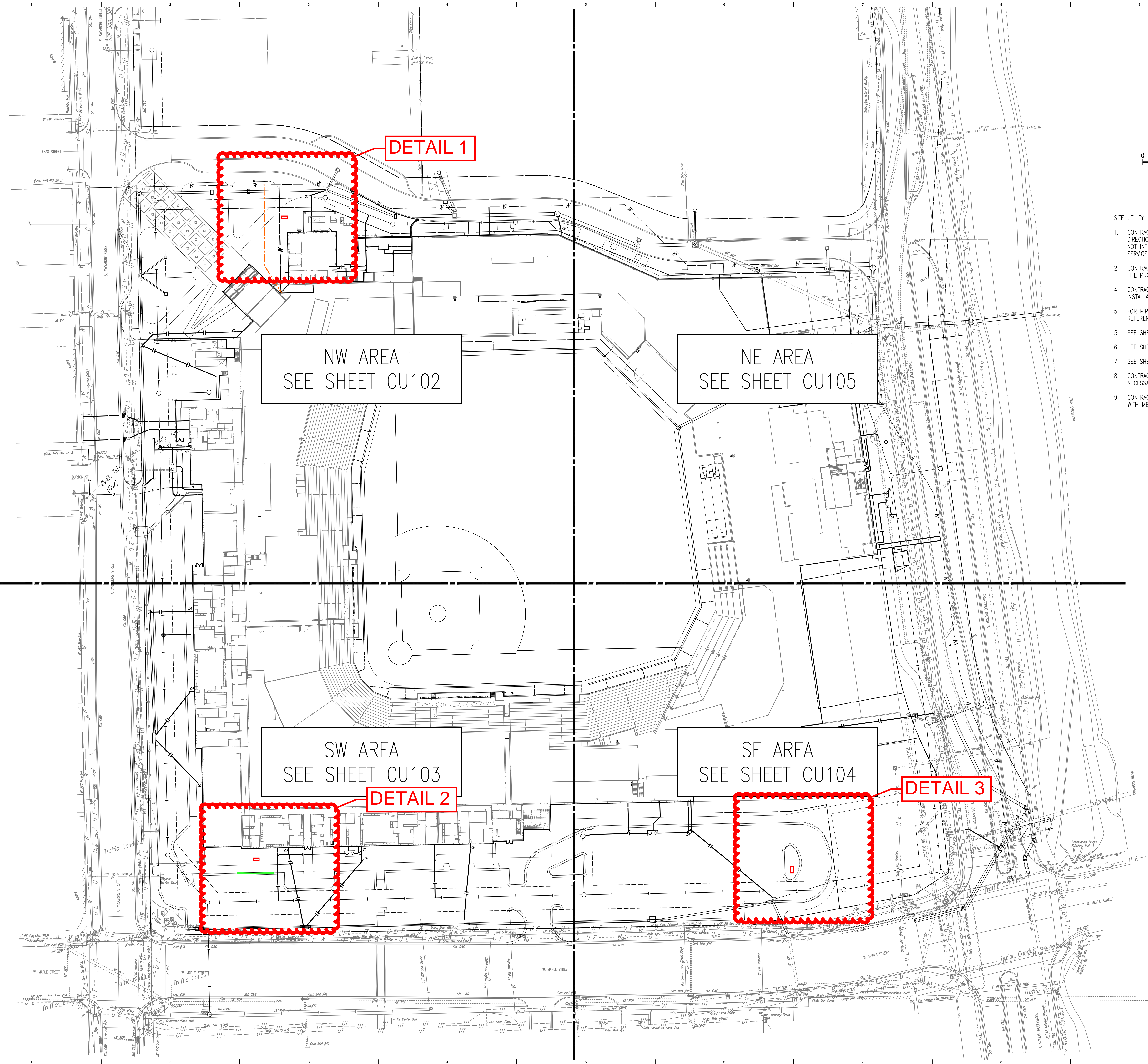

MABCD REVIEW
STAMP LOCATION

SCALE: 1" = 40'
0 40 80

SITE UTILITY NOTES

1. CONTRACTOR SHALL BE RESPONSIBLE FOR OPEN CUTTING, BORING, OR DIRECTIONAL DRILLING ALL PROPOSED UTILITY CROSSINGS. CONTRACTOR SHALL NOT INTERRUPT OR DISCONNECT ANY PERMANENT OR TEMPORARY EXISTING SERVICE WITHOUT PRIOR APPROVAL FROM OWNER.
2. CONTRACTOR SHALL BE RESPONSIBLE FOR COORDINATING THE CONSTRUCTION OF THE PROPOSED GAS LINES WITH KANSAS GAS SERVICES.
4. CONTRACTOR SHALL VERIFY METER LOCATIONS WITH THE CITY PRIOR TO INSTALLATION.
5. FOR PIPE CONNECTIONS TO BUILDING AND GREASE INTERCEPTOR DETAILS, REFERENCE MECHANICAL PLANS.
5. SEE SHEETS CU237-CU239 FOR WATERLINE DETAILS
6. SEE SHEETS CU209-CU210 FOR SANITARY SEWER DETAILS
7. SEE SHEETS CU258-CU266 FOR STORM SEWER DETAILS
8. CONTRACTOR SHALL BE RESPONSIBLE FOR ALL PIPE, FITTINGS, ADAPTORS, ETC. NECESSARY TO COMPLETE SITE UTILITY CONNECTIONS.
9. CONTRACTOR SHALL BE RESPONSIBLE FOR COORDINATING BUILDING CONNECTIONS WITH MECHANICAL PLANS.

NW AREA
SEE SHEET CU102

NE AREA
SEE SHEET CU105

SW AREA
SEE SHEET CU103

SE AREA
SEE SHEET CU104

SJCF ARCHITECTURE | DLR GROUP | PEC, P.A.
JE DUNN CONSTRUCTION | EBY CONSTRUCTION
A DESIGN BUILD TEAM

PEC
PROFESSIONAL ENGINEERING CONSULTANTS, P.A.
303 SOUTH TOPEKA WICHITA,
KS 67202 316-262-2891 www.pec1.com

CITY OF WICHITA
Entertainment Venue and
Multi - Sport Stadium
300 Sycamore St.
Wichita, KS 67213

©2019
Schaefer Johnson Cox Frey Architecture, Inc.
All Rights Reserved.
These drawings and their contents, including, but not limited to, all concepts, designs, & ideas are the exclusive property of Schaefer Johnson Cox Frey (SJCFF), and may not be used or reproduced in any way without the express consent of SJCFF.

REVISIONS
19 CPR20 06/21/19

PROJECT NUMBER
XXXX.XX
INITIAL RELEASE DATE
05/07/19
SITE UTILITY PLAN

CU101

ENTIRE SHEET

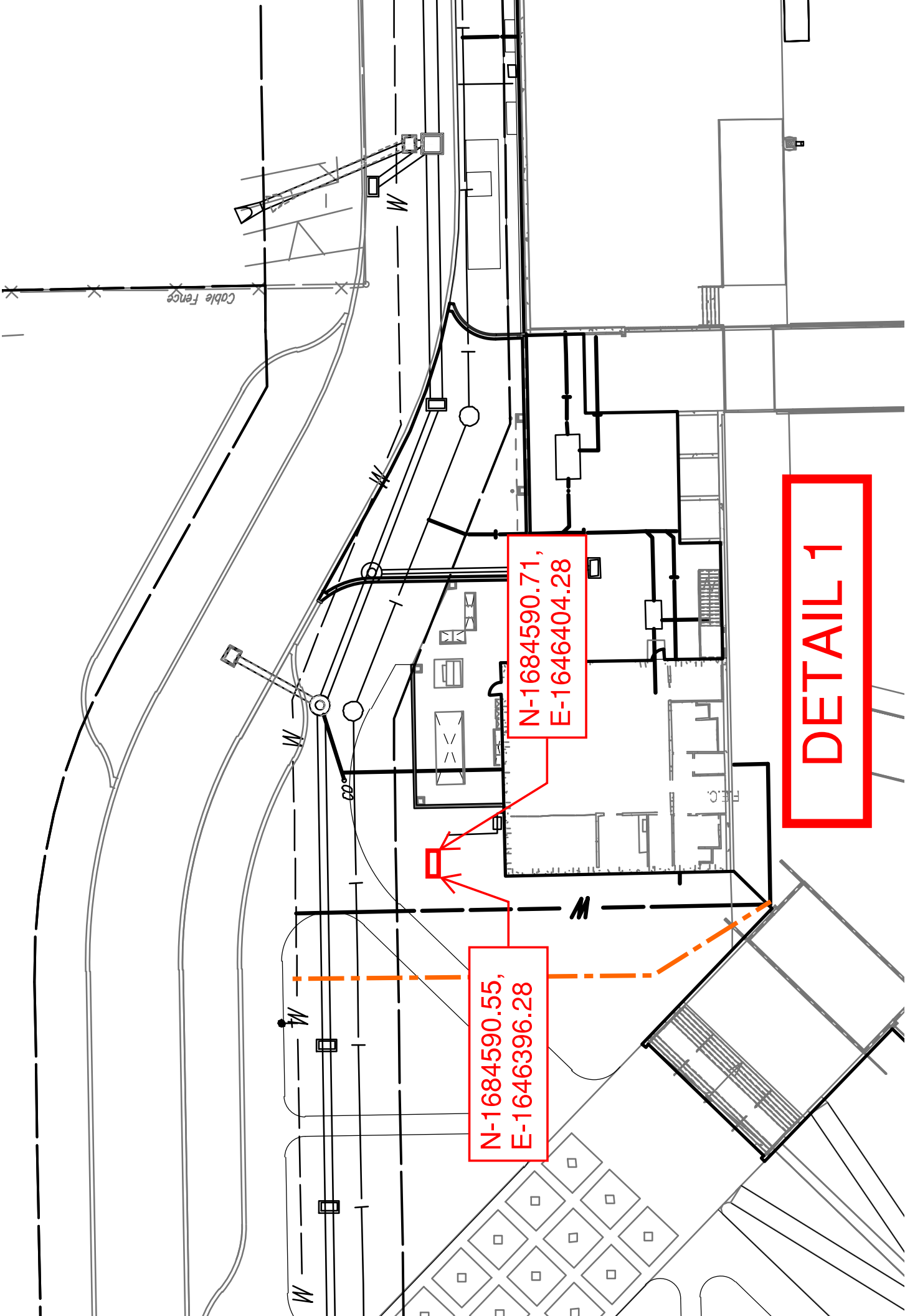

Cable Fence

N-1684590.71,
E-1646404.28

N-1684590.55,
E-1646396.28

DETAIL 1

N-1683878.49,
E-1646935.27

N-1683870.49,
E-1646935.42

DETAIL 3

