

County: Sedgwick Fraction: SW, NW, SE, SE Sec. 4 T. 27 S R. 1 E

**CORRECTION(S) to WATER WELL COMPLETION RECORD Form WWC-5 (to rectify lacking or incorrect information)**

Owner: RRM Properties, L.L.C. Field MW-1004

If location corrected, was listed as:

Location changed to:

Section-Township-Range: \_\_\_\_\_

\_\_\_\_\_

Fraction (1/4 calls): none given

SW, NW, SE, SE

Other changes: Initial statements: \_\_\_\_\_

Changed to: \_\_\_\_\_

Comments: Multiple 1-in multi-phase extraction wells in a SW-NE trench referred to as Field MW-1004 in the central portion of the Former Coastal Derby Refinery.

Verification method: Maps & info provided by environmental consultant in variance request - June 2021.

Also used Google Earth & KDHE STR Finder.

Initials: PKC Date: 11/15/21

Submitted by:  Kansas Geological Survey, Data Resources Library, 1930 Constant Ave., Lawrence, KS 66047-3724  
 Kansas Dept. of Health & Environment, Bureau of Water, 1000 SW Jackson, Suite 420, Topeka, KS 66612-1367

**WATER WELL PLUGGING RECORD Form WWC-5P**

KSA 82a-1212

ID NO.

Field MW-1004

<b>1 LOCATION OF WATER WELL:</b> County: Sedgwick	Fraction 1/4 1/4 1/4 1/4	Section Number 9	Township Number 27 T S	Range Number 1 <input checked="" type="checkbox"/> E <input type="checkbox"/> W
--	-----------------------------	---------------------	---------------------------	--

Street/Rural Address of Well Location; if unknown, distance & direction from nearest town or intersection: If at owner's address, check here  2561 N. New York St. Wichita, KS 67214

**Global Positioning Systems (GPS) information:**  
 Latitude: 37.724412 (in decimal degrees)  
 Longitude: -97.320996 (in decimal degrees)  
 Elevation: \_\_\_\_\_  
 Horizontal Datum:  WGS84,  NAD83,  NAD27  
 Collection Method:  GPS unit (Make/Model: iPhone with GPS Tracks App.)  
 Digital Map/Photo,  Topographic Map,  Land Survey  
 Est. Accuracy:  < 3 m,  3-5 m,  5-15 m,  > 15 m

**2 WATER WELL OWNER:** R.R.M. Properties, L.L.C.  
 RR#, St. Address, Box #: 800 E 21st Street N  
 City, State ZIP Code: Wichita, KS 67214

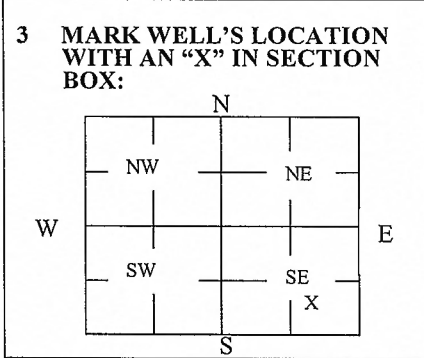

**4 DEPTH OF WELL** 17.78-16.16 ft.  
 WELL'S STATIC WATER LEVEL 15.96-12.58 ft.  
 WELL WAS USED AS:  
 Domestic  Public Water Supply  Dewatering  
 Irrigation  Oil Field Water Supply  Monitoring  
 Feedlot  Domestic (Lawn & Garden)  Injection Well  
 Industrial  Air Conditioning  Other Extrace; MPE  
 Was a chemical/bacteriological sample submitted to Department? Yes  No

**5 TYPE OF BLANK CASING USED:**

Steel  RMP (SR)  Wrought  Fiberglass  Other (Specify below)  
 PVC  ABS  Asbestos-Cement  Concrete Tile

Blank casing diameter 1 in. Was casing pulled? Yes  No  If yes, how much 5'  
 Casing height above or below land surface 36 in.

**6 GROUT PLUG MATERIAL:**  Neat cement  Cement grout  Bentonite  Other \_\_\_\_\_

Grout Plug Intervals: From 17.78 ft. to 3 ft., From \_\_\_\_\_ ft. to \_\_\_\_\_ ft., From \_\_\_\_\_ ft. to \_\_\_\_\_ ft.

What is the nearest source of possible contamination:  
 Septic tank  Seepage pit  Fuel storage  Other (specify below)  
 Sewer lines  Pit privy  Fertilizer storage Located at remediation site  
 Watertight sewer lines  Sewage lagoon  Insecticide storage  
 Lateral lines  Feedyard  Abandoned water well Direction from well? \_\_\_\_\_  
 Cess pool  Livestock pens  Oil well/Gas well How many feet? \_\_\_\_\_

FROM	TO	PLUGGING MATERIALS	FROM	TO	PLUGGING MATERIALS

**7 CONTRACTOR'S OR LANDOWNER'S CERTIFICATION:** This water well was plugged under my jurisdiction and was completed on (mo/day/year) 08/05/2021 and this record is true to the best of my knowledge and belief. Kansas Water Well Contractor's License No. PG #555. This Water Well Record was completed on (mo/day/year) 08/05/2021 under the business name of R.R.M. Properties, L.L.C. by (signature) \_\_\_\_\_

Send one white copy to Kansas Department of Health & Environment, Geology Section, 1000 SW Jackson Street, Ste. 420, Topeka, KS 66612-1367. Send one copy to WATER WELL OWNER and retain one for your records.  
 Visit us at <http://www.kdheks.gov/waterwell/index.html> Telephone 785-296-5524.

KSA82a-1212 Revised 1/20/2015