

County: Sedgwick Fraction: E2, SE, SW, SE Sec. 4 T. 27 S R. 1 E

CORRECTION(S) to WATER WELL COMPLETION RECORD Form WWC-5 (to rectify lacking or incorrect information)

Owner: RRM Properties, L.L.C. Area 4

If location corrected, was listed as:

Location changed to:

Section-Township-Range: _____

Fraction (1/4 calls): none given

E2, SE, SW, SE

Other changes: Initial statements: _____

Changed to: _____

Comments: Multiple 1-in multi-phase extraction wells in a large area referred to as Area 4 in the central portion of the Former Coastal Derby Refinery.

Verification method: Maps & info provided by environmental consultant in variance request - June 2021.

Also used Google Earth & KDHE STR Finder.

Initials: PKC Date: 11/15/21

Submitted by: Kansas Geological Survey, Data Resources Library, 1930 Constant Ave., Lawrence, KS 66047-3724

Kansas Dept. of Health & Environment, Bureau of Water, 1000 SW Jackson, Suite 420, Topeka, KS 66612-1367

WATER WELL PLUGGING RECORD Form WWC-5P

KSA 82a-1212

ID NO.

Area 4

1 LOCATION OF WATER WELL: County: <u>Sedgwick</u>	Fraction <u>1/4</u> <u>1/4</u> <u>1/4</u> <u>1/4</u>	Section Number <u>9</u>	Township Number <u>27 T</u> <u>S</u>	Range Number <u>1</u> <input checked="" type="checkbox"/> E <input type="checkbox"/> W
---	---	----------------------------	---	---

Street/Rural Address of Well Location; if unknown, distance & direction from nearest town or intersection: If at owner's address, check here 2561 N. New York St. Wichita, KS 67214

Global Positioning Systems (GPS) information:
 Latitude: 37.723956 (in decimal degrees)
 Longitude: -97.322202 (in decimal degrees)
 Elevation: _____
 Horizontal Datum: WGS84, NAD83, NAD27
 Collection Method: _____

2 WATER WELL OWNER: R.R.M. Properties, L.L.C.
 RR#, St. Address, Box #: 800 E 21st Street N
 City, State ZIP Code: Wichita, KS 67214

GPS unit (Make/Model: iPhone with GPS Tracks App.)
 Digital Map/Photo, Topographic Map, Land Survey
 Est. Accuracy: < 3 m, 3-5 m, 5-15 m, > 15 m

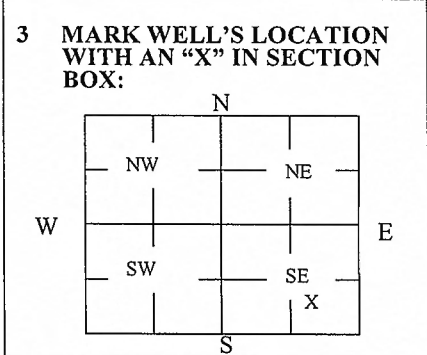

4 DEPTH OF WELL 16 ft.
 WELL'S STATIC WATER LEVEL 13 ft.

WELL WAS USED AS:

<input type="checkbox"/> Domestic	<input type="checkbox"/> Public Water Supply	<input type="checkbox"/> Dewatering
<input type="checkbox"/> Irrigation	<input type="checkbox"/> Oil Field Water Supply	<input type="checkbox"/> Monitoring
<input type="checkbox"/> Feedlot	<input type="checkbox"/> Domestic (Lawn & Garden)	<input type="checkbox"/> Injection Well
<input type="checkbox"/> Industrial	<input type="checkbox"/> Air Conditioning	<input checked="" type="checkbox"/> Other <u>Extrace; MPE</u>

Was a chemical/bacteriological sample submitted to Department? Yes No

5 TYPE OF BLANK CASING USED:

<input type="checkbox"/> Steel	<input type="checkbox"/> RMP (SR)	<input type="checkbox"/> Wrought	<input type="checkbox"/> Fiberglass	<input type="checkbox"/> Other (Specify below)
<input checked="" type="checkbox"/> PVC	<input type="checkbox"/> ABS	<input type="checkbox"/> Asbestos-Cement	<input type="checkbox"/> Concrete Tile	

Blank casing diameter 1 in. Was casing pulled? Yes No If yes, how much 5'
 Casing height above or below land surface 36 in.

6 GROUT PLUG MATERIAL: Neat cement Cement grout Bentonite Other _____

Grout Plug Intervals: From 16 ft. to 3 ft., From _____ ft. to _____ ft., From _____ ft. to _____ ft.

What is the nearest source of possible contamination:

<input type="checkbox"/> Septic tank	<input type="checkbox"/> Seepage pit	<input type="checkbox"/> Fuel storage	<input checked="" type="checkbox"/> Other (specify below)
<input type="checkbox"/> Sewer lines	<input type="checkbox"/> Pit privy	<input type="checkbox"/> Fertilizer storage	<u>Located at remediation site</u>
<input type="checkbox"/> Watertight sewer lines	<input type="checkbox"/> Sewage lagoon	<input type="checkbox"/> Insecticide storage	
<input type="checkbox"/> Lateral lines	<input type="checkbox"/> Feedyard	<input type="checkbox"/> Abandoned water well	Direction from well? _____
<input type="checkbox"/> Cess pool	<input type="checkbox"/> Livestock pens	<input type="checkbox"/> Oil well/Gas well	How many feet? _____

FROM	TO	PLUGGING MATERIALS	FROM	TO	PLUGGING MATERIALS

7 CONTRACTOR'S OR LANDOWNER'S CERTIFICATION: This water well was plugged under my jurisdiction and was completed on (mo/day/year) 08/06/2021 and this record is true to the best of my knowledge and belief. Kansas Water Well Contractor's License No. PG #555. This Water Well Record was completed on (mo/day/year) 08/06/2021 under the business name of R.R.M. Properties, L.L.C. by (signature) [Signature]

Send one white copy to Kansas Department of Health & Environment, Geology Section, 1000 SW Jackson Street, Ste. 420, Topeka, KS 66612-1367. Send one copy to WATER WELL OWNER and retain one for your records.
 Visit us at <http://www.kdheks.gov/waterwell/index.html> Telephone 785-296-5524.