

County: Sedgwick Fraction: SE, SE, SW, SE Sec. 4 T. 27 S R. 1 E

CORRECTION(S) to WATER WELL COMPLETION RECORD Form WWC-5 (to rectify lacking or incorrect information)

Owner: RRM Properties, L.L.C. Field PZ- 44

If location corrected, was listed as: _____ Location changed to: _____

Section-Township-Range: _____

Fraction (¼ calls): none given | SE, SE, SW, SE

Other changes: Initial statements: _____

Changed to: _____

Comments: Multiple 1-in multi-phase extraction wells in a rectangular area referred to as Field PZ-44 in the central portion of the Former Coastal Derby Refinery.

Verification method: Maps & info provided by environmental consultant in variance request - June 2021.

Also used Google Earth & KDHE STR Finder.

Submitted by: _____ Initials: PKC Date: 11/15/21

Submitted by: Kansas Geological Survey, Data Resources Library, 1930 Constant Ave., Lawrence, KS 66047-3724
 Kansas Dept. of Health & Environment, Bureau of Water, 1000 SW Jackson, Suite 420, Topeka, KS 66612-1367

WATER WELL PLUGGING RECORD Form WWC-5P

KSA 82a-1212

ID NO.

Field PZ-44

| | | | | |
|---|---|----------------------------|---|---|
| 1 LOCATION OF WATER WELL: County: <u>Sedgwick</u> | Fraction <u>1/4</u> <u>1/4</u> <u>1/4</u> <u>1/4</u> | Section Number <u>9</u> | Township Number <u>27 T</u> <u>S</u> | Range Number <u>1</u> <input checked="" type="checkbox"/> E <input type="checkbox"/> W |
|---|---|----------------------------|---|---|

Street/Rural Address of Well Location; if unknown, distance & direction from nearest town or intersection: If at owner's address, check here 2561 N. New York St. Wichita, KS 67214

Global Positioning Systems (GPS) information:
 Latitude: 37.723072 (in decimal degrees)
 Longitude: -97.322345 (in decimal degrees)
 Elevation: _____
 Horizontal Datum: WGS84, NAD83, NAD27
 Collection Method: _____

2 WATER WELL OWNER: R.R.M. Properties, L.L.C.
 RR#, St. Address, Box #: 800 E 21st Street N
 City, State ZIP Code: Wichita, KS 67214

GPS unit (Make/Model: iPhone with GPS Tracks App.)
 Digital Map/Photo, Topographic Map, Land Survey
 Est. Accuracy: < 3 m, 3-5 m, 5-15 m, > 15 m

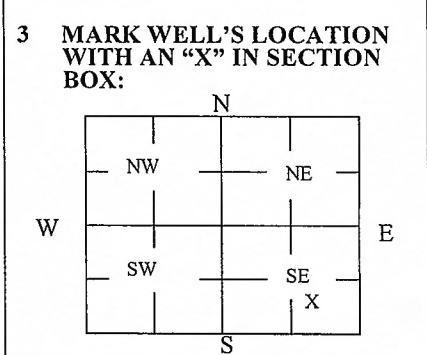

4 DEPTH OF WELL 17.29-15.09 ft.
 WELL'S STATIC WATER LEVEL 13.78-6.94 ft.
 WELL WAS USED AS:

| | | |
|-------------------------------------|---|---|
| <input type="checkbox"/> Domestic | <input type="checkbox"/> Public Water Supply | <input type="checkbox"/> Dewatering |
| <input type="checkbox"/> Irrigation | <input type="checkbox"/> Oil Field Water Supply | <input type="checkbox"/> Monitoring |
| <input type="checkbox"/> Feedlot | <input type="checkbox"/> Domestic (Lawn & Garden) | <input type="checkbox"/> Injection Well |
| <input type="checkbox"/> Industrial | <input type="checkbox"/> Air Conditioning | <input checked="" type="checkbox"/> Other <u>Extrace; MPE</u> |

Was a chemical/bacteriological sample submitted to Department? Yes No

5 TYPE OF BLANK CASING USED:

| | | | | |
|---|-----------------------------------|--|--|--|
| <input type="checkbox"/> Steel | <input type="checkbox"/> RMP (SR) | <input type="checkbox"/> Wrought | <input type="checkbox"/> Fiberglass | <input type="checkbox"/> Other (Specify below) |
| <input checked="" type="checkbox"/> PVC | <input type="checkbox"/> ABS | <input type="checkbox"/> Asbestos-Cement | <input type="checkbox"/> Concrete Tile | |

Blank casing diameter 1 in. Was casing pulled? Yes No If yes, how much 5'
 Casing height above or below land surface 36 in.

6 GROUT PLUG MATERIAL: Neat cement Cement grout Bentonite Other _____

Grout Plug Intervals: From 17.29 ft. to 3 ft., From _____ ft. to _____ ft., From _____ ft. to _____ ft.

What is the nearest source of possible contamination:

| | | | |
|---|---|---|---|
| <input type="checkbox"/> Septic tank | <input type="checkbox"/> Seepage pit | <input type="checkbox"/> Fuel storage | <input checked="" type="checkbox"/> Other (specify below) |
| <input type="checkbox"/> Sewer lines | <input type="checkbox"/> Pit privy | <input type="checkbox"/> Fertilizer storage | <u>Located at remediation site</u> |
| <input type="checkbox"/> Watertight sewer lines | <input type="checkbox"/> Sewage lagoon | <input type="checkbox"/> Insecticide storage | |
| <input type="checkbox"/> Lateral lines | <input type="checkbox"/> Feedyard | <input type="checkbox"/> Abandoned water well | Direction from well? _____ |
| <input type="checkbox"/> Cess pool | <input type="checkbox"/> Livestock pens | <input type="checkbox"/> Oil well/Gas well | How many feet? _____ |

| FROM | TO | PLUGGING MATERIALS | FROM | TO | PLUGGING MATERIALS |
|------|----|--------------------|------|----|--------------------|
| | | | | | |
| | | | | | |
| | | | | | |
| | | | | | |
| | | | | | |
| | | | | | |
| | | | | | |

7 CONTRACTOR'S OR LANDOWNER'S CERTIFICATION: This water well was plugged under my jurisdiction and was completed on (mo/day/year) 08/09/2021 and this record is true to the best of my knowledge and belief. Kansas Water Well Contractor's License No. PG #555. This Water Well Record was completed on (mo/day/year) 08/09/2021 under the business name of R.R.M. Properties, L.L.C. by (signature) [Signature]

Send one white copy to Kansas Department of Health & Environment, Geology Section, 1000 SW Jackson Street, Ste. 420, Topeka, KS 66612-1367. Send one copy to WATER WELL OWNER and retain one for your records.
 Visit us at <http://www.kdheks.gov/waterwell/index.html> Telephone 785-296-5524.