

WATER WELL RECORD Form WWC-5

Division of Water Resources App. No.

[]

Well ID TMW-06

Original Record Correction Change in Well Use

1 LOCATION OF WATER WELL: County: Sedwick Fraction NW 1/4 SE 1/4 NE 1/4 SE 1/4 Section Number 3 Township Number T 27 S Range Number R 1 E Q W

2 WELL OWNER: Last Name: KDHE Business: KDHE Address: 1000 SW Jackson St. City: Topeka State: Ks. ZIP: Street or Rural Address where well is located (if unknown, distance and direction from nearest town or intersection): Approx. 100 ft. east of intersection of N Lorraine & Arlene St., Wichita, Ks.

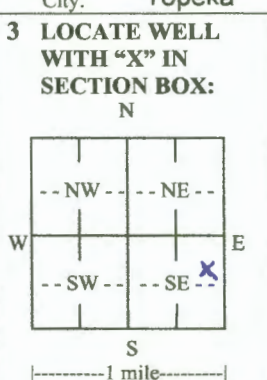

3 LOCATE WELL WITH 'X' IN SECTION BOX: N W E S 1 mile

4 DEPTH OF COMPLETED WELL: 16.5 ft. Depth(s) Groundwater Encountered: 1) ... ft. 2) ... ft. 3) ... ft. or 4) Dry Well WELL'S STATIC WATER LEVEL: 10.99 ft. below land surface, measured on (mo-day-yr) 4-7-2022 above land surface, measured on (mo-day-yr) Pump test data: Well water was ... ft. after ... hours pumping ... gpm Well water was ... ft. after ... hours pumping ... gpm Estimated Yield: ... gpm Bore Hole Diameter: 8.75 in. to 16.5 ft. and ... in. to ... ft.

5 Latitude: 37.727758 (decimal degrees) Longitude: 97.300345 (decimal degrees) Horizontal Datum: WGS 84 NAD 83 NAD 27 Source for Latitude/Longitude: GPS (unit make/model:) (WAAS enabled? Yes No) Land Survey Topographic Map Online Mapper

6 Elevation: NA ft. Ground Level TOC Source: Land Survey GPS Topographic Map Other

7 WELL WATER TO BE USED AS: 1. Domestic: Household Lawn & Garden Livestock Irrigation Feedlot Industrial 2. Public Water Supply: well ID 3. Dewatering: how many wells? 4. Aquifer Recharge: well ID TMW-06 5. Monitoring: well ID 6. Environmental Remediation: well ID Air Sparge Soil Vapor Extraction Recovery Injection 7. Oil Field Water Supply: lease 8. Test Hole: well ID Cased Uncased Geotechnical 9. Geothermal: how many bores? a) Closed Loop Horizontal Vertical b) Open Loop Surface Discharge Inj. of Water 10. Other (specify):

Was a chemical/bacteriological sample submitted to KDHE? Yes No If yes, date sample was submitted: Water well disinfected? Yes No

8 TYPE OF CASING USED: Steel PVC Other CASING JOINTS: Glued Clamped Welded Threaded Casing diameter 2 in. to 6.5 ft., Diameter 0 in. to ... ft., Diameter ... in. to ... ft. Casing height above land surface 0 in. Weight ... lbs./ft. Wall thickness or gauge No. sch 40

TYPE OF SCREEN OR PERFORATION MATERIAL: Steel Stainless Steel Fiberglass PVC Other (Specify) Brass Galvanized Steel Concrete tile None used (open hole)

SCREEN OR PERFORATION OPENINGS ARE: Continuous Slot Mill Slot Gauze Wrapped Torch Cut Drilled Holes Other (Specify) Louvered Shutter Key Punched Wire Wrapped Saw Cut None (Open Hole)

SCREEN-PERFORATED INTERVALS: From 6.5 ft. to 16.5 ft., From ... ft. to ... ft., From ... ft. to ... ft. GRAVEL PACK INTERVALS: From 3.5 ft. to 16.5 ft., From ... ft. to ... ft., From ... ft. to ... ft.

9 GROUT MATERIAL: Neat cement Cement grout Bentonite Other cement pad Grout Intervals: From 1 ft. to 3.5 ft., From 0 ft. to 1 ft., From ... ft. to ... ft.

Nearest source of possible contamination: Septic Tank Lateral Lines Pit Privy Livestock Pens Insecticide Storage Sewer Lines Cess Pool Sewage Lagoon Fuel Storage Abandoned Water Well Watertight Sewer Lines Seepage Pit Feedyard Fertilizer Storage Oil Well/Gas Well Other (Specify) PCE Plume Direction from well? NW Distance from well? NA ft.

10 FROM	TO	LITHOLOGIC LOG	FROM	TO	LITHO. LOG (cont.) or PLUGGING INTERVALS
0	5	Clay, dark brown, stiff, moist			
5	9	Clay, light brown, stiff, slightly moist			
9	14	Clay, tan/olive, stiff, moist, sandy			
14	16.5	Clay, olive, stiff, moist, trace shale			

Notes:

11 CONTRACTOR'S OR LANDOWNER'S CERTIFICATION: This water well was constructed, reconstructed, or plugged under my jurisdiction and was completed on (mo-day-year) 4-5-2022 and this record is true to the best of my knowledge and belief. Kansas Water Well Contractor's License No. 604 This Water Well Record was completed on (mo-day-year) 5/5/22 under the business name of Environmental Priority Service, Inc. Signature [Signature]



SCS ENGINEERS
ENVIRONMENTAL CONSULTANTS

8575 W 110TH STREET, SUITE 100
 OVERLAND PARK, KS 66210
 PH. (913) 681-0030 FAX. (913) 681-0012

PROJ. NO. 27221403.00	DRW. BY: JDJ	
CHK. BY: JDJ	APP. BY: SLM	

CLIENT:
 KANSAS DEPARTMENT OF HEALTH AND ENVIRONMENT
 BUREAU OF ENVIRONMENTAL REMEDIATION
 1000 SW JACKSON STREET, SUITE 410
 TOPEKA, KANSAS 66612

SHEET TITLE:
 Figure 2: SITE LAYOUT AND WELL LOCATIONS MAP

PROJECT TITLE:
 PCE -- EAST 21ST STREET UPGRADE
 2620 EAST 21ST STREET NORTH,
 WICHITA, KANSAS

DATE: 12/7/2021
SCALE: AS SHOWN
FIGURE NO. 2 of 2