

DENNIS L HANDKE

1820 NW 59th Terrace
TOPEKA, KANSAS 66618
785-286-4047 Home
785-286-1990 Fax

20-27-18E

Jess Chapman
Larson & Assoc.
1311 E. 25th St., Suite B
Lawrence, Kansas, 66046

March 6, 2022

RE: Monitor Well Elevation Survey
720 North Santa Fe, Chanute, Kansas

Proj. 22-00N
Amoco, Chandler
U3-067-00050 A&B

Bench Mark: Chisled Square on NW corner of concrete signal light base near the SE corner of property and or NW corner of Santa Fe Ave. and Cherry Street.

	Elev: 940.65	North 5009.19	West 45.63	(from SE Cor. Sec. 20-27-18E)
MW-13R rim	935.07	North	5247.39	NE1/4,NE1/4,NE1/NE1/4
top pipe	934.85	West	63.66	Lat= 37.68882 Long = 95.45286
MW-19 rim	940.59	North	5221.16	NE1/4,NE1/4,NE1/4,NE1/4
top pipe	940.26	West	195.59	Lat= 37.68875 Long = 95.45332
MW-20 rim	935.09	North	5217.04	NE1/4,NE1/4,NE1/4,NE1/4
top pipe	934.73	West	37.46	Lat= 37.68874 Long = 95.45277
MW-21 rim	932.39	North	5396.10	SE1/4,SE1/4,SE1/4,SE1/4 (Sec. 17-27-18E)
top pipe	931.89	West	164.25	Lat= 37.68923 Long = 95.45322
MW-22 rim	939.34	North	4891.46	SW1/4,NW1/4,NW1/4,NW1/4 (Sec. 21-27-18E)
top pipe	939.06	East	31.62	Lat= 37.68785 Long = 95.45252

Lat & Long derived from Chanute 7.5' quad map. WGS 84.

Elevation established from NMGS BM H 246, NAVD 88.

If you have any questions, please feel free to call me. Thank you for the opportunity to be of service to you.

Dennis L. Handke RLS

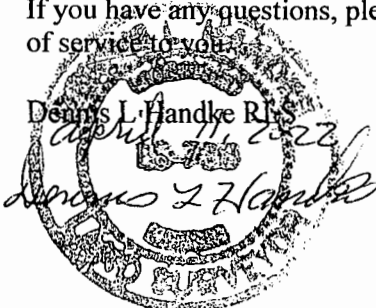

NOTE: Figures exhibited within this report are only to be used within the context of this report. Placement of property lines, wells, structures, and roads is based on the available information from county appraiser maps, surveys, site visits, and/or previous vendor reports and should be considered approximate.

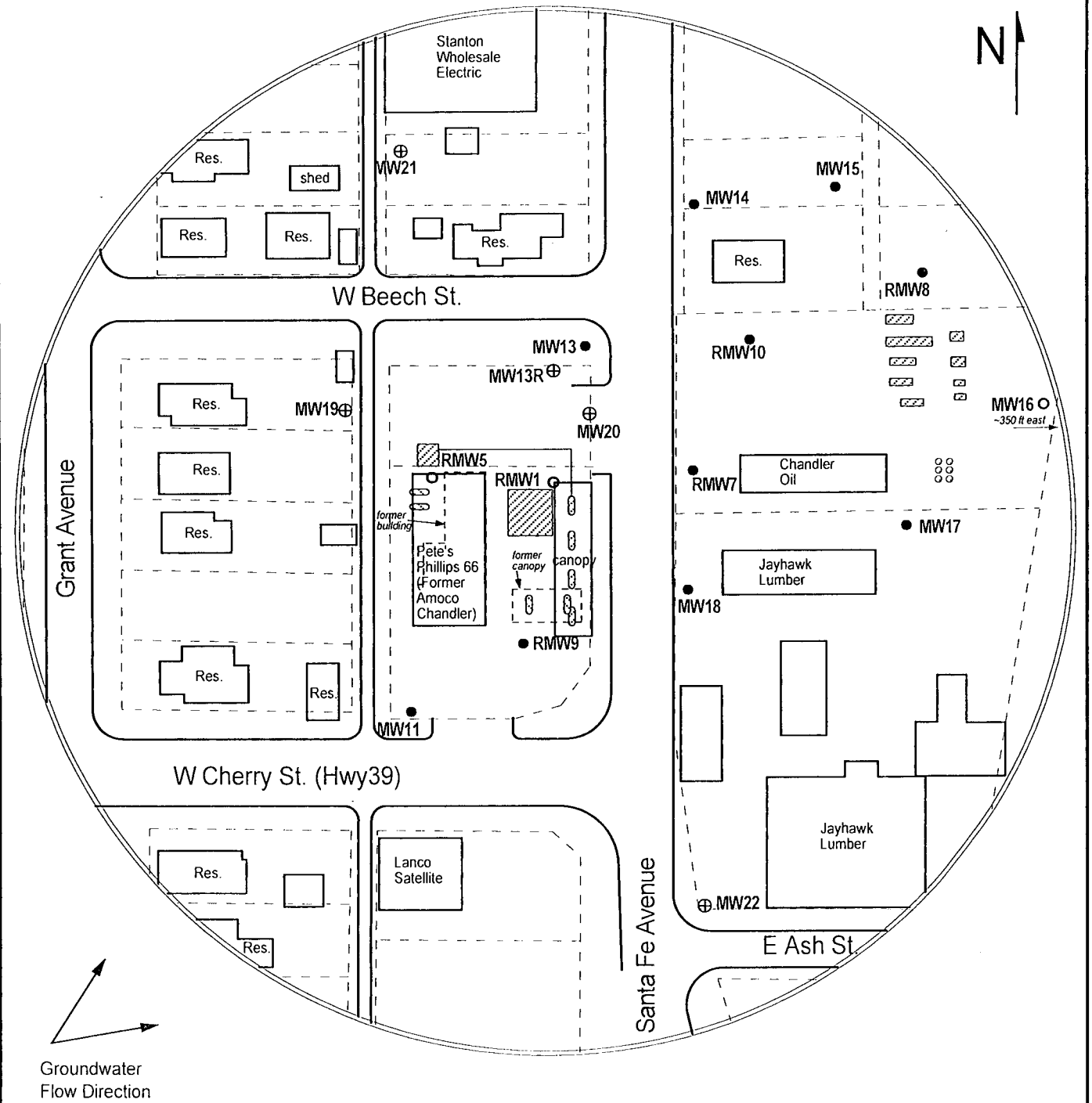

FIGURE 1 - SITE BASE MAP



PROJECT:

Amoco, Chandler
720 North Santa Fe
Chanute, KS
KDHE ID: U3-067-00050 A&B
Date: 5/5/22

0 100 ft

LEGEND:

- Approximate Location of Active UST Basin and Pump Islands
- Approximate Location of Former Pump Islands
- Approximate Location of Active ASTs
- Approximate Location of Property Line
- Monitoring Well
- Destroyed Monitoring Well
- Monitoring Well Installed 1/18-19/22 & 2/1/22

NOTE: Location of product lines is unknown.

1311 E 25th St., Suite B (785) 841-8707 office
Lawrence, KS 66046 (785) 865-4282 fax