

WATER WELL RECORD

Form WWC-5

Division of Water Resources App. No.

Well ID

MW21

[X] Original Record [] Correction [] Change in Well Ust

1 LOCATION OF WATER WELL: County Montgomery Section Number 17 Township Number T 27 S Range Number R 18 E 1 W

2 WELL OWNER: Last Name: Business: KDHE Address: 1000 SW Jackson St. City: Topeka State: KS ZIP: 66612 Street or Rural Address where well is located: ~100' N of 720 North Santa Fe, Chanute, KS

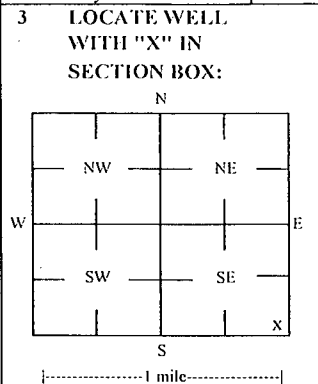

3 LOCATE WELL WITH 'X' IN SECTION BOX: 4 DEPTH OF COMPLETED WELL: 13 ft Depth(s) Groundwater Encountered: 1) ft 2) ft 3) ft, or 4) Dry Well WELLS STATIC WATER LEVEL: 4.20 ft [X] below land surface, measured on (mo-day-yr) 5/5/2022

5 Latitude: 37.68923 (decimal degrees) Longitude: 95.45322 (decimal degrees) Horizontal Datum: [] WGS 84 [] NAD 83 [] NAD 27 Source for Latitude/Longitude: [] GPS (unit make/model:) (WAAS enabled? [] Yes [] No) [X] Land Survey [] Topographic Map [] Online Mapper

6 Elevation 931.89 ft [] Ground Level [X] TOC Source [X] Land Survey [] GPS [] Topographic Map [] Other

7 WELL WATER TO BE USED AS: 1 Domestic: [] Household [] Lawn & Garden [] Livestock [] Irrigation [] Feedlot [] Industrial 5 [] Public Water Supply: well ID 6 [] Dewatering: how many wells? 7 [] Aquifer Recharge: well ID 8 [X] Monitoring: well ID MW21 9 Environmental Remediation: well ID [] Air Sparge [] Soil Vapor Extractor [] Recovery [] Injection 10 [] Oil Field Water Supply: lease 11 Test Hole: well ID [] Cased [] Uncased [] Geotechnical 12 Geothermal: How many bores? a) Closed Loop [] Horizontal [] Vertical b) Open Loop [] Surface Discharge [] Inj. of Water [] Other (specify):

Was a chemical/bacteriological sample submitted to KDHE? [] Yes [X] No If yes, date sample was submitted: Water well disinfected? [] Yes [X] No

8 TYPE OF CASING USED: [] Steel [X] PVC [] Other CASING JOINTS: [] Glued [] Clamped [] Welded [X] Threaded Casing diameter 2 in. to 3.5 ft, Diameter in. to ft, Diameter in. to ft, Casing height above land surface -0.50 in. Weight lbs./ft. Well thickness or gauge No TYPE OF SCREEN OR PERFORATION MATERIAL: [] Steel [] Stainless Steel [] Fiberglass [X] PVC [] Brass [] Galvanized Steel [] Concrete tile [] None used (open hole) [] Other (Specify) SCREEN OR PERFORATION OPENINGS ARE: [] Continuous Slot [X] Mill Slot [] Gauze Wrapped [] Torch Cut [] Drilled Holes [] Other (Specify) [] Louvered Shutter [] Key Punched [] Wire Wrapped [] Saw Cut [] None (Open Hole) SCREEN-PERFORATED INTERVALS: From 3.5 ft. to 13 ft, From ft. to ft, From ft. to ft, GRAVEL PACK INTERVALS: From 1.5 ft. to 13 ft, From ft. to ft, From ft. to ft,

9 GROUT MATERIAL: [] Neat cement [] Cement grout [X] Bentonite [X] Other Concrete: 0-0.5' Grout intervals: From 0.5 ft. to 1.5 ft, From ft. to ft, From ft. to ft,

Nearest source of possible contamination: [] Septic Tank [] Lateral Lines [] Pit Privy [] Livestock Pens [] Insecticide Storage [] Sewer Lines [] Cess Pool [] Sewage Lagoon [X] Fuel Storage [] Abandoned Water Well [] Watertight Sewer Lines [] Seepage Pit [] Feedyard [] Fertilizer Storage [] Oil Well / Gas Well [] Other (Specify) Direction from well? S Distance from well? ~190 ft

Table with 6 columns: 10 FROM, TO, LITHOLOGIC LOG, FROM, TO, LITHO. LOG (cont.) or PLUGGING INTERVALS. Row 1: 0, 0.5, Gravel, , , . Row 2: 0.5, 13, Sandstone, , , .

Notes: KDHE ID: Amoco, Chandler; U3-067-00050 A&B Target of monitoring well is shallow groundwater, <20' of grout was installed at the direction of KDHE.

11 CONTRACTOR'S OR LANDOWNER'S CERTIFICATION: This water well was [X] constructed, [] reconstructed, or [] plugged under my jurisdiction and was completed on (mo-day-year) 1/19/22 and this record is true to the best of my knowledge and belief. Kansas Water Well Contractor's License No 757 This Water Well Record was completed on (mo-day-year) 5/18/22 under the business name of Larsen & Associates, Inc. Signature

DENNIS L HANDKE

20-27-18E

1820 NW 59th Terrace
TOPEKA, KANSAS 66618
785-286-4047 Home
785-286-1990 Fax

Jess Chapman
Larson & Assoc.
1311 E. 25th St., Suite B
Lawrence, Kansas, 66046

March 6, 2022

RE: Monitor Well Elevation Survey
720 North Santa Fe, Chanute, Kansas

Proj. 22-00N
Amoco, Chandler
U3-067-00050 A&B

Bench Mark: Chisled Square on NW corner of concrete signal light base near the SE corner of property and or NW corner of Santa Fe Ave. and Cherry Street.

Elev:		North	West	
940.65		5009.19	45.63	(from SE Cor. Sec. 20-27-18E)
MW-13R	rim	935.07	North	5247.39
	top pipe	934.85	West	63.66
				NE1/4,NE1/4,NE1/NE1/4 Lat= 37.68882 Long = 95.45286
MW-19	rim	940.59	North	5221.16
	top pipe	940.26	West	195.59
				NE1/4,NE1/4,NE1/4,NE1/4 Lat= 37.68875 Long = 95.45332
MW-20	rim	935.09	North	5217.04
	top pipe	934.73	West	37.46
				NE1/4,NE1/4,NE1/4,NE1/4 Lat= 37.68874 Long = 95.45277
MW-21	rim	932.39	North	5396.10
	top pipe	931.89	West	164.25
				SE1/4,SE1/4,SE1/4,SE1/4 (Sec. 17-27-18E) Lat= 37.68923 Long = 95.45322
MW-22	rim	939.34	North	4891.46
	top pipe	939.06	East	31.62
				SW1/4,NW1/4,NW1/4,NW1/4 (Sec. 21-27-18E) Lat= 37.68785 Long = 95.45252

Lat & Long derived from Chanute 7.5' quad map. WGS 84.

Elevation established from NMGS BM H 246, NAVD 88.

If you have any questions, please feel free to call me. Thank you for the opportunity to be of service to you.

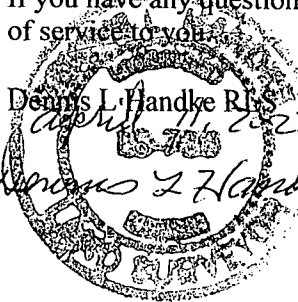
Dennis L. Handke RLS
Dennis L. Handke

NOTE: Figures exhibited within this report are only to be used within the context of this report. Placement of property lines, wells, structures, and roads is based on the available information from county appraiser maps, surveys, site visits, and/or previous vendor reports and should be considered approximate.

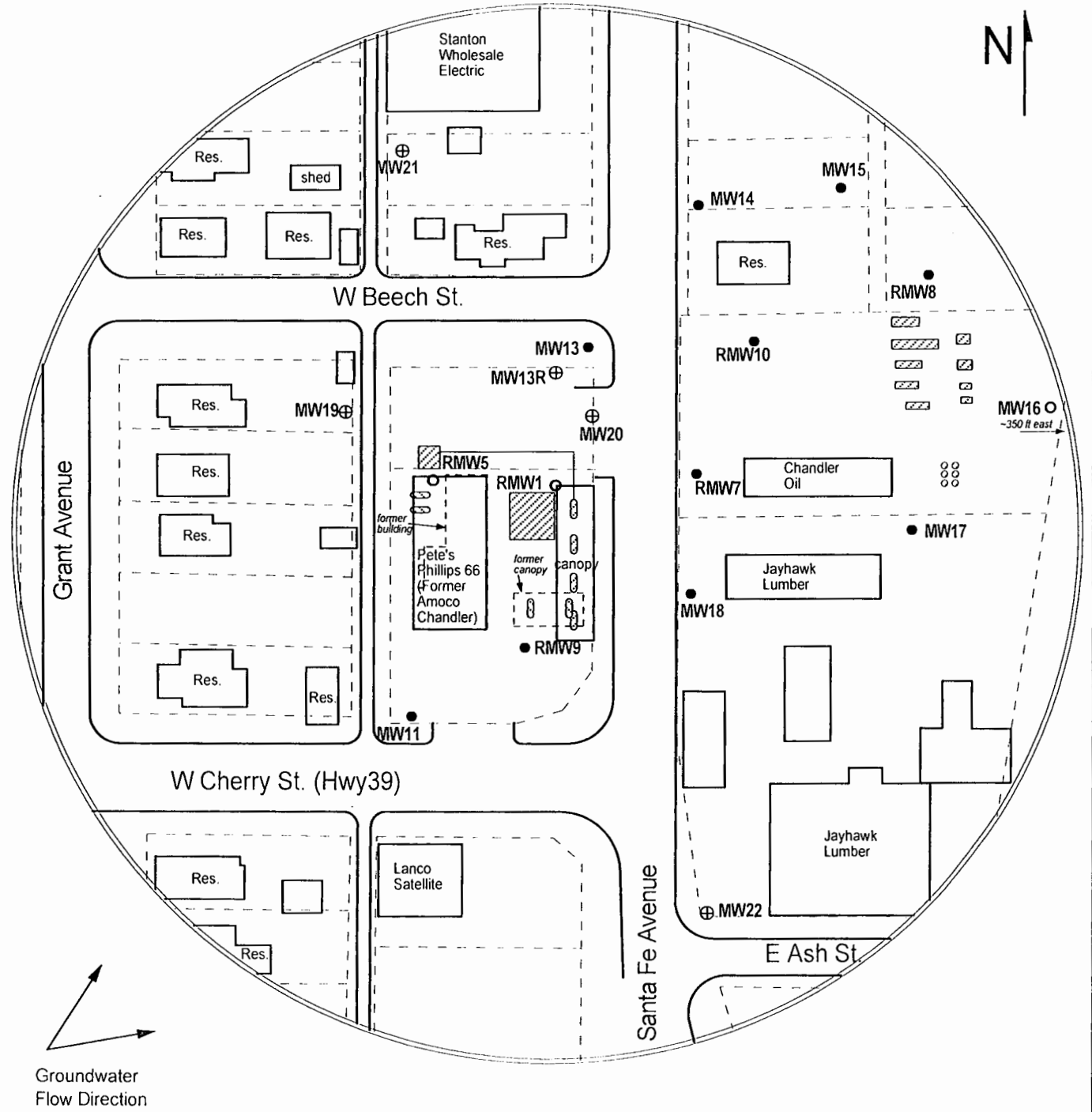

FIGURE 1 - SITE BASE MAP



PROJECT:
 Amoco, Chandler
 720 North Santa Fe
 Chanute, KS
 KDHE ID: U3-067-00050 A&B
 Date: 5/5/22

LEGEND:

- Approximate Location of Active UST Basin and Pump Islands
- Approximate Location of Former Pump Islands
- Approximate Location of Active ASTs
- Approximate Location of Property Line
- Monitoring Well
- Destroyed Monitoring Well
- Monitoring Well Installed 1/18-19/22 & 2/1/22

1311 E 25th St., Suite B (785) 841-8707 office
 Lawrence, KS 66046 (785) 865-4282 fax

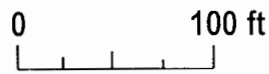

NOTE: Location of product lines is unknown.