

WATER WELL PLUGGING RECORD Form WWC-5P KSA 82a-1212 ID NO.

518417 (AS-39)

1 LOCATION OF WATER WELL: County: <u>NEOSHO</u>	Fraction <u>SW 1/4 SE 1/4 NE 1/4</u>	Section Number <u>28</u>	Township Number <u>T 27 S</u>	Range Number <u>18</u> <input checked="" type="checkbox"/> E <input type="checkbox"/> W
---	---	-----------------------------	----------------------------------	--

Street/Rural Address of Well Location; if unknown, distance & direction from nearest town or intersection: If at owner's address, check here 980 E 14TH ST, CHANUTE
1218 PHILLIPS BLDG

Global Positioning Systems (GPS) information:
Latitude: 37.6688791 (in decimal degrees)
Longitude: -95.4376958 (in decimal degrees)
Elevation: 925
Horizontal Datum: WGS84, NAD83, NAD27
Collection Method: BA

2 WATER WELL OWNER: PHILLIPS 66 COMPANY
RR#, St. Address, Box #: 411 S. Keeler Ave
City, State ZIP Code: Bartlesville, OK 74003

GPS unit (Make/Model: Trimble GeoXH)
 Digital Map/Photo, Topographic Map, Land Survey
Est. Accuracy: < 3 m, 3-5 m, 5-15 m, > 15 m

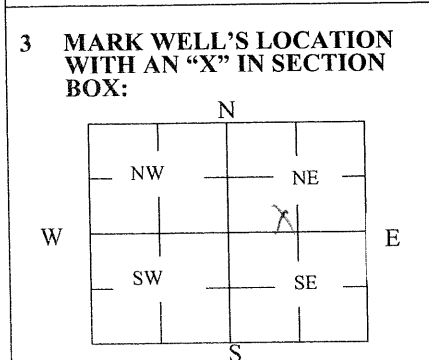

4 DEPTH OF WELL 22 ft.

WELL'S STATIC WATER LEVEL _____ ft

WELL WAS USED AS:

<input type="checkbox"/> Domestic	<input type="checkbox"/> Public Water Supply	<input type="checkbox"/> Dewatering
<input type="checkbox"/> Irrigation	<input type="checkbox"/> Oil Field Water Supply	<input type="checkbox"/> Monitoring
<input type="checkbox"/> Feedlot	<input type="checkbox"/> Domestic (Lawn & Garden)	<input type="checkbox"/> Injection Well
<input type="checkbox"/> Industrial	<input type="checkbox"/> Air Conditioning	<input checked="" type="checkbox"/> Other <u>Air Sparge</u>

Was a chemical/bacteriological sample submitted to Department? Yes No

5 TYPE OF BLANK CASING USED:

<input checked="" type="checkbox"/> Steel	<input type="checkbox"/> RMP (SR)	<input type="checkbox"/> Wrought	<input type="checkbox"/> Fiberglass	<input type="checkbox"/> Other (Specify below)
<input checked="" type="checkbox"/> PVC	<input type="checkbox"/> ABS	<input type="checkbox"/> Asbestos-Cement	<input type="checkbox"/> Concrete Tile	

Blank casing diameter 1.0 in. Was casing pulled? Yes No If yes, how much to 3 feet bgs
Casing height above or below land surface 18 in.

6 GROUT PLUG MATERIAL: Neat cement Cement grout Bentonite Other Topsoil

Grout Plug Intervals: From 0 ft. to 3 ft., From 3 ft. to 22 ft., From _____ ft. to _____ ft.

What is the nearest source of possible contamination:

<input type="checkbox"/> Septic tank	<input type="checkbox"/> Seepage pit	<input type="checkbox"/> Fuel storage	<input checked="" type="checkbox"/> Other (specify below)
<input type="checkbox"/> Sewer lines	<input type="checkbox"/> Pit privy	<input type="checkbox"/> Fertilizer storage	<u>Former Refinery Site (Closed)</u>
<input type="checkbox"/> Watertight sewer lines	<input type="checkbox"/> Sewage lagoon	<input type="checkbox"/> Insecticide storage	
<input type="checkbox"/> Lateral lines	<input type="checkbox"/> Feedyard	<input type="checkbox"/> Abandoned water well	Direction from well? _____
<input type="checkbox"/> Cess pool	<input type="checkbox"/> Livestock pens	<input type="checkbox"/> Oil well/Gas well	How many feet? _____

FROM	TO	PLUGGING MATERIALS	FROM	TO	PLUGGING MATERIALS
0	3	Topsoil			
3	22	Bentonite			

Cooperative Refinery -- Chanute C306771686

7 CONTRACTOR'S OR LANDOWNER'S CERTIFICATION: This water well was plugged under my jurisdiction and was completed on (mo/day/year) 04/28/2024 and this record is true to the best of my knowledge and belief. Kansas Water Well Contractor's License No. 759. This Water Well Record was completed on (mo/day/year) 05/30/2024 under the business name of Razek Environmental, LLC by (signature) _____

Send one white copy to Kansas Department of Health & Environment, Geology Section, 1000 SW Jackson Street, Ste. 420, Topeka, KS 66612-1367. Send one copy to WATER WELL OWNER and retain one for your records.
Visit us at <http://www.kdheks.gov/waterwell/index.html> Telephone 785-296-5524.