

WATER WELL PLUGGING RECORD Form WWC-5P KSA 82a-1212 ID NO.

518275 (AS-40)

1 LOCATION OF WATER WELL: County: NEOSHO Fraction: SW 1/4 SE 1/4 NE 1/4 Section Number: 28 Township Number: T 27 S Range Number: 18 E W

Street/Rural Address of Well Location; if unknown, distance & direction from nearest town or intersection: If at owner's address, check here 980 E 14TH ST, CHANUTE
1218 PHILLIPS BLDG

Global Positioning Systems (GPS) information:
Latitude: 37.668875 (in decimal degrees)
Longitude: -95.43791 (in decimal degrees)
Elevation: 927
Horizontal Datum: WGS84, NAD83, NAD27
Collection Method: BA

2 WATER WELL OWNER: PHILLIPS 66 COMPANY
RR#, St. Address, Box #: 411 S. Keeler Ave
City, State ZIP Code: Bartlesville, OK 74003

GPS unit (Make/Model: Trimble GeoXH)
 Digital Map/Photo, Topographic Map, Land Survey
Est. Accuracy: < 3 m, 3-5 m, 5-15 m, > 15 m

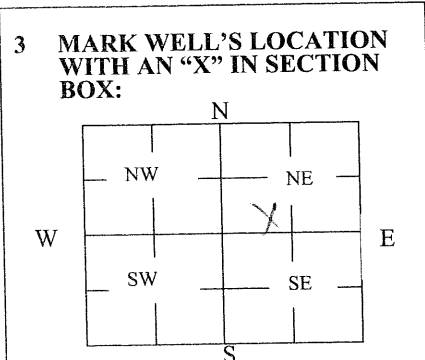

4 DEPTH OF WELL 22 ft.

WELL'S STATIC WATER LEVEL _____ ft

WELL WAS USED AS:

Domestic Public Water Supply Dewatering
 Irrigation Oil Field Water Supply Monitoring
 Feedlot Domestic (Lawn & Garden) Injection Well
 Industrial Air Conditioning Other Air Sparge

Was a chemical/bacteriological sample submitted to Department? Yes No

5 TYPE OF BLANK CASING USED:

Steel RMP (SR) Wrought Fiberglass Other (Specify below) _____
 PVC ABS Asbestos-Cement Concrete Tile

Blank casing diameter 1.0 in. Was casing pulled? Yes No If yes, how much to 3 feet bgs
 Casing height above or below land surface 18 in.

6 GROUT PLUG MATERIAL: Neat cement Cement grout Bentonite Other Topsoil

Grout Plug Intervals: From 0 ft. to 3 ft., From 3 ft. to 22 ft., From _____ ft. to _____ ft.

What is the nearest source of possible contamination:

Septic tank Seepage pit Fuel storage Other (specify below) Former Refinery Site (Closed)
 Sewer lines Pit privy Fertilizer storage
 Watertight sewer lines Sewage lagoon Insecticide storage
 Lateral lines Feedyard Abandoned water well Direction from well? _____
 Cess pool Livestock pens Oil well/Gas well How many feet? _____

FROM	TO	PLUGGING MATERIALS	FROM	TO	PLUGGING MATERIALS
0	3	Topsoil			
3	22	Bentonite			

Cooperative Refinery – Chanute C306771686

7 CONTRACTOR'S OR LANDOWNER'S CERTIFICATION: This water well was plugged under my jurisdiction and was completed on (mo/day/year) 04/28/2024 and this record is true to the best of my knowledge and belief. Kansas Water Well Contractor's License No. 759. This Water Well Record was completed on (mo/day/year) 05/30/2024 under the business name of Razek Environmental, LLC by (signature) _____

Send one white copy to Kansas Department of Health & Environment, Geology Section, 1000 SW Jackson Street, Ste. 420, Topeka, KS 66612-1367. Send one copy to WATER WELL OWNER and retain one for your records.
 Visit us at <http://www.kdheks.gov/waterwell/index.html> Telephone 785-296-5524.