

WATER WELL PLUGGING RECORD Form WWC-5P

KSA 82a-1212 ID NO.

518267 (AS-41)

| | | | | |
|---|-------------------------------------|-----------------------------|----------------------------------|--|
| 1 LOCATION OF WATER WELL: County: NEOSHO | Fraction SW ¼ SE ¼ NE ¼ ¼ | Section Number 28 | Township Number T 27 S | Range Number 18 <input checked="" type="checkbox"/> E <input type="checkbox"/> W |
|---|-------------------------------------|-----------------------------|----------------------------------|--|

Street/Rural Address of Well Location; if unknown, distance & direction from nearest town or intersection: If at owner's address, check here **980 E 14TH ST, CHANUTE**
1218 PHILLIPS BLDG

Global Positioning Systems (GPS) information:
Latitude: **37.6688763** (in decimal degrees)
Longitude: **--95.4381276** (in decimal degrees)
Elevation: **928**
Horizontal Datum: WGS84, NAD83, NAD27
Collection Method: **6A**

2 WATER WELL OWNER: PHILLIPS 66 COMPANY
RR#, St. Address, Box #: **411 S. Keeler Ave**
City, State ZIP Code: **Bartlesville, OK 74003**

GPS unit (Make/Model: **Trimble GeoXH**)
 Digital Map/Photo, Topographic Map, Land Survey
Est. Accuracy: < 3 m, 3-5 m, 5-15 m, > 15 m

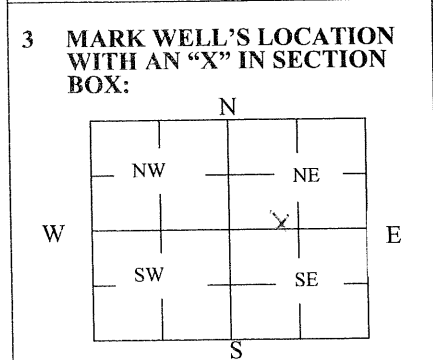

4 DEPTH OF WELL 22 ft.

WELL'S STATIC WATER LEVEL _____ ft

WELL WAS USED AS:

| | | |
|-------------------------------------|---|---|
| <input type="checkbox"/> Domestic | <input type="checkbox"/> Public Water Supply | <input type="checkbox"/> Dewatering |
| <input type="checkbox"/> Irrigation | <input type="checkbox"/> Oil Field Water Supply | <input type="checkbox"/> Monitoring |
| <input type="checkbox"/> Feedlot | <input type="checkbox"/> Domestic (Lawn & Garden) | <input type="checkbox"/> Injection Well |
| <input type="checkbox"/> Industrial | <input type="checkbox"/> Air Conditioning | <input checked="" type="checkbox"/> Other <u>Air Sparge</u> |

Was a chemical/bacteriological sample submitted to Department? Yes No

5 TYPE OF BLANK CASING USED:

Steel RMP (SR) Wrought Fiberglass Other (Specify below) _____
 PVC ABS Asbestos-Cement Concrete Tile

Blank casing diameter 1.0 in. Was casing pulled? Yes No If yes, how much to 3 feet bgs
 Casing height above or below land surface 18 in.

6 GROUT PLUG MATERIAL: Neat cement Cement grout Bentonite Other Topsoil

Grout Plug Intervals: From 0 ft. to 3 ft., From 3 ft. to 22 ft., From _____ ft. to _____ ft.

What is the nearest source of possible contamination:

| | | | |
|---|---|---|---|
| <input type="checkbox"/> Septic tank | <input type="checkbox"/> Seepage pit | <input type="checkbox"/> Fuel storage | <input checked="" type="checkbox"/> Other (specify below) |
| <input type="checkbox"/> Sewer lines | <input type="checkbox"/> Pit privy | <input type="checkbox"/> Fertilizer storage | <u>Former Refinery Site (Closed)</u> |
| <input type="checkbox"/> Watertight sewer lines | <input type="checkbox"/> Sewage lagoon | <input type="checkbox"/> Insecticide storage | |
| <input type="checkbox"/> Lateral lines | <input type="checkbox"/> Feedyard | <input type="checkbox"/> Abandoned water well | Direction from well? _____ |
| <input type="checkbox"/> Cess pool | <input type="checkbox"/> Livestock pens | <input type="checkbox"/> Oil well/Gas well | How many feet? _____ |

| FROM | TO | PLUGGING MATERIALS | FROM | TO | PLUGGING MATERIALS |
|------|----|--------------------|------|----|--------------------|
| 0 | 3 | Topsoil | | | |
| 3 | 22 | Bentonite | | | |
| | | | | | |
| | | | | | |
| | | | | | |
| | | | | | |

Cooperative Refinery – Chanute C306771686

7 CONTRACTOR'S OR LANDOWNER'S CERTIFICATION: This water well was plugged under my jurisdiction and was completed on (mo/day/year) 04/28/2024 and this record is true to the best of my knowledge and belief. Kansas Water Well Contractor's License No. 759. This Water Well Record was completed on (mo/day/year) 05/30/2024 under the business name of Razek Environmental, LLC by (signature) _____

Send one white copy to Kansas Department of Health & Environment, Geology Section, 1000 SW Jackson Street, Ste. 420, Topeka, KS 66612-1367. Send one copy to WATER WELL OWNER and retain one for your records.
 Visit us at <http://www.kdheks.gov/waterwell/index.html> Telephone 785-296-5524.