

WATER WELL PLUGGING RECORD Form WWC-5P KSA 82a-1212 ID NO.

507096 (AS-11)

1 LOCATION OF WATER WELL: County: NEOSHO Fraction SE 1/4 SW 1/4 NE 1/4 Section Number 28 Township Number T 27 S Range Number 18 E W

Street/Rural Address of Well Location; if unknown, distance & direction from nearest town or intersection: If at owner's address, check here 980 E 14TH ST, CHANUTE
1218 PHILLIPS BLDG

Global Positioning Systems (GPS) information:
Latitude: 37.6688941 (in decimal degrees)
Longitude: -95.4374849 (in decimal degrees)
Elevation: 924
Horizontal Datum: WGS84, NAD83, NAD27
Collection Method: _{BA}

2 WATER WELL OWNER: PHILLIPS 66 COMPANY
RR#, St. Address, Box #: 411 S. Keeler Ave
City, State ZIP Code: Bartlesville, OK 74003

GPS unit (Make/Model: Trimble GeoXH)
 Digital Map/Photo, Topographic Map, Land Survey
Est. Accuracy: < 3 m, 3-5 m, 5-15 m, > 15 m

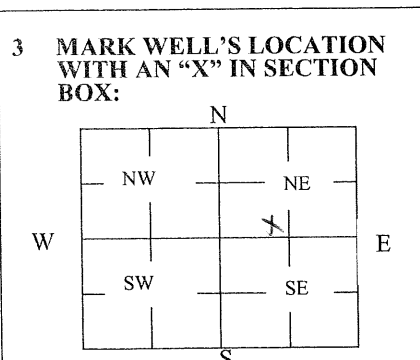

4 DEPTH OF WELL 28 ft.
WELL'S STATIC WATER LEVEL _____ ft.
WELL WAS USED AS:
 Domestic Public Water Supply Dewatering
 Irrigation Oil Field Water Supply Monitoring
 Feedlot Domestic (Lawn & Garden) Injection Well
 Industrial Air Conditioning Other Air Sparge
Was a chemical/bacteriological sample submitted to Department? Yes No

5 TYPE OF BLANK CASING USED:
 Steel RMP (SR) Wrought Fiberglass Other (Specify below)
 PVC ABS Asbestos-Cement Concrete Tile
Blank casing diameter 1.0 in. Was casing pulled? Yes No If yes, how much to 3 feet bgs
Casing height above or below land surface 18 in.

6 GROUT PLUG MATERIAL: Neat cement Cement grout Bentonite Other Topsoil
Grout Plug Intervals: From 0 ft. to 3 ft., From 3 ft. to 28 ft., From _____ ft. to _____ ft.
What is the nearest source of possible contamination:
 Septic tank Seepage pit Fuel storage Other (specify below)
 Sewer lines Pit privy Fertilizer storage Former Refinery Site (Closed)
 Watertight sewer lines Sewage lagoon Insecticide storage
 Lateral lines Feedyard Abandoned water well Direction from well? _____
 Cess pool Livestock pens Oil well/Gas well How many feet? _____

FROM	TO	PLUGGING MATERIALS	FROM	TO	PLUGGING MATERIALS
0	3	Topsoil			
3	28	Bentonite			

Cooperative Refinery – Chanute C306771686

7 CONTRACTOR'S OR LANDOWNER'S CERTIFICATION: This water well was plugged under my jurisdiction and was completed on (mo/day/year) 04/28/2024 and this record is true to the best of my knowledge and belief. Kansas Water Well Contractor's License No. 759. This Water Well Record was completed on (mo/day/year) 05/30/2024 under the business name of Razek Environmental, LLC by (signature) [Signature]

Send one white copy to Kansas Department of Health & Environment, Geology Section, 1000 SW Jackson Street, Ste. 420, Topeka, KS 66612-1367. Send one copy to WATER WELL OWNER and retain one for your records.
Visit us at <http://www.kdheks.gov/waterwell/index.html> Telephone 785-296-5524.
KSA82a-1212 Revised 1/20/2015