

**WATER WELL PLUGGING RECORD Form WWC-5P**

**KSA 82a-1212 ID NO.**

441357 (MW 17)

<b>1 LOCATION OF WATER WELL:</b> County: <b>NEOSHO</b>	Fraction <b>SW 1/4 SE 1/4 NE 1/4 1/4</b>	Section Number <b>28</b>	Township Number <b>T 27 S</b>	Range Number <b>18</b> <input checked="" type="checkbox"/> E <input type="checkbox"/> W
---	---	-----------------------------	----------------------------------	--

Street/Rural Address of Well Location; if unknown, distance & direction from nearest town or intersection: If at owner's address, check here  **980 E 14TH ST, CHANUTE**  
**1218 PHILLIPS BLDG**

**Global Positioning Systems (GPS) information:**  
Latitude: **37.6682816** (in decimal degrees)  
Longitude: **-95.4380678** (in decimal degrees)  
Elevation: \_\_\_\_\_  
Horizontal Datum:  WGS84,  NAD83,  NAD27  
Collection Method: \_\_\_\_\_

**2 WATER WELL OWNER: PHILLIPS 66 COMPANY**  
RR#, St. Address, Box #: **411 S. Keeler Ave**  
City, State ZIP Code: **Bartlesville, OK 74003**

GPS unit (Make/Model: **Trimble GeoXH**)  
 Digital Map/Photo,  Topographic Map,  Land Survey  
Est. Accuracy:  < 3 m,  3-5 m,  5-15 m,  > 15 m

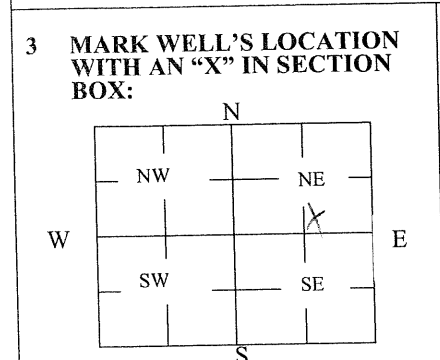

**4 DEPTH OF WELL** 28 **ft.**

WELL'S STATIC WATER LEVEL \_\_\_\_\_ ft

WELL WAS USED AS:

<input type="checkbox"/> Domestic	<input type="checkbox"/> Public Water Supply	<input type="checkbox"/> Dewatering
<input type="checkbox"/> Irrigation	<input type="checkbox"/> Oil Field Water Supply	<input checked="" type="checkbox"/> Monitoring
<input type="checkbox"/> Feedlot	<input type="checkbox"/> Domestic (Lawn & Garden)	<input type="checkbox"/> Injection Well
<input type="checkbox"/> Industrial	<input type="checkbox"/> Air Conditioning	<input type="checkbox"/> Other _____

Was a chemical/bacteriological sample submitted to Department? Yes  No

**5 TYPE OF BLANK CASING USED:**

Steel  RMP (SR)  Wrought  Fiberglass  Other (Specify below) \_\_\_\_\_  
 PVC  ABS  Asbestos-Cement  Concrete Tile

Blank casing diameter 2.0 in. Was casing pulled? Yes  No  If yes, how much to 3 feet bgs \_\_\_\_\_  
 Casing height above or below land surface 30 in.

**6 GROUT PLUG MATERIAL:**  Neat cement  Cement grout  Bentonite  Other Topsoil

Grout Plug Intervals: From 0 ft. to 3 ft., From 3 ft. to 28 ft., From \_\_\_\_\_ ft. to \_\_\_\_\_ ft.

What is the nearest source of possible contamination:

<input type="checkbox"/> Septic tank	<input type="checkbox"/> Seepage pit	<input type="checkbox"/> Fuel storage	<input checked="" type="checkbox"/> Other (specify below)
<input type="checkbox"/> Sewer lines	<input type="checkbox"/> Pit privy	<input type="checkbox"/> Fertilizer storage	<u>Former Refinery Site (Closed)</u>
<input type="checkbox"/> Watertight sewer lines	<input type="checkbox"/> Sewage lagoon	<input type="checkbox"/> Insecticide storage	
<input type="checkbox"/> Lateral lines	<input type="checkbox"/> Feedyard	<input type="checkbox"/> Abandoned water well	Direction from well? _____
<input type="checkbox"/> Cess pool	<input type="checkbox"/> Livestock pens	<input type="checkbox"/> Oil well/Gas well	How many feet? _____

FROM	TO	PLUGGING MATERIALS	FROM	TO	PLUGGING MATERIALS
0	3'	Topsoil			
3	28'	Bentonite			

Cooperative Refinery – Chanute C306771686

**7 CONTRACTOR'S OR LANDOWNER'S CERTIFICATION:** This water well was plugged under my jurisdiction and was completed on (mo/day/year) 04/29/2024 and this record is true to the best of my knowledge and belief. Kansas Water Well Contractor's License No. 759. This Water Well Record was completed on (mo/day/year) 05/30/2024 under the business name of Razek Environmental, LLC by (signature) \_\_\_\_\_

Send one white copy to Kansas Department of Health & Environment, Geology Section, 1000 SW Jackson Street, Ste. 420, Topeka, KS 66612-1367. Send one copy to WATER WELL OWNER and retain one for your records.  
 Visit us at <http://www.kdheks.gov/waterwell/index.html> Telephone 785-296-5524.