

WATER WELL PLUGGING RECORD Form WWC-5P

KSA 82a-1212 ID NO.

404755 MW-15

1 LOCATION OF WATER WELL: Fraction NE 1/4 NW 1/4 NE 1/4 1/4 Section Number 28 Township Number T 27 S Range Number 18 E W
 County: NEOSHO

Street/Rural Address of Well Location; if unknown, distance & direction from nearest town or intersection: If at owner's address, check here 980 E 14TH ST, CHANUTE
1218 PHILLIPS BLDG

Global Positioning Systems (GPS) information:
 Latitude: 37.6738254 (in decimal degrees)
 Longitude: -95.4395914 (in decimal degrees)
 Elevation: _____
 Horizontal Datum: WGS84, NAD83, NAD27
 Collection Method: _____

2 WATER WELL OWNER: PHILLIPS 66 COMPANY
 RR#, St. Address, Box #: 411 S. Keeler Ave
 City, State ZIP Code: Bartlesville, OK 74003

GPS unit (Make/Model: Trimble GeoXH)
 Digital Map/Photo, Topographic Map, Land Survey
 Est. Accuracy: < 3 m, 3-5 m, 5-15 m, > 15 m

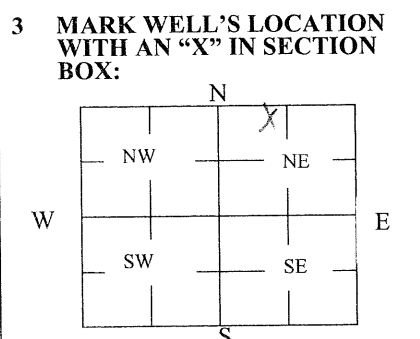

4 DEPTH OF WELL 19 ft.
 WELL'S STATIC WATER LEVEL _____ ft.
 WELL WAS USED AS:
 Domestic Public Water Supply Dewatering
 Irrigation Oil Field Water Supply Monitoring
 Feedlot Domestic (Lawn & Garden) Injection Well
 Industrial Air Conditioning Other _____
 Was a chemical/bacteriological sample submitted to Department? Yes No

5 TYPE OF BLANK CASING USED:
 Steel RMP (SR) Wrought Fiberglass Other (Specify below) _____
 PVC ABS Asbestos-Cement Concrete Tile
 Blank casing diameter 2.0 in. Was casing pulled? Yes No If yes, how much to 3 feet bgl
 Casing height above or below land surface 30 in.

6 GROUT PLUG MATERIAL: Neat cement Cement grout Bentonite Other Topsoil
 Grout Plug Intervals: From 0 ft. to 3 ft., From 3 ft. to 19 ft., From _____ ft. to _____ ft.
 What is the nearest source of possible contamination:
 Septic tank Seepage pit Fuel storage Other (specify below) _____
 Sewer lines Pit privy Fertilizer storage Former Refinery Site (Closed)
 Watertight sewer lines Sewage lagoon Insecticide storage
 Lateral lines Feedyard Abandoned water well Direction from well? _____
 Cess pool Livestock pens Oil well/Gas well How many feet? _____

FROM	TO	PLUGGING MATERIALS	FROM	TO	PLUGGING MATERIALS
0	3'	Topsoil			
3	19'	Bentonite			

Cooperative Refinery – Chanute C306771686

7 CONTRACTOR'S OR LANDOWNER'S CERTIFICATION: This water well was plugged under my jurisdiction and was completed on (mo/day/year) 04/29/2024 and this record is true to the best of my knowledge and belief. Kansas Water Well Contractor's License No. 759. This Water Well Record was completed on (mo/day/year) 05/30/2024 under the business name of Razek Environmental, LLC by (signature) _____

Send one white copy to Kansas Department of Health & Environment, Geology Section, 1000 SW Jackson Street, Ste. 420, Topeka, KS 66612-1367. Send one copy to WATER WELL OWNER and retain one for your records.
 Visit us at <http://www.kdheks.gov/waterwell/index.html> Telephone 785-296-5524.