

WATER WELL PLUGGING RECORD Form WWC-5P KSA 82a-1212 ID NO.

1 LOCATION OF WATER WELL: County: Dodge Fraction: 1/2 SE 1/4 NW 1/4 SW 1/4 Section Number: 24 Township Number: T 27 S Range Number: 2 E W

Street/Rural Address of Well Location; if unknown, distance & direction from nearest town or intersection: If at owner's address, check here 3402 Hilldale

Global Positioning Systems (GPS) information:
 Latitude: _____ (in decimal degrees)
 Longitude: _____ (in decimal degrees)
 Elevation: _____
 Horizontal Datum: WGS84, NAD83, NAD27
 Collection Method: _____

2 WATER WELL OWNER: Mr Pierron
 RR#, St. Address, Box #: 3402 Hilldale
 City, State ZIP Code: Wichita, KS 67230

GPS unit (Make/Model: _____)
 Digital Map/Photo, Topographic Map, Land Survey
 Est. Accuracy: < 3 m, 3-5 m, 5-15 m, > 15 m

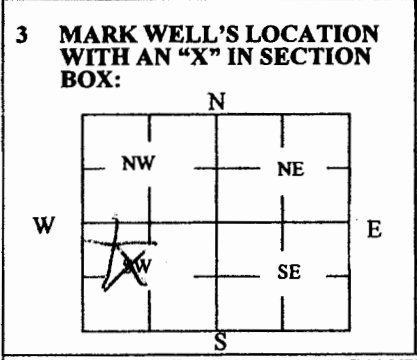

4 DEPTH OF WELL _____ ft.
 WELL'S STATIC WATER LEVEL _____ ft.
 WELL WAS USED AS:

Domestic Public Water Supply Dewatering
 Irrigation Oil Field Water Supply Monitoring
 Feedlot Domestic (Lawn & Garden) Injection Well
 Industrial Air Conditioning Other _____

Was a chemical/bacteriological sample submitted to Department? Yes No

5 TYPE OF BLANK CASING USED:

Steel RMP (SR) Wrought Fiberglass Other (Specify below) _____
 PVC ABS Asbestos-Cement Concrete Tile

Blank casing diameter 5 in. Was casing pulled? Yes No If yes, how much 1'
 Casing height above or below land surface 6 in.

6 GROUT PLUG MATERIAL: Neat cement Cement grout Bentonite Other _____

Grout Plug Intervals: From 60 ft. to 1 ft., From _____ ft. to _____ ft., From _____ ft. to _____ ft.

What is the nearest source of possible contamination:

Septic tank Seepage pit Fuel storage Other (specify below) _____
 Sewer lines Pit privy Fertilizer storage
 Watertight sewer lines Sewage lagoon Insecticide storage
 Lateral lines Feedyard Abandoned water well
 Cess pool Livestock pens Oil well/Gas well

Direction from well? north
 How many feet? 10'

FROM	TO	PLUGGING MATERIALS	FROM	TO	PLUGGING MATERIALS
<u>60</u>	<u>1</u>	<u>Bentonite</u>			
<u>1</u>	<u>0</u>	<u>Cement Cap</u>	<u>Basement</u>		<u>Floor</u>

7 CONTRACTOR'S OR LANDOWNER'S CERTIFICATION: This water well was plugged under my jurisdiction and was completed on (mo/day/year) 12-19-16 and this record is true to the best of my knowledge and belief. Kansas Water Well Contractor's License No. 472. This Water Well Record was completed on (mo/day/year) 12-19-16 under the business name of Beardon Pump & Well by (signature) Rand Beesh

Send one white copy to Kansas Department of Health & Environment, Geology Section, 1000 SW Jackson Street, Ste. 420, Topeka, KS 66612-1367. Send one copy to WATER WELL OWNER and retain one for your records.
 Visit us at <http://www.kdheks.gov/waterwell/index.html> Telephone 785-296-5524.