

WATER WELL RECORD Form WWC-5

Division of Water Resources App. No.

Well ID MW 15R

Original Record Correction Change in Well Use

1 LOCATION OF WATER WELL: County: Sedgwick Fraction 1/4 NW 1/4 NW 1/4 NW 1/4 Section Number 18 Township Number T 27 S Range Number R 2 E W

2 WELL OWNER: Last Name: Business: BP Products North America Address: 28100 Torch Parkway City: Warrenville State: IL ZIP: 60555 Street or Rural Address where well is located: Former Amoco #8542 6327 East 13th Street, Wichita, KS 67208

3 LOCATE WELL WITH 'X' IN SECTION BOX: N W E S 1 mile scale

4 DEPTH OF COMPLETED WELL: 15 ft. Depth(s) Groundwater Encountered: 1) ... ft. 2) ... ft. 3) ... ft., or 4) Dry Well WELL'S STATIC WATER LEVEL: below land surface, measured on (mo-day-yr) ... ft. above land surface, measured on (mo-day-yr) ... ft. Pump test data: Well water was N/A ft. after N/A hours pumping N/A gpm Well water was N/A ft. after N/A hours pumping N/A gpm Estimated Yield: N/A gpm Bore Hole Diameter: 8.25 in. to 15 ft. and N/A in. to N/A ft.

5 Latitude: 37.7078639 (decimal degrees) Longitude: -97.262061 (decimal degrees) Horizontal Datum: WGS 84 NAD 83 NAD 27 Source for Latitude/Longitude: GPS (unit make/model) ... (WAAS enabled? Yes No) Land Survey Topographic Map Online Mapper: Google Earth 6 Elevation: 1387 ft. Ground Level TOC Source: Land Survey GPS Topographic Map Other

7 WELL WATER TO BE USED AS: 1. Domestic: Household Lawn & Garden Livestock Irrigation Feedlot Industrial 5. Public Water Supply: well ID 6. Dewatering: how many wells? 7. Aquifer Recharge: well ID 8. Monitoring: well ID MW-15R 9. Environmental Remediation: well ID Air Sparge Soil Vapor Extraction Recovery Injection 10. Oil Field Water Supply: lease 11. Test Hole: well ID Cased Uncased Geotechnical 12. Geothermal: how many bores? a) Closed Loop Horizontal Vertical b) Open Loop Surface Discharge Inj. of Water 13. Other (specify):

Was a chemical/bacteriological sample submitted to KDHE? Yes No If yes, date sample was submitted: Water well disinfected? Yes No

8 TYPE OF CASING USED: Steel PVC Other CASING JOINTS: Glued Clamped Welded Threaded Casing diameter 2 in. to 5 ft., Diameter N/A in. to N/A ft., Diameter N/A in. to N/A ft. Casing height above land surface 0 in. Weight N/A lbs./ft. Wall thickness or gauge No. Sch. 40

TYPE OF SCREEN OR PERFORATION MATERIAL: Steel Stainless Steel Fiberglass PVC Other (Specify) Brass Galvanized Steel Concrete tile None used (open hole) SCREEN OR PERFORATION OPENINGS ARE: Continuous Slot Mill Slot Gauze Wrapped Torch Cut Drilled Holes Other (Specify) Louvered Shutter Key Punched Wire Wrapped Saw Cut None (Open Hole) SCREEN-PERFORATED INTERVALS: From .5 ft. to 15 ft., From N/A ft. to N/A ft., From N/A ft. to N/A ft. GRAVEL PACK INTERVALS: From 3 ft. to 15 ft., From N/A ft. to N/A ft., From N/A ft. to N/A ft.

9 GROUT MATERIAL: Neat cement Cement grout Bentonite Other 0 to 1 Concrete Grout Intervals: From 1 ft. to 3 ft., From N/A ft. to N/A ft., From N/A ft. to N/A ft. Nearest source of possible contamination: Septic Tank Lateral Lines Pit Privy Livestock Pens Insecticide Storage Sewer Lines Cess Pool Sewage Lagoon Fuel Storage Abandoned Water Well Watertight Sewer Lines Seepage Pit Feedyard Fertilizer Storage Oil Well/Gas Well Other (Specify) Direction from well? NW Distance from well? 180 ft.

Table with columns: 10 FROM TO LITHOLOGIC LOG FROM TO LITHO. LOG (cont.) or PLUGGING INTERVALS. Rows: 0 6" Concrete; 6" 15 Clay; Notes:

11 CONTRACTOR'S OR LANDOWNER'S CERTIFICATION: This water well was constructed, reconstructed, or plugged under my jurisdiction and was completed on (mo-day-year) 10-17-17 and this record is true to the best of my knowledge and belief. Kansas Water Well Contractor's License No. 759 This Water Well Record was completed on (mo-day-year) 11-5-17 under the business name of RAZEK Environmental, LLC Signature

# DENNIS L HANDKE

1820 NW 59th Terrace  
TOPEKA, KANSAS 66618  
785-286-4047 Home  
785-217-5864 Cell

Meredith Watson  
TerraNext, LLC  
11904 Grandview Ave.  
Grandview, Missouri, 64030

October 27, 2017

RE: Monitor Well Elevation Survey  
6327 E. 13<sup>th</sup> Street, Wichita, Kansas

Proj. 17-00FF  
AMOCO #8542  
U2-087-01162

Bench Mark: Chisled square on the SW corner of concrete signal light base near NE corner of property.  
Elev: 1388.44      North 5240.06      West 44.50      (from SE Cor. Sec.13-27-1E)

|            |         |       |         |      |       |                                       |
|------------|---------|-------|---------|------|-------|---------------------------------------|
| MW-12R rim | 1389.97 | North | 5119.80 | West | 70.51 | NE1/4,NE1/4,NE1/4,NE1/4               |
| top pipe   | 1389.37 |       |         |      |       | Lat= 37.70793    Long = 97.26249      |
| MW-15R rim | 1386.65 | North | 5067.96 | East | 54.28 | NW1/4,NW1/4,NW1/4,NW1/4 (Sec.18-27-2) |
| top pipe   | 1386.37 |       |         |      |       | Lat= 37.70781    Long = 97.26205      |

Elevation derived from existing project.

Lat & Long derived from Wichita East 7.5 minute Quad Map WGS84.

If you have any questions, please feel free to call me. Thank you for the opportunity to be of service to you.

*November 3, 2017*  
Dennis L. Handke RS

*Dennis L Handke*

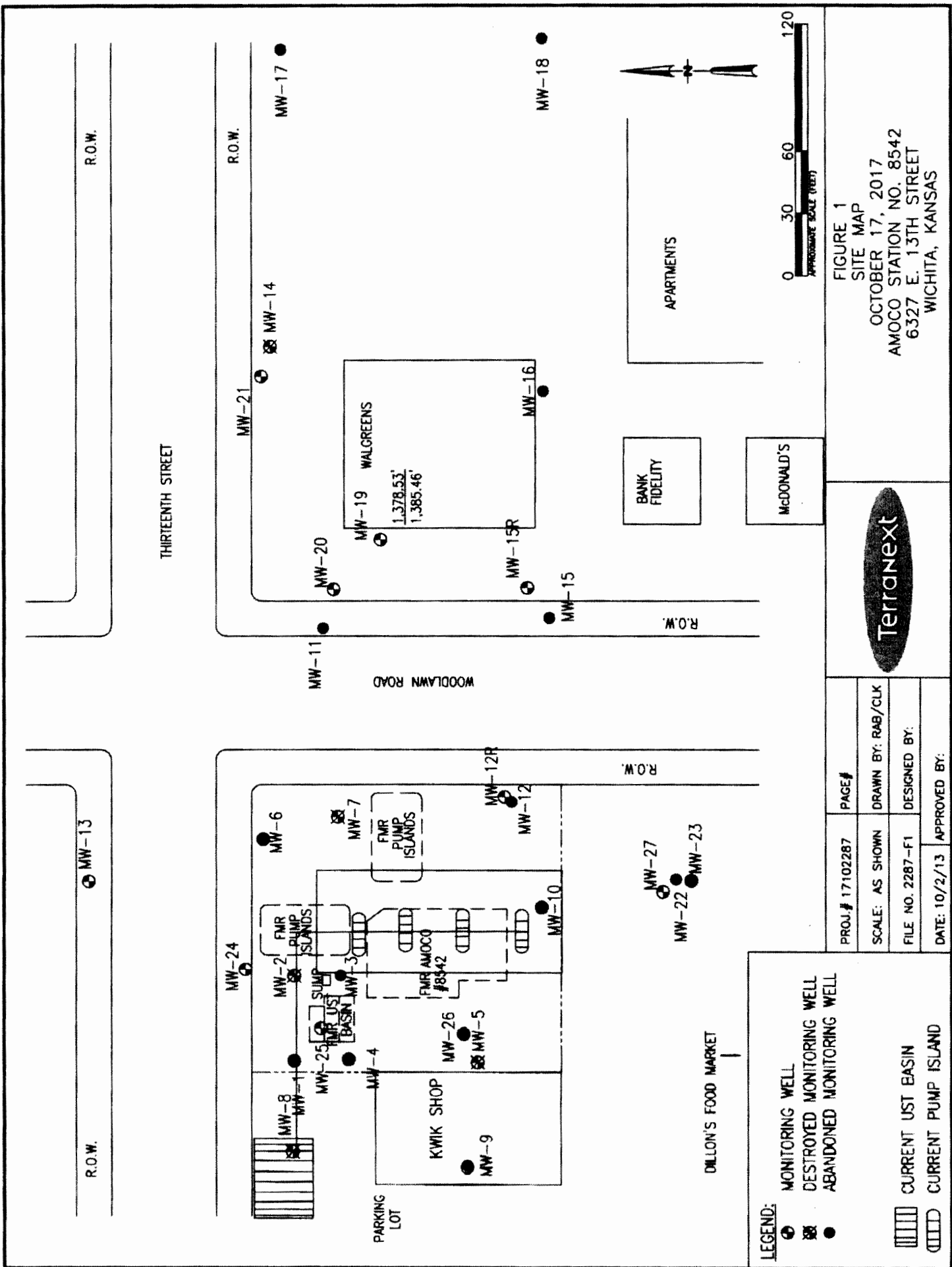

FIGURE 1  
 SITE MAP  
 OCTOBER 17, 2017  
 AMOCO STATION NO. 8542  
 6327 E. 13TH STREET  
 WICHITA, KANSAS



|                  |                   |
|------------------|-------------------|
| PROJ. # 17102287 | PAGE #            |
| SCALE: AS SHOWN  | DRAWN BY: RAB/CLK |
| FILE NO. 2287-F1 | DESIGNED BY:      |
| DATE: 10/2/13    | APPROVED BY:      |

**LEGEND:**

|  |                           |
|--|---------------------------|
|  | MONITORING WELL           |
|  | DESTROYED MONITORING WELL |
|  | ABANDONED MONITORING WELL |
|  | CURRENT UST BASIN         |
|  | CURRENT PUMP ISLAND       |