

MW-116

WATER WELL PLUGGING RECORD Form WWC-5P KSA 82a-1212 ID NO.

1 LOCATION OF WATER WELL: County: Butler Fraction 1/4 NE 1/4 NW 1/4 NE 1/4 Section Number 27 Township Number T 27 S Range Number 4 [X] E [] W

Street/Rural Address of Well Location; if unknown, distance & direction from nearest town or intersection: If at owner's address, check here [] 645 North State Street; Augusta KS Global Positioning Systems (GPS) information: Latitude: 37.67860 (in decimal degrees) Longitude: 96.97981 (in decimal degrees) Elevation: Datum: [X] WGS84, [] NAD83, [] NAD27 Collection Method: [X] GPS unit (Make/Model: Garmin etrek 10) [] Digital Map/Photo, [] Topographic Map, [] Land Survey Est. Accuracy: [] < 3 m, [X] 3-5 m, [] 5-15 m, [] > 15 m

2 WATER WELL OWNER: Bank of America RR#, St. Address, Box #: 1100 North King St. City, State ZIP Code: Wilmington DE 19884

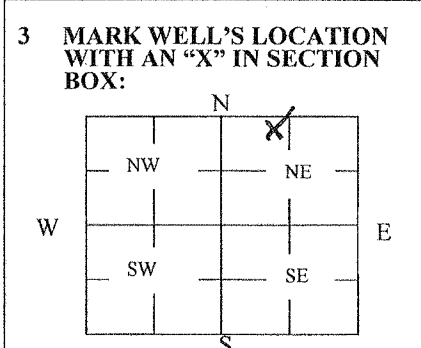

4 DEPTH OF WELL 17 ft. WELL'S STATIC WATER LEVEL 8.45 ft. WELL WAS USED AS: [] Domestic [] Irrigation [] Feedlot [] Industrial [] Public Water Supply [] Oil Field Water Supply [] Domestic (Lawn & Garden) [] Air Conditioning [] Dewatering [X] Monitoring [] Injection Well [] Other Was a chemical/bacteriological sample submitted to Department? Yes [] No [X]

5 TYPE OF BLANK CASING USED: [X] Steel [] PVC [] RMP (SR) [] ABS [] Wrought [] Asbestos-Cement [] Fiberglass [] Concrete Tile [] Other (Specify below) Blank casing diameter 2 in. Was casing pulled? Yes [X] No [] If yes, how much 7 Casing height above or below land surface 4 in.

6 GROUT PLUG MATERIAL: [] Neat cement [] Cement grout [X] Bentonite [] Other Grout Plug Intervals: From ___ ft. to ___ ft., From ___ ft. to ___ ft., From ___ to ___ ft. What is the nearest source of possible contamination: [] Septic tank [] Sewer lines [] Watertight sewer lines [] Lateral lines [] Cess pool [] Seepage pit [] Pit privy [] Sewage lagoon [] Feedyard [] Livestock pens [] Fuel Storage [] Fertilizer storage [] Insecticide storage [] Abandoned water well [] Oil well/Gas well [] Other (specify below) Direction from well? How many feet?

Table with columns: FROM, TO, PLUGGING MATERIALS. Row 1: FROM 17, TO 3, Bentonite. Row 2: FROM 3, TO 0, Topsoil.

7 CONTRACTOR'S OR LANDOWNER'S CERTIFICATION: This water well was plugged under my jurisdiction and was completed on (mo/day/year) 6-26-14 and this record is true to the best of my knowledge and belief. Kansas Water Well Contractor's License No. 710. This Water Well Record was completed on (mo/day/year) 7-7-14 under the business name of Below Ground Surface, Inc. by (signature) [Signature]

INSTRUCTIONS: Use typewriter or ballpoint pen. Please press firmly and print clearly. Please fill in blanks, underline or circle the correct answers. Send one copy to Kansas Department of Health and Environment, Bureau of Water, Geology Section, 1000 SW Jackson St., Ste. 420, Topeka, Kansas 66612-1367. Telephone: 785/296-5524. Send one to Water Well Owner and retain one for your records. Visit us at http://www.kdheks.gov/waterwell/index.html.