

**WATER WELL RECORD Form WWC-5**

Original Record    Correction    Change in Well Use

Division of Water Resources App. No. \_\_\_\_\_

Well ID \_\_\_\_\_

<b>1 LOCATION OF WATER WELL:</b> County: _____	Fraction $\frac{1}{4}$ $\frac{1}{4}$ $\frac{1}{4}$ $\frac{1}{4}$	Section Number _____	Township Number T   S	Range Number R <input type="checkbox"/> E <input type="checkbox"/> W
---	---	----------------------	--------------------------	---

<b>2 WELL OWNER:</b> Last Name: _____ Business: _____ Address: _____ Address: _____ City: _____ State: _____ ZIP: _____	First: _____ <b>Street or Rural Address</b> where well is located (if unknown, distance and direction from nearest town or intersection): If at owner's address, check here: <input type="checkbox"/>
---	--

<p><b>3 LOCATE WELL WITH "X" IN SECTION BOX:</b> N</p> <div style="border: 1px solid black; padding: 5px; margin: 10px auto; width: fit-content;"> <table style="border-collapse: collapse; text-align: center;"> <tr> <td style="border: none;">NW</td> <td style="border: none;">NE</td> </tr> <tr> <td style="border: none;">SW</td> <td style="border: none;">SE</td> </tr> </table> <p style="text-align: center;">S</p> <p style="text-align: center;">-----1 mile-----</p> </div>	NW	NE	SW	SE	<p><b>4 DEPTH OF COMPLETED WELL:</b> _____ ft. Depth(s) Groundwater Encountered: 1) _____ ft. 2) _____ ft. 3) _____ ft., or 4) <input type="checkbox"/> Dry Well <b>WELL'S STATIC WATER LEVEL:</b> _____ ft. <input type="checkbox"/> below land surface, measured on (mo-day-yr)..... <input type="checkbox"/> above land surface, measured on (mo-day-yr)..... Pump test data: Well water was _____ ft. after..... hours pumping ..... gpm Well water was _____ ft. after..... hours pumping ..... gpm Estimated Yield: .....gpm Bore Hole Diameter: ..... in. to ..... ft. and ..... in. to ..... ft.</p>	<p><b>5 Latitude:</b> .....(decimal degrees) <b>Longitude:</b> .....(decimal degrees) Datum: <input type="checkbox"/> WGS 84   <input type="checkbox"/> NAD 83   <input type="checkbox"/> NAD 27 <b>Source for Latitude/Longitude:</b> <input type="checkbox"/> GPS (unit make/model: .....) (WAAS enabled? <input type="checkbox"/> Yes   <input type="checkbox"/> No) <input type="checkbox"/> Land Survey   <input type="checkbox"/> Topographic Map <input type="checkbox"/> Online Mapper: .....</p>
NW	NE					
SW	SE					
<p><b>6 Elevation:</b> .....ft.   <input type="checkbox"/> Ground Level   <input type="checkbox"/> TOC Source: <input type="checkbox"/> Land Survey   <input type="checkbox"/> GPS   <input type="checkbox"/> Topographic Map <input type="checkbox"/> Other .....</p>						

**7 WELL WATER TO BE USED AS:**

1. Domestic: <input type="checkbox"/> Household <input type="checkbox"/> Lawn & Garden <input type="checkbox"/> Livestock	5. <input type="checkbox"/> Public Water Supply: well ID .....	10. <input type="checkbox"/> Oil Field Water Supply: lease .....
2. <input type="checkbox"/> Irrigation	6. <input type="checkbox"/> Dewatering: how many wells? .....	11. Test Hole: well ID ..... <input type="checkbox"/> Cased <input type="checkbox"/> Uncased <input type="checkbox"/> Geotechnical
3. <input type="checkbox"/> Feedlot	7. <input type="checkbox"/> Aquifer Recharge: well ID .....	12. Geothermal: how many bores? ..... a) Closed Loop <input type="checkbox"/> Horizontal <input type="checkbox"/> Vertical
4. <input type="checkbox"/> Industrial	8. <input type="checkbox"/> Monitoring: well ID .....	b) Open Loop <input type="checkbox"/> Surface Discharge <input type="checkbox"/> Inj. of Water
	9. Environmental Remediation: well ID ..... <input type="checkbox"/> Air Sparge <input type="checkbox"/> Soil Vapor Extraction	13. <input type="checkbox"/> Other (specify): .....
	<input type="checkbox"/> Recovery <input type="checkbox"/> Injection	

**Was a chemical/bacteriological sample submitted to KDHE?**  Yes    No   If yes, date sample was submitted: .....

Water well disinfected?  Yes    No

**8 TYPE OF CASING USED:**  Steel    PVC    Other .....

Casing diameter ..... in. to ..... ft., Diameter ..... in. to ..... ft., Diameter ..... in. to ..... ft.  
Casing height above land surface ..... in.   Weight ..... lbs./ft.   Wall thickness or gauge No. ....

**CASING JOINTS:**  Glued    Clamped    Welded    Threaded

**TYPE OF SCREEN OR PERFORATION MATERIAL:**  
 Steel    Stainless Steel    PVC    Other (Specify) .....  
 Brass    Galvanized Steel    None used (open hole)

**SCREEN OR PERFORATION OPENINGS ARE:**  
 Continuous Slot    Mill Slot    Gauze Wrapped    Torch Cut    Drilled Holes    Other (Specify) .....  
 Louvered Shutter    Key Punched    Wire Wrapped    Saw Cut    None (Open Hole)

**SCREEN-PERFORATED INTERVALS:** From ..... ft. to ..... ft., From ..... ft. to ..... ft., From ..... ft. to ..... ft.  
**GRAVEL PACK INTERVALS:** From ..... ft. to ..... ft., From ..... ft. to ..... ft., From ..... ft. to ..... ft.

**9 GROUT MATERIAL:**  Neat cement    Cement grout    Bentonite    Other .....

Grout Intervals: From ..... ft. to ..... ft., From ..... ft. to ..... ft., From ..... ft. to ..... ft.

**Nearest source of possible contamination:**   No potential source of contamination within 200 ft.  
 Septic Tank    Lateral Lines    Pit Privy    Livestock Pens    Insecticide Storage  
 Sewer Lines    Cess Pool    Sewage Lagoon    Fuel Storage    Abandoned Water Well  
 Watertight Sewer Lines    Seepage Pit    Feedyard    Fertilizer Storage    Oil Well/Gas Well  
 Other (Specify) .....

Direction from well? .....   Distance from well? ..... ft.

10 FROM	TO	LITHOLOGIC LOG	FROM	TO	LITHO. LOG (cont.) or PLUGGING INTERVALS

**Notes:**

**11 CONTRACTOR'S OR LANDOWNER'S CERTIFICATION:** This water well was  constructed,  reconstructed, or  plugged under my jurisdiction and was completed on (mo-day-year) ..... and this record is true to the best of my knowledge and belief. Kansas Water Well Contractor's License No. .... This Water Well Record was completed on (mo-day-year) ..... under the business name of .....

W. 7th Avenue (Highway 54)

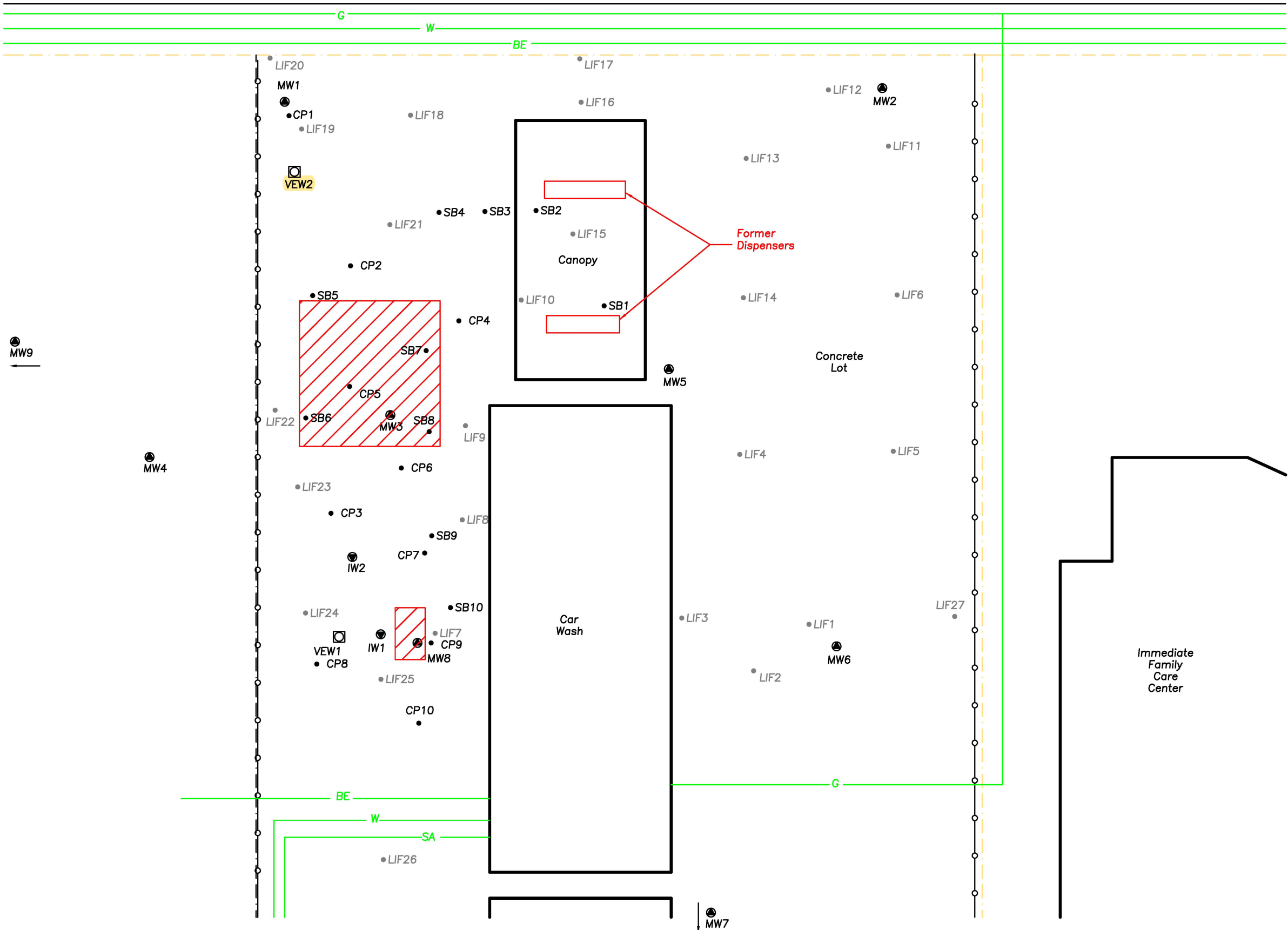

**Legend**

- MW1 - Monitoring Well Location  
"PMW" Wells Associated with Pemco #244
- ☐ VEW1 - Multi Phase Extraction Well
- - Air Sparge Well
- IW1 - Continuous Probe Location (CGP 2019)
- LIF1 - Laser Induced Fluorescence Probe (SCS 2017)
- SB1 - Soil Probe Location (SCS 2017)
- ▨ - Former UST
- - - - Property Line
- Clark - Property Owner Name
- OH- - Overhead Power Line
- SA- - Sanitary Sewer Line (~4' deep)
- FO- - Fiber Optic (~3' Deep)
- W- - Water Line (~4' deep)
- G- - Gas Line (~3' deep)
- BT- - Buried Telephone (~2' deep)
- ST- - Storm Sewer (Culvert) (~1' deep)
- pp● - Power Pole
- lp● - Light Pole
- MH● - Manhole
- Ped● - Phone Pedestal
- WM● - Water Meter
- FH● - Fire Hydrant
- CO● - Clean Out
- - Tree

Scale In Feet  
0 20 40

Site Detail Map  
 Moore Washes  
 Augusta, Kansas  
 KDHE Project Code: U2-008-13132  
 Remedial Design Report  
 CGP Project #18852K  
 Prepared By: MK Date: 04-06-2021  
 Reviewd By: MK Date: 04-06-2021  
 Figure 1.4  
 CGP, Inc. PO Box 23, Wahoo, NE 68066