

WATER WELL RECORD Form WWC-5

☒ Original Record ☐ Correction ☐ Change in Well Use

Division of Water
Resources App. No.

Well ID

NKMW 11S

1 LOCATION OF WATER WELL: County: Sedgwick	Fraction SW 1/4 SW 1/4 SW 1/4 NE 1/4	Section Number 6	Township Number T 28 S	Range Number R 1 E W
---	---	----------------------------	----------------------------------	--------------------------------

2 WELL OWNER: Last Name: Business: KDHE - BER Curtis State Office Building Address: 1000 SW Jackson St., Suite 410 City: Topeka State: KS ZIP: 66612-1367	First: Street or Rural Address where well is located (if unknown, distance and direction from nearest town or intersection): If at owner's address, check here: <input type="checkbox"/> KDHE - West Pawnee Site 2559 West Pawnee, Wichita, KS
---	---

3 LOCATE WELL WITH "X" IN SECTION BOX: N W E S 1 mile	4 DEPTH OF COMPLETED WELL: 20 ft. Depth(s) Groundwater Encountered: 1) 6 ft. 2) N/A ft. 3) N/A ft., or 4) <input type="checkbox"/> Dry Well WELL'S STATIC WATER LEVEL: 5.80 ft. <input checked="" type="checkbox"/> below land surface, measured on (mo-day-yr) 9-12-16 <input type="checkbox"/> above land surface, measured on (mo-day-yr) Pump test data: Well water was N/A ft. after N/A hours pumping N/A gpm Well water was N/A ft. after N/A hours pumping N/A gpm Estimated Yield: N/A gpm Bore Hole Diameter: 8.25 in. to 20 ft. and N/A in. to N/A ft.	5 Latitude: 37.64506 (decimal degrees) Longitude: -97.36115 (decimal degrees) Horizontal Datum: <input type="checkbox"/> WGS 84 <input checked="" type="checkbox"/> NAD 83 <input type="checkbox"/> NAD 27 Source for Latitude/Longitude: <input type="checkbox"/> GPS (unit make/model:) (WAAS enabled? <input type="checkbox"/> Yes <input type="checkbox"/> No) <input checked="" type="checkbox"/> Land Survey <input type="checkbox"/> Topographic Map <input type="checkbox"/> Online Mapper:
		6 Elevation: 1285.89 ft. <input checked="" type="checkbox"/> Ground Level <input type="checkbox"/> TOC Source: <input checked="" type="checkbox"/> Land Survey <input type="checkbox"/> GPS <input type="checkbox"/> Topographic Map <input type="checkbox"/> Other Top of manhole cover bolt

7 WELL WATER TO BE USED AS:		
1. Domestic: <input type="checkbox"/> Household <input type="checkbox"/> Lawn & Garden <input type="checkbox"/> Livestock	5. <input type="checkbox"/> Public Water Supply: well ID 6. <input type="checkbox"/> Dewatering: how many wells? 7. <input type="checkbox"/> Aquifer Recharge: well ID 8. <input checked="" type="checkbox"/> Monitoring: well ID NKMW-11S	10. <input type="checkbox"/> Oil Field Water Supply: lease 11. Test Hole: well ID <input type="checkbox"/> Cased <input type="checkbox"/> Uncased <input type="checkbox"/> Geotechnical
2. <input type="checkbox"/> Irrigation	9. Environmental Remediation: well ID <input type="checkbox"/> Air Sparge <input type="checkbox"/> Soil Vapor Extraction <input type="checkbox"/> Recovery <input type="checkbox"/> Injection	12. Geothermal: how many bores? a) Closed Loop <input type="checkbox"/> Horizontal <input type="checkbox"/> Vertical b) Open Loop <input type="checkbox"/> Surface Discharge <input type="checkbox"/> Inj. of Water
3. <input type="checkbox"/> Feedlot		13. <input type="checkbox"/> Other (specify):
4. <input type="checkbox"/> Industrial		

Was a chemical/bacteriological sample submitted to KDHE? ☐ Yes ☒ No If yes, date sample was submitted:

Water well disinfected? ☐ Yes ☒ No

8 TYPE OF CASING USED: ☐ Steel ☒ PVC ☐ Other CASING JOINTS: ☐ Glued ☐ Clamped ☐ Welded ☒ Threaded

Casing diameter 2 in. to 10 ft. Diameter N/A in. to N/A ft. Diameter N/A in. to N/A ft.

Casing height above land surface 0 in. Weight N/A lbs./ft. Wall thickness or gauge No. Sch. 40

TYPE OF SCREEN OR PERFORATION MATERIAL:

☐ Steel ☐ Stainless Steel ☐ Fiberglass ☒ PVC ☐ Other (Specify)

☐ Brass ☐ Galvanized Steel ☐ Concrete tile ☐ None used (open hole)

SCREEN OR PERFORATION OPENINGS ARE:

☐ Continuous Slot ☒ Mill Slot ☐ Gauze Wrapped ☐ Torch Cut ☐ Drilled Holes ☐ Other (Specify)

☐ Louvered Shutter ☐ Key Punched ☐ Wire Wrapped ☐ Saw Cut ☐ None (Open Hole)

SCREEN-PERFORATED INTERVALS: From 10 ft. to 20 ft., From N/A ft. to N/A ft., From N/A ft. to N/A ft.

GRAVEL PACK INTERVALS: From 8 ft. to 20 ft., From N/A ft. to N/A ft., From N/A ft. to N/A ft.

9 GROUT MATERIAL: ☐ Neat cement ☐ Cement grout ☒ Bentonite ☒ Other Concrete 0 to 2 feet

Grout Intervals: From 2 ft. to 8 ft., From N/A ft. to N/A ft., From N/A ft. to N/A ft.

Nearest source of possible contamination:

☐ Septic Tank ☐ Lateral Lines ☐ Pit Privy ☐ Livestock Pens ☐ Insecticide Storage

☐ Sewer Lines ☐ Cess Pool ☐ Sewage Lagoon ☐ Fuel Storage ☐ Abandoned Water Well

☐ Watertight Sewer Lines ☐ Seepage Pit ☐ Feedyard ☐ Fertilizer Storage ☐ Oil Well/Gas Well

☒ Other (Specify) Chlorinated solvents

Direction from well? Distance from well? ft.

10 FROM	TO	LITHOLOGIC LOG	FROM	TO	LITHO. LOG (cont.) or PLUGGING INTERVALS
0	1.5	Topsoil			
1.5	10	Silty Clay			
10	20	Sandy Clay			

Notes:

11 CONTRACTOR'S OR LANDOWNER'S CERTIFICATION: This water well was ☒ constructed, ☐ reconstructed, or ☐ plugged under my jurisdiction and was completed on (mo-day-year) 8-31-2016 and this record is true to the best of my knowledge and belief. Kansas Water Well Contractor's License No. 759 This Water Well Record was completed on (mo-day-year) 10-26-2016 under the business name of RAZEK Environmental, LLC Signature

Burns & McDonnell
9400 Ward Parkway
Kansas City, MO 64114

October 6, 2016
Job # 16-09-240
Page 1 of 5

**SURVEYING OF MONITORING WELLS
KDHE - West Pawnee Site - 93671
2559 W. Pawnee
WICHITA, SEDGWICK COUNTY, KANSAS**

The above site is located in Section 1 of T28S, R1W & Sections 5 & 6 of T28S, R1E of the Sixth Principal Meridian, Sedgwick County, Kansas.

Horizontal Coordinates are in Nad83 State Plane Kansas South Zone 1502.
Coordinates are derived from the City of Wichita CORS Network.

Vertical Control #1: COW Brass Disk located in the East Right-of-Way of Meridian Ave. and the North Right-of-Way of 27th St. South NGVD29 Datum Elevation of 1287.02'....Utilizing NGS's "VERTCON" elevations were adjusted to NAVD88 Datum elevation of 1287.49'

Vertical Control #2: COW Brass Disk located on the Hubguard at the Southwest corner of the bridge over the Arkansas River on Pawnee Ave NGVD29 Datum Elevation of 1292.27'....Utilizing NGS's "VERTCON" elevations were adjusted to NAVD88 Datum elevation of 1292.74'

The coordinates and elevations for the requested wells are listed on the following page of this report.

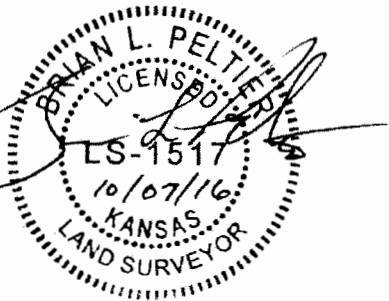

Brian L. Peltier
Kansas PS#1517

**SURVEYING OF MONITORING WELLS
KDHE - West Pawnee Site - 93671
2559 W. Pawnee
WICHITA, SEDGWICK COUNTY, KANSAS**

Well ID	NORTHING (NAD83 KS S) Latitude DD	EASTING (NAD83 KS S) Longitude DD	ELEV (NAVD88)	
NKMW-08D	1671071.43 N37.64639	1640869.41 W97.36524	1286.20 1286.58	TOC Bolt
NKMW-09S	1670779.09 N37.64559	1640901.11 W97.36514	1285.42 1285.96	TOC Bolt
NKMW-09D	1670774.99 N37.64558	1640903.39 W97.36513	1285.52 1285.93	TOC Bolt
NKMW-10S	1670794.20 N37.64564	1640545.69 W97.36637	1285.72 1286.09	TOC Bolt
NKMW-10D	1670789.33 N37.64563	1640545.84 W97.36637	1285.82 1286.10	TOC Bolt
NKMW-11S	1670600.35 N37.64506	1642058.59 W97.36115	1285.45 1285.89	TOC Bolt
NKMW-11D	1670600.03 N37.64506	1642055.16 W97.36116	1285.73 1286.01	TOC Bolt
NKMW-12D	1670362.50 N37.64441	1641901.91 W97.36170	1284.45 1284.88	TOC Bolt
NKMW-12S	1670367.21 N37.64442	1641901.88 W97.36170	1284.48 1284.88	TOC Bolt

Sec. 6 T28S R1E
Sec. 1 T28S R1W

DRAFT

Path: \\bmcd\dfs\Clients\ENV\KDH\93671_WestPawnee\GIS\Studies\Geospatial\ArcDocs\Figure4_4_Piezo_Shallow_Wells_Map_103.mxd
COPYRIGHT © 2015 BURNS & McDONNELL ENGINEERING COMPANY, INC.



Legend

- West Pawnee Monitoring Well
- Air Capitol Monitoring Well
- LUST Monitoring Well
- Ice Masters Monitoring Well
- Groundwater Flow Direction
- Piezometric Contour

0 250 500 Feet

N

Source: ESRI and Burns & McDonnell Engineering.

**BURNS
MCDONNELL**

Figure 4-4
Piezometric Surface Map (Shallow)
West Pawnee Site
ISL C2-087-73372
S. Meridian Ave & W. Pawnee Ave.
Wichita, Kansas