

☒ Original Record ☐ Correction ☐ Change in Well Use

Well ID

NKMW 6 S

[illegible]

Burns & McDonnell
9400 Ward Parkway
Kansas City, MO 64114

October 6, 2016

Job # 16-09-240

Page 1 of 5

**SURVEYING OF MONITORING WELLS
KDHE - West Pawnee Site - 93671
2559 W. Pawnee
WICHITA, SEDGWICK COUNTY, KANSAS**

The above site is located in Section 1 of T28S, R1W & Sections 5 & 6 of T28S, R1E of the Sixth Principal Meridian, Sedgwick County, Kansas.

Horizontal Coordinates are in Nad83 State Plane Kansas South Zone 1502.
Coordinates are derived from the City of Wichita CORS Network.

Vertical Control #1: COW Brass Disk located in the East Right-of-Way of Meridian Ave. and the North Right-of-Way of 27th St. South NGVD29 Datum Elevation of 1287.02'....Utilizing NGS's "VERTCON" elevations were adjusted to NAVD88 Datum elevation of 1287.49'

Vertical Control #2: COW Brass Disk located on the Hubguard at the Southwest corner of the bridge over the Arkansas River on Pawnee Ave NGVD29 Datum Elevation of 1292.27'....Utilizing NGS's "VERTCON" elevations were adjusted to NAVD88 Datum elevation of 1292.74'

The coordinates and elevations for the requested wells are listed on the following page of this report.

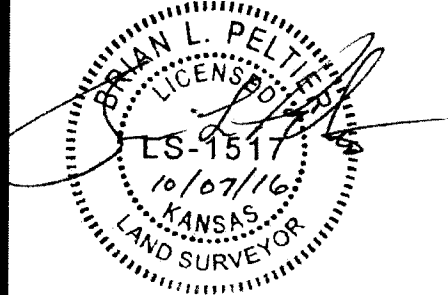

Brian L. Peltier
Kansas PS#1517



Burns & McDonnell
9400 Ward Parkway
Kansas City, MO 64114

October 6, 2016
Job # 16-09-240
Page 3 of 5

SURVEYING OF MONITORING WELLS
KDHE - West Pawnee Site - 93671
2559 W. Pawnee
WICHITA, SEDGWICK COUNTY, KANSAS

Well ID	NORTHING (NAD83 KS S) Latitude DD	EASTING (NAD83 KS S) Longitude DD	ELEV (NAVD88)	
NKMW-04S	1672074.76 N37.64918	1639837.66 W97.36876	1288.69 1289.06	TOC Bolt
NKMW-04D	1672074.93 N37.64918	1639842.52 W97.36874	1288.56 1288.96	TOC Bolt
NKMW-05S	1672037.73 N37.64909	1639638.21 W97.36945	1288.70 1289.00	TOC Hex Bolt
NKMW-05D	1672037.78 N37.64909	1639633.62 W97.36946	1288.66 1288.92	TOC Hex Bolt
NKMW-06S	1671271.63 N37.64693	1641180.74 W97.36415	1286.67 1286.99	TOC Bolt
NKMW-06D	1671268.92 N37.64692	1641182.44 W97.36415	1286.72 1287.01	TOC Bolt
NKMW-07S	1671021.53 N37.64625	1641051.65 W97.36461	1286.67 1287.07	TOC Bolt
NKMW-07D	1671019.35 N37.64624	1641054.20 W97.36460	1286.64 1287.08	TOC Bolt
NKMW-08S	1671075.81 N37.64640	1640869.03 W97.36524	1286.28 1286.56	TOC Bolt

Sec. 6 T28S R1E
Sec. 1 T28S R1W

DRAFT

Path: \\bmcd\dfs\Clients\ENV\KDH\93671_WestPawnee\GIS\Studies\Geospatial\ArcDocs\Figure4_4_Piezo_Shallow_Wells_Map_103.mxd
COPYRIGHT © 2015 BURNS & McDONNELL ENGINEERING COMPANY, INC.



Legend

- West Pawnee Monitoring Well
- Air Capitol Monitoring Well
- LUST Monitoring Well
- Ice Masters Monitoring Well

Groundwater Flow Direction

1281 Piezometric Contour

0 250 500 Feet

Source: ESRI and Burns & McDonnell Engineering.

**BURNS
MCDONNELL**

Figure 4-4
Piezometric Surface Map (Shallow)
West Pawnee Site
ISL C2-087-73372
S. Meridian Ave & W. Pawnee Ave.
Wichita, Kansas