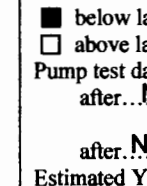

☒ Original Record    ☐ Correction    ☐ Change in Well Use

Well ID

<b>1 LOCATION OF WATER WELL:</b> County: Sedgwick		Fraction SW ¼ NW ¼ SE ¼ NW ¼	Section Number 6	Township Number T 28 S	Range Number R 1 E W
<b>2 WELL OWNER:</b> Last Name: _____ First: _____ Business: KDHE - BER Curtis State Office Building Address: 1000 SW Jackson St., Suite 410 City: Topeka State: KS ZIP: 66612-1367		Street or Rural Address where well is located (if unknown, distance and direction from nearest town or intersection): If at owner's address, check here: <input type="checkbox"/>  KDHE - West Pawnee Site 2559 West Pawnee, Wichita, KS			
<b>3 LOCATE WELL WITH "X" IN SECTION BOX:</b> N  S 1 mile	<b>4 DEPTH OF COMPLETED WELL:</b> ..... 20 ..... ft. Depth(s) Groundwater Encountered: 1) ..... 5 ..... ft. 2) N/A ..... ft. 3) N/A ..... ft., or 4) <input type="checkbox"/> Dry Well WELL'S STATIC WATER LEVEL: ..... 5.15 ..... ft. <input checked="" type="checkbox"/> below land surface, measured on (mo-day-yr) 9-12-16 <input type="checkbox"/> above land surface, measured on (mo-day-yr) Pump test data: Well water was N/A ..... ft. after N/A ..... hours pumping N/A ..... gpm Well water was N/A ..... ft. after N/A ..... hours pumping N/A ..... gpm Estimated Yield: N/A ..... gpm Bore Hole Diameter: 8.25 in. to 20 ft. and N/A in. to N/A ft.		<b>5 Latitude:</b> ..... 37.64640 ..... (decimal degrees) <b>Longitude:</b> ..... -97.36524 ..... (decimal degrees) <u>Horizontal Datum:</u> <input type="checkbox"/> WGS 84 <input checked="" type="checkbox"/> NAD 83 <input type="checkbox"/> NAD 27 <u>Source for Latitude/Longitude:</u> <input type="checkbox"/> GPS (unit make/model: ..... ) (WAAS enabled? <input type="checkbox"/> Yes <input type="checkbox"/> No) <input checked="" type="checkbox"/> Land Survey <input type="checkbox"/> Topographic Map <input type="checkbox"/> Online Mapper: .....		
	<b>6 Elevation:</b> 1286.56 ..... ft. <input checked="" type="checkbox"/> Ground Level <input type="checkbox"/> TOC <u>Source:</u> <input checked="" type="checkbox"/> Land Survey <input type="checkbox"/> GPS <input type="checkbox"/> Topographic Map <input type="checkbox"/> Other Top of manhole cover bolt .....				
<b>7 WELL WATER TO BE USED AS:</b> 1. Domestic: <input type="checkbox"/> Household <input type="checkbox"/> Lawn & Garden <input type="checkbox"/> Livestock 2. <input type="checkbox"/> Irrigation 3. <input type="checkbox"/> Feedlot 4. <input type="checkbox"/> Industrial 5. <input type="checkbox"/> Public Water Supply: well ID ..... 6. <input type="checkbox"/> Dewatering: how many wells? ..... 7. <input type="checkbox"/> Aquifer Recharge: well ID ..... 8. <input checked="" type="checkbox"/> Monitoring: well ID NKMW-8S 9. Environmental Remediation: well ID ..... <input type="checkbox"/> Air Sparge <input type="checkbox"/> Soil Vapor Extraction <input type="checkbox"/> Recovery <input type="checkbox"/> Injection 10. <input type="checkbox"/> Oil Field Water Supply: lease ..... 11. Test Hole: well ID ..... <input type="checkbox"/> Cased <input type="checkbox"/> Uncased <input type="checkbox"/> Geotechnical 12. Geothermal: how many bores? ..... a) Closed Loop <input type="checkbox"/> Horizontal <input type="checkbox"/> Vertical b) Open Loop <input type="checkbox"/> Surface Discharge <input type="checkbox"/> Inj. of Water 13. <input type="checkbox"/> Other (specify): .....					
Was a chemical/bacteriological sample submitted to KDHE? <input type="checkbox"/> Yes <input checked="" type="checkbox"/> No If yes, date sample was submitted: ..... Water well disinfected? <input type="checkbox"/> Yes <input checked="" type="checkbox"/> No					
<b>8 TYPE OF CASING USED:</b> <input type="checkbox"/> Steel <input checked="" type="checkbox"/> PVC <input type="checkbox"/> Other ..... CASING JOINTS: <input type="checkbox"/> Glued <input type="checkbox"/> Clamped <input type="checkbox"/> Welded <input checked="" type="checkbox"/> Threaded Casing diameter ..... 2 ..... in. to ..... 20 ..... ft., Diameter N/A ..... in. to N/A ..... ft., Diameter N/A ..... in. to N/A ..... ft. Casing height above land surface ..... 0 ..... in. Weight N/A ..... lbs./ft. Wall thickness or gauge No. Sch. 40 <b>TYPE OF SCREEN OR PERFORATION MATERIAL:</b> <input type="checkbox"/> Steel <input type="checkbox"/> Stainless Steel <input type="checkbox"/> Fiberglass <input checked="" type="checkbox"/> PVC <input type="checkbox"/> Other (Specify) ..... <input type="checkbox"/> Brass <input type="checkbox"/> Galvanized Steel <input type="checkbox"/> Concrete tile <input type="checkbox"/> None used (open hole) <b>SCREEN OR PERFORATION OPENINGS ARE:</b> <input type="checkbox"/> Continuous Slot <input checked="" type="checkbox"/> Mill Slot <input type="checkbox"/> Gauze Wrapped <input type="checkbox"/> Torch Cut <input type="checkbox"/> Drilled Holes <input type="checkbox"/> Other (Specify) ..... <input type="checkbox"/> Louvered Shutter <input type="checkbox"/> Key Punched <input type="checkbox"/> Wire Wrapped <input type="checkbox"/> Saw Cut <input type="checkbox"/> None (Open Hole) <b>SCREEN-PERFORATED INTERVALS:</b> From ..... 10 ..... ft. to ..... 20 ..... ft., From N/A ..... ft. to N/A ..... ft., From N/A ..... ft. to N/A ..... ft. <b>GRAVEL PACK INTERVALS:</b> From ..... 8 ..... ft. to ..... 20 ..... ft., From N/A ..... ft. to N/A ..... ft., From N/A ..... ft. to N/A ..... ft.					
<b>9 GROUT MATERIAL:</b> <input type="checkbox"/> Neat cement <input type="checkbox"/> Cement grout <input checked="" type="checkbox"/> Bentonite <input type="checkbox"/> Other Concrete 0 to 2 feet Grout Intervals: From ..... 2 ..... ft. to ..... 8 ..... ft., From N/A ..... ft. to N/A ..... ft., From N/A ..... ft. to N/A ..... ft. <b>Nearest source of possible contamination:</b> <input type="checkbox"/> Septic Tank <input type="checkbox"/> Lateral Lines <input type="checkbox"/> Pit Privy <input type="checkbox"/> Livestock Pens <input type="checkbox"/> Insecticide Storage <input type="checkbox"/> Sewer Lines <input type="checkbox"/> Cess Pool <input type="checkbox"/> Sewage Lagoon <input type="checkbox"/> Fuel Storage <input type="checkbox"/> Abandoned Water Well <input type="checkbox"/> Watertight Sewer Lines <input type="checkbox"/> Seepage Pit <input type="checkbox"/> Feedyard <input type="checkbox"/> Fertilizer Storage <input type="checkbox"/> Oil Well/Gas Well <input checked="" type="checkbox"/> Other (Specify) Chlorinated solvents ..... Direction from well? ..... Distance from well? ..... ft.					
<b>10 FROM TO LITHOLOGIC LOG</b> 0 2 Silt 2 9 Clay 9 20 Sand		<b>FROM TO LITHO. LOG (cont.) or PLUGGING INTERVALS</b>           Notes:			
<b>11 CONTRACTOR'S OR LANDOWNER'S CERTIFICATION:</b> This water well was <input checked="" type="checkbox"/> constructed, <input type="checkbox"/> reconstructed, or <input type="checkbox"/> plugged under my jurisdiction and was completed on (mo-day-year) 8-31-2016 ..... and this record is true to the best of my knowledge and belief. Kansas Water Well Contractor's License No. 759 ..... This Water Well Record was completed on (mo-day-year) 10-26-2016 ..... under the business name of RAZEK Environmental, LLC ..... Signature [Signature] Mail 1 white copy along with a fee of \$5.00 for each constructed well to: Kansas Department of Health and Environment, Bureau of Water, GWTS Section, 1000 SW Jackson St., Suite 420, Topeka, Kansas 66612-1367. Mail one to Water Well Owner and retain one for your records. Telephone 785-296-5524. Visit us at http://www.kdheks.gov/waterwell/index.html KSA 82a-1212 Revised 7/10/2015					

Burns & McDonnell  
9400 Ward Parkway  
Kansas City, MO 64114

October 6, 2016  
Job # 16-09-240  
Page 1 of 5

**SURVEYING OF MONITORING WELLS  
KDHE - West Pawnee Site - 93671  
2559 W. Pawnee  
WICHITA, SEDGWICK COUNTY, KANSAS**

The above site is located in Section 1 of T28S, R1W & Sections 5 & 6 of T28S, R1E of the Sixth Principal Meridian, Sedgwick County, Kansas.

Horizontal Coordinates are in Nad83 State Plane Kansas South Zone 1502.  
Coordinates are derived from the City of Wichita CORS Network.

Vertical Control #1: COW Brass Disk located in the East Right-of-Way of Meridian Ave. and the North Right-of-Way of 27th St. South NGVD29 Datum Elevation of 1287.02'....Utilizing NGS's "VERTCON" elevations were adjusted to NAVD88 Datum elevation of 1287.49'

Vertical Control #2: COW Brass Disk located on the Hubguard at the Southwest corner of the bridge over the Arkansas River on Pawnee Ave NGVD29 Datum Elevation of 1292.27'....Utilizing NGS's "VERTCON" elevations were adjusted to NAVD88 Datum elevation of 1292.74'

The coordinates and elevations for the requested wells are listed on the following page of this report.

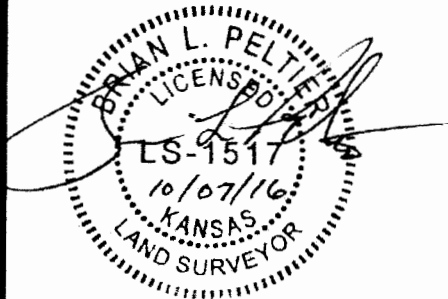

Brian L. Peltier  
Kansas PS#1517

**SURVEYING OF MONITORING WELLS  
KDHE - West Pawnee Site - 93671  
2559 W. Pawnee  
WICHITA, SEDGWICK COUNTY, KANSAS**

Well ID	NORTHING (NAD83 KS S)	EASTING (NAD83 KS S)	ELEV (NAVD88)	
	Latitude DD	Longitude DD		
NKMW-04S	1672074.76	1639837.66	1288.69	TOC
	N37.64918	W97.36876	1289.06	Bolt
NKMW-04D	1672074.93	1639842.52	1288.56	TOC
	N37.64918	W97.36874	1288.96	Bolt
NKMW-05S	1672037.73	1639638.21	1288.70	TOC
	N37.64909	W97.36945	1289.00	Hex Bolt
NKMW-05D	1672037.78	1639633.62	1288.66	TOC
	N37.64909	W97.36946	1288.92	Hex Bolt
NKMW-06S	1671271.63	1641180.74	1286.67	TOC
	N37.64693	W97.36415	1286.99	Bolt
NKMW-06D	1671268.92	1641182.44	1286.72	TOC
	N37.64692	W97.36415	1287.01	Bolt
NKMW-07S	1671021.53	1641051.65	1286.67	TOC
	N37.64625	W97.36461	1287.07	Bolt
NKMW-07D	1671019.35	1641054.20	1286.64	TOC
	N37.64624	W97.36460	1287.08	Bolt
NKMW-08S	1671075.81	1640869.03	1286.28	TOC
	N37.64640	W97.36524	1286.56	Bolt



Sec. 6 T28S R1E  
Sec. 1 T28S R1W

DRAFT

Path: \\bmcd\dfs\Clients\ENV\KDH\93671\_WestPawnee\GIS\Studies\Geospatial\ArcDocs\Figure4\_4\_Piezo\_Shallow\_Wells\_Map\_103.mxd  
COPYRIGHT © 2015 BURNS & McDONNELL ENGINEERING COMPANY, INC.



**Legend**

- West Pawnee Monitoring Well
- Air Capitol Monitoring Well
- LUST Monitoring Well
- Ice Masters Monitoring Well
- Groundwater Flow Direction
- Piezometric Contour

Figure 4-4  
Piezometric Surface Map (Shallow)  
West Pawnee Site  
ISL C2-087-73372  
S. Meridian Ave & W. Pawnee Ave.  
Wichita, Kansas

0 250 500 Feet

Source: ESRI and Burns & McDonnell Engineering.