

WATER WELL RECORD Form WWC-5

Division of Water Resources App. No.

Well ID

NKMW 02D

Original Record Correction Change in Well Use

1 LOCATION OF WATER WELL:
 County: **Sedwick** Fraction **NW 1/4 NW 1/4 NW 1/4 NW 1/4** Section Number **6** Township Number **T 28 S** Range Number **R 1 E**

2 WELL OWNER: Last Name: **Business: KDHE - BER Curtis State Office Building** First: **Address: 1000 SW Jackson St. Suite 410** Street or Rural Address where well is located (if unknown, distance and direction from nearest town or intersection): If at owner's address, check here:
Address: KDHE - West Pawnee Site, 2559 West Pawnee, Wichita, Ks.
 City: **Topeka** State: **KS** ZIP: **66612-1367**

3 LOCATE WELL WITH "X" IN SECTION BOX:
 N

X		
-- NW --	-- NE --	
W		E
-- SW --	-- SE --	
	S	

 S
 1 mile

4 DEPTH OF COMPLETED WELL: **48** ft.
 Depth(s) Groundwater Encountered: 1) ft.
 2) ft. 3) ft., or 4) Dry Well
 WELL'S STATIC WATER LEVEL: **7.42** ft.
 below land surface, measured on (mo-day-yr) **9-12-16**
 above land surface, measured on (mo-day-yr)
 Pump test data: Well water was ft.
 after hours pumping gpm
 Well water was ft.
 after hours pumping gpm
 Estimated Yield: gpm
 Bore Hole Diameter: **8.75** in. to ft. and
 in. to ft.

5 Latitude: **37.65058** (decimal degrees)
Longitude: **97.37073** (decimal degrees)
 Horizontal Datum: WGS 84 NAD 83 NAD 27
 Source for Latitude/Longitude:
 GPS (unit make/model:)
 (WAAS enabled? Yes No)
 Land Survey Topographic Map
 Online Mapper:
6 Elevation: **1289.56** ft. Ground Level TOC
 Source: Land Survey GPS Topographic Map
 Other

7 WELL WATER TO BE USED AS:

1. Domestic: <input type="checkbox"/> Household <input type="checkbox"/> Lawn & Garden <input type="checkbox"/> Livestock 2. <input type="checkbox"/> Irrigation 3. <input type="checkbox"/> Feedlot 4. <input type="checkbox"/> Industrial	5. <input type="checkbox"/> Public Water Supply: well ID 6. <input type="checkbox"/> Dewatering: how many wells? 7. <input type="checkbox"/> Aquifer Recharge: well ID 8. <input checked="" type="checkbox"/> Monitoring: well ID NKMW-02D 9. Environmental Remediation: well ID <input type="checkbox"/> Air Sparge <input type="checkbox"/> Soil Vapor Extraction <input type="checkbox"/> Recovery <input type="checkbox"/> Injection	10. <input type="checkbox"/> Oil Field Water Supply: lease 11. Test Hole: well ID <input type="checkbox"/> Cased <input type="checkbox"/> Uncased <input type="checkbox"/> Geotechnical 12. Geothermal: how many bores? a) Closed Loop <input type="checkbox"/> Horizontal <input type="checkbox"/> Vertical b) Open Loop <input type="checkbox"/> Surface Discharge <input type="checkbox"/> Inj. of Water 13. <input type="checkbox"/> Other (specify):
---	---	---

Was a chemical/bacteriological sample submitted to KDHE? Yes No If yes, date sample was submitted:

Water well disinfected? Yes No

8 TYPE OF CASING USED: Steel PVC Other CASING JOINTS: Glued Clamped Welded Threaded
 Casing diameter **2** in. to **35.76** ft., Diameter in. to ft., Diameter in. to ft.
 Casing height above land surface **0** in. Weight lbs./ft. Wall thickness or gauge No. **sch 40**

TYPE OF SCREEN OR PERFORATION MATERIAL:
 Steel Stainless Steel Fiberglass PVC Other (Specify)
 Brass Galvanized Steel Concrete tile None used (open hole)

SCREEN OR PERFORATION OPENINGS ARE:
 Continuous Slot Mill Slot Gauze Wrapped Torch Cut Drilled Holes Other (Specify)
 Louvered Shutter Key Punched Wire Wrapped Saw Cut None (Open Hole)

SCREEN-PERFORATED INTERVALS: From **35.76** ft. to **45.76** ft., From ft. to ft., From ft. to ft.
 GRAVEL PACK INTERVALS: From **33** ft. to **48** ft., From ft. to ft., From ft. to ft.

9 GROUT MATERIAL: Neat cement Cement grout Bentonite Other
 Grout Intervals: From **0** ft. to **33** ft., From ft. to ft., From ft. to ft.

Nearest source of possible contamination:
 Septic Tank Lateral Lines Pit Privy Livestock Pens Insecticide Storage
 Sewer Lines Cess Pool Sewage Lagoon Fuel Storage Abandoned Water Well
 Watertight Sewer Lines Seepage Pit Feedyard Fertilizer Storage Oil Well/Gas Well
 Other (Specify)

Direction from well? Distance from well? ft.

10 FROM	TO	LITHOLOGIC LOG	FROM	TO	LITHO. LOG (cont.) or PLUGGING INTERVALS
0	8	Clay, brown-yellow brown, damp, stiff, plastic	47	48	Shale, dark olive gray, highly weathered
8	12	Clay, dark gray brown, silty, moist			
12	16	Sand, gray brown, fine, wet			
16	18	Sand, gray brown, fine to coarse, loose			
18	26	Sand, gray brown, fine to medium, wet			
26	40	Sand, dark gray brown, fine to coarse, wet			Notes:
40	47	Sand, gray brown, fine to medium, wet			

11 CONTRACTOR'S OR LANDOWNER'S CERTIFICATION: This water well was constructed, reconstructed, or plugged under my jurisdiction and was completed on (mo-day-year) **8-25-2016** and this record is true to the best of my knowledge and belief. Kansas Water Well Contractor's License No. **604** This Water Well Record was completed on (mo-day-year) **11/18/16** under the business name of **Environmental Priority Service, Inc.** Signature **T.A.A.M.A.**

Mail 1 white copy along with a fee of \$5.00 for each constructed well to: Kansas Department of Health and Environment, Bureau of Water, GWTS Section, 1000 SW Jackson St., Suite 420, Topeka, Kansas 66612-1367. Mail one to Water Well Owner and retain one for your records. Telephone 785-296-5524.
 Visit us at <http://www.kdheks.gov/waterwell/index.html> **KSA 82a-1212** **Revised 7/10/2015**

**SURVEYING OF MONITORING WELLS
KDHE - West Pawnee Site - 93671
2559 W. Pawnee
WICHITA, SEDGWICK COUNTY, KANSAS**

The above site is located in Section 1 of T28S, R1W & Sections 5 & 6 of T28S, R1E of the Sixth Principal Meridian, Sedgwick County, Kansas.

Horizontal Coordinates are in Nad83 State Plane Kansas South Zone 1502. Coordinates are derived from the City of Wichita CORS Network.

Vertical Control #1: COW Brass Disk located in the East Right-of-Way of Meridian Ave. and the North Right-of-Way of 27th St. South NGVD29 Datum Elevation of 1287.02'....Utilizing NGS's "VERTCON" elevations were adjusted to NAVD88 Datum elevation of 1287.49'

Vertical Control #2: COW Brass Disk located on the Hubguard at the Southwest corner of the bridge over the Arkansas River on Pawnee Ave NGVD29 Datum Elevation of 1292.27'....Utilizing NGS's "VERTCON" elevations were adjusted to NAVD88 Datum elevation of 1292.74'

The coordinates and elevations for the requested wells are listed on the following page of this report.

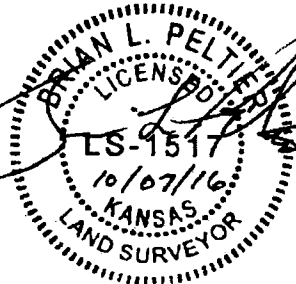

Brian L. Peltier
Kansas PS#1517



Burns & McDonnell
9400 Ward Parkway
Kansas City, MO 64114

October 6, 2016
Job # 16-09-240
Page 3 of 5

**SURVEYING OF MONITORING WELLS
KDHE - West Pawnee Site - 93671
2559 W. Pawnee
WICHITA, SEDGWICK COUNTY, KANSAS**

Well ID	NORTHING (NAD83 KS S) Latitude DD	EASTING (NAD83 KS S) Longitude DD	ELEV (NAVD88)	
NKMW-04S	1672074.76 N37.64918	1639837.66 W97.36876	1288.69 1289.06	TOC Bolt
NKMW-04D	1672074.93 N37.64918	1639842.52 W97.36874	1288.56 1288.96	TOC Bolt
NKMW-05S	1672037.73 N37.64909	1639638.21 W97.36945	1288.70 1289.00	TOC Hex Bolt
NKMW-05D	1672037.78 N37.64909	1639633.62 W97.36946	1288.66 1288.92	TOC Hex Bolt
NKMW-06S	1671271.63 N37.64693	1641180.74 W97.36415	1286.67 1286.99	TOC Bolt
NKMW-06D	1671268.92 N37.64692	1641182.44 W97.36415	1286.72 1287.01	TOC Bolt
NKMW-07S	1671021.53 N37.64625	1641051.65 W97.36461	1286.67 1287.07	TOC Bolt
NKMW-07D	1671019.35 N37.64624	1641054.20 W97.36460	1286.64 1287.08	TOC Bolt
NKMW-08S	1671075.81 N37.64640	1640869.03 W97.36524	1286.28 1286.56	TOC Bolt

Sec. 6 T28S R1E
Sec. 1 T28S R1W

DRAFT

Path: \\bmod\dfs\clients\EN\KDH\93671_WestPawnee\GIS\Studies\Geospatial\ArcDocs\Figure4_5_Piezo_Deep_Wells_Map_103.mxd
COPYRIGHT © 2015 BURNS & MCDONNELL ENGINEERING COMPANY, INC.



Legend

- West Pawnee Monitoring Well
- Air Capitol Monitoring Well
- LUST Monitoring Well
- Ice Masters Monitoring Well
- Groundwater Flow Direction
- Piezometric Contour

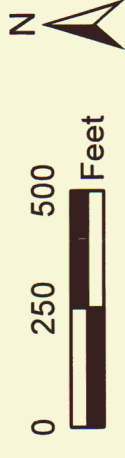

Source: ESRI and Burns & McDonnell Engineering.

Figure 4-5
Piezometric Surface Map (Deep)
West Pawnee Site
ISL C2-087-73372
S. Meridian Ave & W. Pawnee Ave.
Wichita, Kansas



Issued: October, 13 2016