

WATER WELL RECORD Form WWC-5

Division of Water Resources App. No.

Well ID

Original Record Correction Change in Well Use

1 LOCATION OF WATER WELL: County: _____	Fraction $\frac{1}{4}$ $\frac{1}{4}$ $\frac{1}{4}$ $\frac{1}{4}$	Section Number	Township Number T S	Range Number R <input type="checkbox"/> E <input type="checkbox"/> W
---	---	----------------	--------------------------	---

2 WELL OWNER: Last Name: _____ First: _____
 Business: _____
 Address: _____
 Address: _____
 City: _____ State: _____ ZIP: _____
 Street or Rural Address where well is located (if unknown, distance and direction from nearest town or intersection): If at owner's address, check here:

3 LOCATE WELL WITH "X" IN SECTION BOX:
N

W _____ E
 S
 -----1 mile-----

4 DEPTH OF COMPLETED WELL: _____ ft.
 Depth(s) Groundwater Encountered: 1) _____ ft.
 2) _____ ft. 3) _____ ft., or 4) Dry Well
WELL'S STATIC WATER LEVEL: _____ ft.
 below land surface, measured on (mo-day-yr).....
 above land surface, measured on (mo-day-yr).....
Pump test data: Well water was _____ ft.
 after..... hours pumping gpm
 Well water was _____ ft.
 after..... hours pumping gpm
Estimated Yield:gpm
Bore Hole Diameter: in. to ft. and
 in. to ft.

5 Latitude:(decimal degrees)
Longitude:(decimal degrees)
 Datum: WGS 84 NAD 83 NAD 27
Source for Latitude/Longitude:
 GPS (unit make/model:)
 (WAAS enabled? Yes No)
 Land Survey Topographic Map
 Online Mapper:

6 Elevation:ft. Ground Level TOC
Source: Land Survey GPS Topographic Map
 Other

7 WELL WATER TO BE USED AS:

1. <input type="checkbox"/> Domestic: <input type="checkbox"/> Household <input type="checkbox"/> Lawn & Garden <input type="checkbox"/> Livestock 2. <input type="checkbox"/> Irrigation 3. <input type="checkbox"/> Feedlot 4. <input type="checkbox"/> Industrial	5. <input type="checkbox"/> Public Water Supply: well ID	10. <input type="checkbox"/> Oil Field Water Supply: lease
6. <input type="checkbox"/> Dewatering: how many wells?	7. <input type="checkbox"/> Aquifer Recharge: well ID	11. Test Hole: well ID
8. <input type="checkbox"/> Monitoring: well ID	9. Environmental Remediation: well ID	12. Geothermal: how many bores?
<input type="checkbox"/> Air Sparge <input type="checkbox"/> Soil Vapor Extraction	<input type="checkbox"/> Recovery <input type="checkbox"/> Injection	a) Closed Loop <input type="checkbox"/> Horizontal <input type="checkbox"/> Vertical
		b) Open Loop <input type="checkbox"/> Surface Discharge <input type="checkbox"/> Inj. of Water
		13. <input type="checkbox"/> Other (specify):

Was a chemical/bacteriological sample submitted to KDHE? Yes No If yes, date sample was submitted:
 Water well disinfected? Yes No

8 TYPE OF CASING USED: Steel PVC Other **CASING JOINTS:** Glued Clamped Welded Threaded
 Casing diameter in. to ft., Diameter in. to ft., Diameter in. to ft.
 Casing height above land surface in. Weight lbs./ft. Wall thickness or gauge No.

TYPE OF SCREEN OR PERFORATION MATERIAL:
 Steel Stainless Steel PVC Other (Specify)
 Brass Galvanized Steel None used (open hole)

SCREEN OR PERFORATION OPENINGS ARE:
 Continuous Slot Mill Slot Gauze Wrapped Torch Cut Drilled Holes Other (Specify)
 Louvered Shutter Key Punched Wire Wrapped Saw Cut None (Open Hole)

SCREEN-PERFORATED INTERVALS: From ft. to ft., From ft. to ft., From ft. to ft.
GRAVEL PACK INTERVALS: From ft. to ft., From ft. to ft., From ft. to ft.

9 GROUT MATERIAL: Neat cement Cement grout Bentonite Other
 Grout Intervals: From ft. to ft., From ft. to ft., From ft. to ft.

Nearest source of possible contamination: No potential source of contamination within 200 ft.
 Septic Tank Lateral Lines Pit Privy Livestock Pens Insecticide Storage
 Sewer Lines Cess Pool Sewage Lagoon Fuel Storage Abandoned Water Well
 Watertight Sewer Lines Seepage Pit Feedyard Fertilizer Storage Oil Well/Gas Well
 Other (Specify)

Direction from well? Distance from well? ft.

10 FROM	TO	LITHOLOGIC LOG	FROM	TO	LITHO. LOG (cont.) or PLUGGING INTERVALS

Notes:

11 CONTRACTOR'S OR LANDOWNER'S CERTIFICATION: This water well was constructed, reconstructed, or plugged under my jurisdiction and was completed on (mo-day-year) and this record is true to the best of my knowledge and belief. Kansas Water Well Contractor's License No. This Water Well Record was completed on (mo-day-year) under the business name of



DESCRIPTION	NORTHING	EASTING	NORTH RIM ELEV	DISK
MW-01	1666553.21	1668377.86		1372.46
	1666552.73	1668377.79	1372.08	
MW-02	1666647.51	1668437.63		1373.79
	1666646.92	1668437.46	1373.36	
MW-03	1666459.12	1668528.66		1369.90
	1666458.67	1668528.55	1369.56	
MW-04	1666644.33	1668548.76		1374.39
	1666643.87	1668548.68	1373.95	
MW-05	1666558.24	1668551.62		1373.66
	1666557.74	1668551.58	1373.15	
MW-06	1666356.45	1668575.67		1369.53
	1666355.87	1668575.54	1369.11	
MW-07	1666618.42	1668643.61		1373.94
	1666617.89	1668643.57	1373.52	
MW-08	1666451.57	1668692.59		1369.83
	1666451.03	1668692.49	1369.34	
MW-09	1666606.49	1668716.17		1373.49
	1666605.94	1668716.04	1373.12	
MW-10	1666688.82	1668722.46		1373.77
	1666688.35	1668722.40	1373.36	
MW-11	1666304.22	1668787.09		1369.56
	1666303.66	1668786.94	1369.20	
MW-12	1666378.46	1668798.52		1370.09
	1666377.96	1668798.46	1369.64	
MW-13	1666244.04	1668929.71		1368.92
	1666243.56	1668929.68	1368.67	
MW-14	1666530.53	1668991.87		1370.38
	1666530.19	1668991.74	1369.86	
MW-15	1666617.59	1669009.17		1370.92
	1666617.05	1669009.12	1370.51	

SURVEYOR'S CERTIFICATION

I, Rodney R. Zinn, a duly licensed Land Surveyor in the State of Kansas, do hereby certify that this plat was prepared from the notes of an actual on the ground field survey done by me or under my direct supervision on August 25, 2020 and that the information shown hereon is true and correct and meets or exceeds current Kansas Minimum Standards for Boundary Surveys.

Rodney R. Zinn, L.S. No. 1559

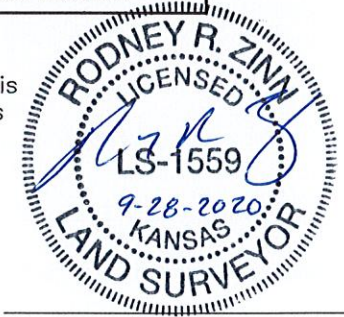

MONITORING WELL LOCATIONS
McCONNELL AFB
on KANSAS AIR NATIONAL GUARD PROPERTY
WICHITA, SEDGWICK COUNTY, KANSAS

DRAWN BY: ITZ	DATE: 8-25-2020	JOB NO. 1-1908292
CHECKED BY: RRZ	REVISION DATE: N/A	REF. JOB NO. N/A
PREPARED FOR: HydroGeoLogic Inc.		

CORNERSTONE
Regional Surveying, LLC
Serving Kansas, Missouri & Oklahoma
1921 North Penn, Independence, KS 67301 Ph:620-331-6767