

WATER WELL RECORD Form WWC-5

Original Record Correction Change in Well Use

Division of Water Resources App. No.

Well ID

1 LOCATION OF WATER WELL: County: Fraction 1/4 1/4 1/4 1/4 Section Number Township Number Range Number

2 WELL OWNER: Last Name: Business: Address: City: State: ZIP: Street or Rural Address where well is located

3 LOCATE WELL WITH 'X' IN SECTION BOX: N W E S 1 mile. 4 DEPTH OF COMPLETED WELL: Depth(s) Groundwater Encountered: WELL'S STATIC WATER LEVEL: Pump test data: Estimated Yield: Bore Hole Diameter:

5 Latitude: Longitude: Datum: Source for Latitude/Longitude: 6 Elevation: Source:

7 WELL WATER TO BE USED AS: 1. Domestic: 2. Irrigation: 3. Feedlot: 4. Industrial: 5. Public Water Supply: 6. Dewatering: 7. Aquifer Recharge: 8. Monitoring: 9. Environmental Remediation: 10. Oil Field Water Supply: 11. Test Hole: 12. Geothermal: 13. Other

Was a chemical/bacteriological sample submitted to KDHE? Water well disinfected?

8 TYPE OF CASING USED: CASING JOINTS: Casing diameter: Casing height above land surface: TYPE OF SCREEN OR PERFORATION MATERIAL: SCREEN OR PERFORATION OPENINGS ARE: SCREEN-PERFORATED INTERVALS: GRAVEL PACK INTERVALS:

9 GROUT MATERIAL: Grout Intervals: Nearest source of possible contamination: Direction from well? Distance from well?

Table with 6 columns: FROM, TO, LITHOLOGIC LOG, FROM, TO, LITHO. LOG (cont.) or PLUGGING INTERVALS. Includes a Notes section at the bottom.

11 CONTRACTOR'S OR LANDOWNER'S CERTIFICATION: This water well was constructed, reconstructed, or plugged under my jurisdiction and was completed on (mo-day-year) and this record is true to the best of my knowledge and belief.



DESCRIPTION	NORTHING	EASTING	NORTH RIM ELEV	DISK
MW-01	1666553.21	1668377.86		1372.46
	1666552.73	1668377.79	1372.08	
MW-02	1666647.51	1668437.63		1373.79
	1666646.92	1668437.46	1373.36	
MW-03	1666459.12	1668528.66		1369.90
	1666458.67	1668528.55	1369.56	
MW-04	1666644.33	1668548.76		1374.39
	1666643.87	1668548.68	1373.95	
MW-05	1666558.24	1668551.62		1373.66
	1666557.74	1668551.58	1373.15	
MW-06	1666356.45	1668575.67		1369.53
	1666355.87	1668575.54	1369.11	
MW-07	1666618.42	1668643.61		1373.94
	1666617.89	1668643.57	1373.52	
MW-08	1666451.57	1668692.59		1369.83
	1666451.03	1668692.49	1369.34	
MW-09	1666606.49	1668716.17		1373.49
	1666605.94	1668716.04	1373.12	
MW-10	1666688.82	1668722.46		1373.77
	1666688.35	1668722.40	1373.36	
MW-11	1666304.22	1668787.09		1369.56
	1666303.66	1668786.94	1369.20	
MW-12	1666378.46	1668798.52		1370.09
	1666377.96	1668798.46	1369.64	
MW-13	1666244.04	1668929.71		1368.92
	1666243.56	1668929.68	1368.67	
MW-14	1666530.53	1668991.87		1370.38
	1666530.19	1668991.74	1369.86	
MW-15	1666617.59	1669009.17		1370.92
	1666617.05	1669009.12	1370.51	

SURVEYOR'S CERTIFICATION

I, Rodney R. Zinn, a duly licensed Land Surveyor in the State of Kansas, do hereby certify that this plat was prepared from the notes of an actual on the ground field survey done by me or under my direct supervision on August 25, 2020 and that the information shown hereon is true and correct and meets or exceeds current Kansas Minimum Standards for Boundary Surveys.

Rodney R. Zinn, L.S. No. 1559

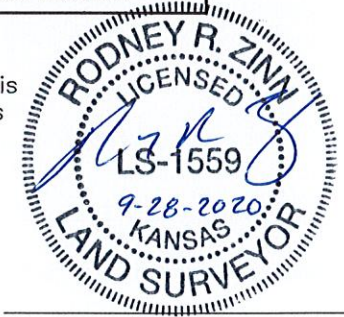

MONITORING WELL LOCATIONS
McCONNELL AFB
on KANSAS AIR NATIONAL GUARD PROPERTY
WICHITA, SEDGWICK COUNTY, KANSAS

DRAWN BY: ITZ	DATE: 8-25-2020	JOB NO. 1-1908292	REF. JOB NO. N/A
CHECKED BY: RRZ	REVISION DATE: N/A	PREPARED FOR: HydroGeoLogic Inc.	

CORNERSTONE
Regional Surveying, LLC
Serving Kansas, Missouri & Oklahoma
1921 North Penn, Independence, KS 67301 Ph:620-331-6767