



DESCRIPTION	NORTHING	EASTING	NORTH RIM ELEV	DISK
MW-01	1666553.21	1668377.86		1372.46
	1666552.73	1668377.79	1372.08	
MW-02	1666647.51	1668437.63		1373.79
	1666646.92	1668437.46	1373.36	
MW-03	1666459.12	1668528.66		1369.90
	1666458.67	1668528.55	1369.56	
MW-04	1666644.33	1668548.76		1374.39
	1666643.87	1668548.68	1373.95	
MW-05	1666558.24	1668551.62		1373.66
	1666557.74	1668551.58	1373.15	
MW-06	1666356.45	1668575.67		1369.53
	1666355.87	1668575.54	1369.11	
MW-07	1666618.42	1668643.61		1373.94
	1666617.89	1668643.57	1373.52	
MW-08	1666451.57	1668692.59		1369.83
	1666451.03	1668692.49	1369.34	
MW-09	1666606.49	1668716.17		1373.49
	1666605.94	1668716.04	1373.12	
MW-10	1666688.82	1668722.46		1373.77
	1666688.35	1668722.40	1373.36	
MW-11	1666304.22	1668787.09		1369.56
	1666303.66	1668786.94	1369.20	
MW-12	1666378.46	1668798.52		1370.09
	1666377.96	1668798.46	1369.64	
MW-13	1666244.04	1668929.71		1368.92
	1666243.56	1668929.68	1368.67	
MW-14	1666530.53	1668991.87		1370.38
	1666530.19	1668991.74	1369.86	
MW-15	1666617.59	1669009.17		1370.92
	1666617.05	1669009.12	1370.51	

SURVEYOR'S CERTIFICATION

I, Rodney R. Zinn, a duly licensed Land Surveyor in the State of Kansas, do hereby certify that this plat was prepared from the notes of an actual on the ground field survey done by me or under my direct supervision on August 25, 2020 and that the information shown hereon is true and correct and meets or exceeds current Kansas Minimum Standards for Boundary Surveys.

Rodney R. Zinn, L.S. No. 1559

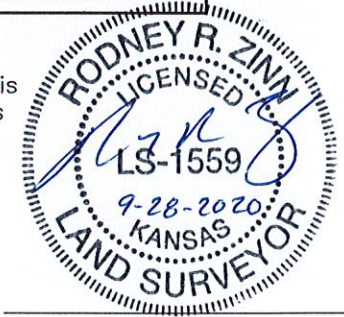

MONITORING WELL LOCATIONS
McCONNELL AFB
 on **KANSAS AIR NATIONAL GUARD PROPERTY**
WICHITA, SEDGWICK COUNTY, KANSAS

DRAWN BY: ITZ
 CHECKED BY: RRZ
 PREPARED FOR: HydroGeoLogic Inc.

DATE: 8-25-2020
 REVISION DATE: N/A

JOB NO. 1-1908292
 REF. JOB NO. N/A

CORNERSTONE
 Regional Surveying, LLC
 -Serving Kansas, Missouri & Oklahoma
 1921 North Penn, Independence, KS 67301 Ph:620-331-6767