







DESCRIPTION	NORTHING	EASTING	NORTH RIM ELEV	DISK
MW-01	1666553.21	1668377.86		1372.46
	1666552.73	1668377.79	1372.08	
MW-02	1666647.51	1668437.63		1373.79
	1666646.92	1668437.46	1373.36	
MW-03	1666459.12	1668528.66		1369.90
	1666458.67	1668528.55	1369.56	
MW-04	1666644.33	1668548.76		1374.39
	1666643.87	1668548.68	1373.95	
MW-05	1666558.24	1668551.62		1373.66
	1666557.74	1668551.58	1373.15	
MW-06	1666356.45	1668575.67		1369.53
	1666355.87	1668575.54	1369.11	
MW-07	1666618.42	1668643.61		1373.94
	1666617.89	1668643.57	1373.52	
MW-08	1666451.57	1668692.59		1369.83
	1666451.03	1668692.49	1369.34	
MW-09	1666606.49	1668716.17		1373.49
	1666605.94	1668716.04	1373.12	
MW-10	1666688.82	1668722.46		1373.77
	1666688.35	1668722.40	1373.36	
MW-11	1666304.22	1668787.09		1369.56
	1666303.66	1668786.94	1369.20	
MW-12	1666378.46	1668798.52		1370.09
	1666377.96	1668798.46	1369.64	
MW-13	1666244.04	1668929.71		1368.92
	1666243.56	1668929.68	1368.67	
MW-14	1666530.53	1668991.87		1370.38
	1666530.19	1668991.74	1369.86	
MW-15	1666617.59	1669009.17		1370.92
	1666617.05	1669009.12	1370.51	

**SURVEYOR'S CERTIFICATION**

I, Rodney R. Zinn, a duly licensed Land Surveyor in the State of Kansas, do hereby certify that this plat was prepared from the notes of an actual on the ground field survey done by me or under my direct supervision on August 25, 2020 and that the information shown hereon is true and correct and meets or exceeds current Kansas Minimum Standards for Boundary Surveys.

Rodney R. Zinn, L.S. No. 1559

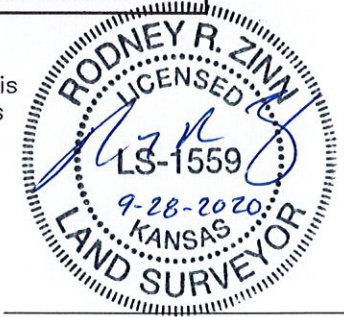

**LEGEND**

Ⓜ Monitoring Well

△ Control Point

⊕ TEMPORARY BENCHMARK

0                      60                      120

SCALE: 1" = 60'

**MONITORING WELL LOCATIONS**

**McCONNELL AFB**

**on KANSAS AIR NATIONAL GUARD PROPERTY**

**WICHITA, SEDGWICK COUNTY, KANSAS**

DRAWN BY: ITZ

CHECKED BY: RRZ

PREPARED FOR: HydroGeoLogic Inc.

JOB NO. 1-1908292

DATE: 8-25-2020

REVISION DATE: N/A

REF. JOB NO. N/A

CORNERSTONE

Regional Surveying, LLC

Serving Kansas, Missouri & Oklahoma

1921 North Penn, Independence, KS 67301 Ph:620-331-6767