

WATER WELL RECORD

Form WWC-5

Division of Water Resources App. No.

Well ID

MW10

Original Record Correction Change in Well Use

1 LOCATION OF WATER WELL: County Butler Fraction NW 1/4 NW 1/4 NW 1/4 Section Number 32 Township Number T 28 S Range Number R 3 E W

2 WELL OWNER: Last Name: Le Business: Address: 2520 N Brandon Circle City: Wichita State: KS ZIP: 67226

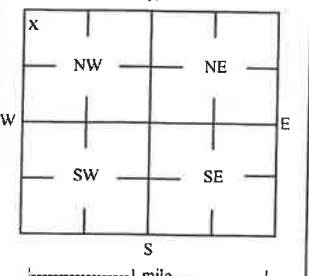

4 DEPTH OF COMPLETED WELL: 33.75 ft Depth(s) Groundwater Encountered: 1) ft 2) ft 3) ft or 4) Dry Well

WELL'S STATIC WATER LEVEL: 21.6 ft. below land surface, measured on (mo-day-yr) 9/7/2022

5 Latitude: 37.57751 (decimal degrees) Longitude: 97.13509 (decimal degrees) Horizontal Datum: WGS 84 X NAD 83 NAD 27

6 Elevation 1217.23 ft Ground Level X TOC Source X Land Survey GPS Topographic Map Other

7 WELL WATER TO BE USED AS: 1 Domestic: Household Lawn & Garden Livestock Irrigation Feedlot Industrial

Was a chemical/bacteriological sample submitted to KDHE? Yes No If yes, date sample was submitted:

8 TYPE OF CASING USED: Steel PVC Other CASING JOINTS: Glued Clamped Welded Threaded

TYPE OF SCREEN OR PERFORATION MATERIAL: Steel Stainless Steel Fiberglass PVC Other (Specify)

SCREEN OR PERFORATION OPENINGS ARE: Continuous Slot Mill Slot Gauze Wrapped Torch Cut Drilled Holes

SCREEN-PERFORATED INTERVALS: From 13.75 ft. to 33.75 ft. GRAVEL PACK INTERVALS: From 11.75 ft. to 33.75 ft.

9 GROUT MATERIAL: Neat cement Cement grout Bentonite Other Concrete: 0-0.5'

Nearest source of possible contamination: Septic Tank Lateral Lines Pit Privy Livestock Pens Insecticide Storage

Direction from well? E Distance from well? ~50 ft

Table with columns: FROM, TO, LITHOLOGIC LOG, FROM, TO, LITHO. LOG (cont.) or PLUGGING INTERVALS

Notes: KDHE ID: K & O Quickshop #26; U2-008-14508 Target of monitoring well is shallow groundwater, <20' of grout was installed at the direction of KDHE.

11 CONTRACTOR'S OR LANDOWNER'S CERTIFICATION: This water well was constructed, reconstructed, or plugged under my jurisdiction and was completed on (mo-day-year) 9/7/22

NOTE: Figures exhibited within this report are only to be used within the context of this report. Placement of property lines, wells, structures, and roads is based on the available information from county appraiser maps, surveys, site visits, and/or previous vendor reports and should be considered approximate.

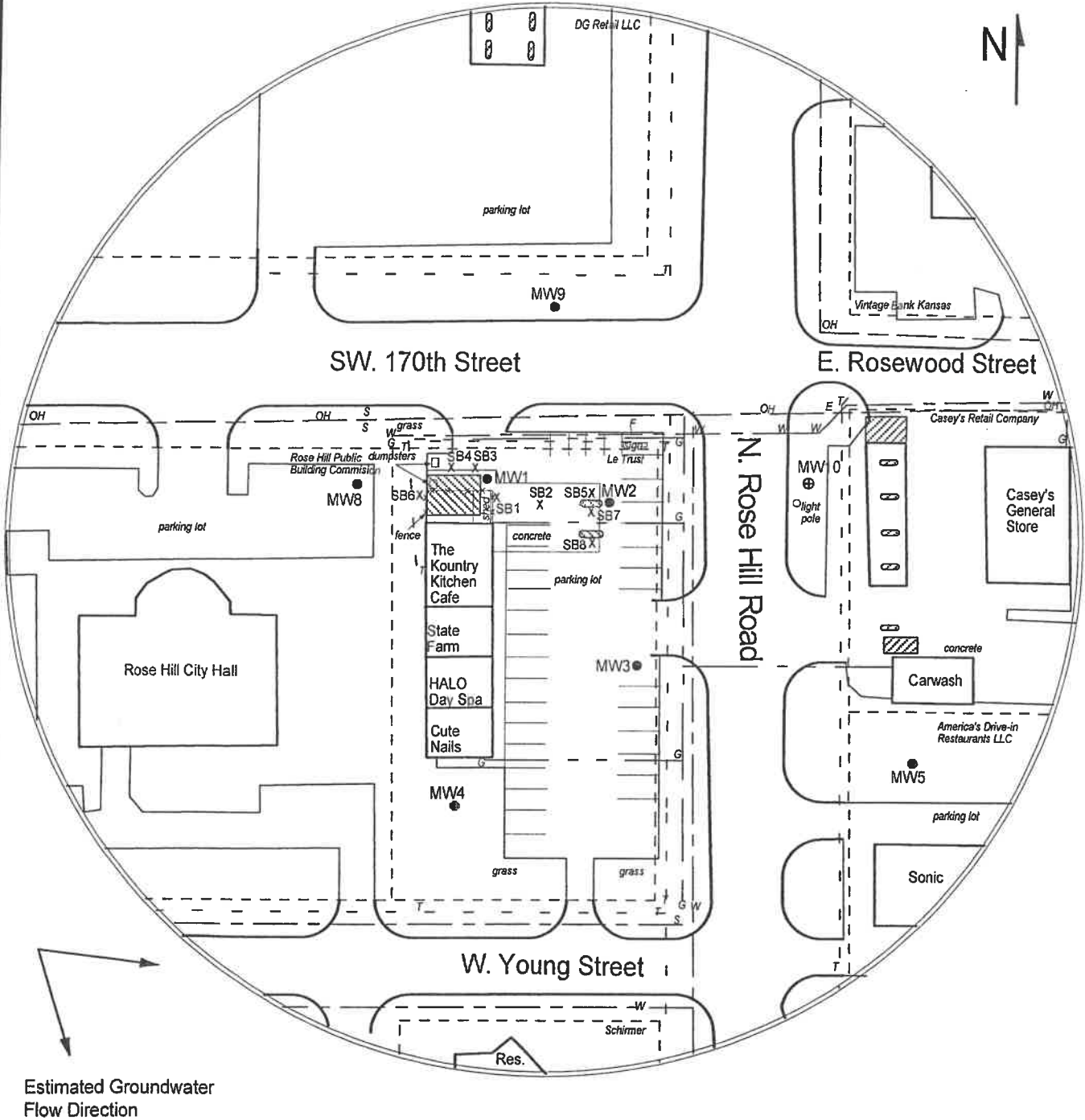

FIGURE 2.1 - 350 FT RADIUS AREA BASE MAP



PROJECT:
 K & O Quickshop #26
 1313 North Rose Hill Rd
 Rose Hill, KS
 KDHE ID: U2-008-14508
 Date: 9/7/22

1311 E 25th St. Suite B 785-841-8707 office
 Lawrence, KS 66046 785-865-4282 fax



LEGEND:

- Approximate Location of Former UST Basin & Pump Islands
- Approximate Location of Active UST Basin & Pump Islands
- Building with Basement
- Approximate Location of Property Line
- Existing Monitoring Well
- New Monitoring Well (Installed 9/7/22)
- Soil Boring (Drilled 9/6/22)
- Fire Hydrant
- Gas Lines (1.5 - 3 ft bgs)
- Overhead Lines (25'-40' high)
- Sewer Lines (2 - 6 ft bgs)
- Telephone Lines (2 - 6 ft bgs)
- Water Lines (1.5 - 3 ft bgs)

NOTE: Approximate location of product lines is unknown.
 NOTE: Utility depths, heights and locations are approximate.

SMH CONSULTANTS

September 26, 2022

Larsen & Associates
Jessica Chapman
1311 E 25th Street, Suite B
Lawrence, KS 66046

RE: Project No. 2209-0354

Jessica,

The following is the information requested on a Monitoring Well Site, K & O Quickshop #26, Rose Hill, Butler County, Kansas.

Point	North Coord.	East Coord.	Distance SE Cor. North	From S.31 West	Elev. Top Of Rim or PK Nail	Elev. Top of PVC Pipe	Latitude North	Longitude West
SE Corner S.31-T28S-R3E	10000	10000						
MW10	15250.72	10002.73	5250.72	2.73 East	1217.65	1217.23	37.57751	97.13509
Site BM	15210.23	9923.02	5210.23	76.98		SBM Elevation = 1315.63		

Description: "+" cut on top of curb inlet south of southwest curb return at intersection of Rosewood and Rose Hill Road.

MW10 is in the: NW¼ NW¼ NW¼ NW¼ S.32-T28S-R3E

If you have any questions, please do not hesitate in giving us a call.

Sincerely,



Tim Sloan, L.S.
SMH CONSULTANTS