

WATER WELL RECORD

Form WWC-5

Division of Water Resources App. No.

Well ID

MW10

Original Record Correction Change in Well Use

1 LOCATION OF WATER WELL: County Wilson Fraction NE 1/4 NE 1/4 SE 1/4 NE 1/4 Section Number 11 Township Number T 29 S Range Number R 14 E W

2 WELL OWNER: Last Name: Business: KDHE (Pete's #50) Address: 1000 SW Jackson Blvd City Topeka State: KS ZIP: 66612 Street or Rural Address where well is located (if unknown, distance and direction from nearest town or intersection): 933 North 2nd St, Fredonia, KS

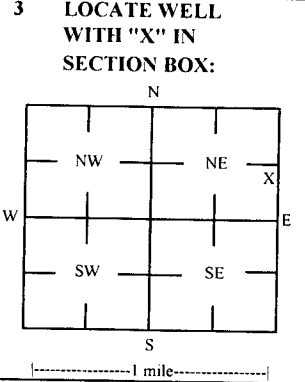

4 DEPTH OF COMPLETED WELL: 20.5 ft Depth(s) Groundwater Encountered: 1) 20.5 ft 2) 3) 4) Dry Well WELL'S STATIC WATER LEVEL: 5.10 ft. X below land surface, measured on (mo-day-yr) 7/13/22

5 Latitude: 37.54028 (decimal degrees) Longitude: 95.83372 (decimal degrees) Horizontal Datum X WGS 84 NAD 83 NAD 27 Source for Latitude/Longitude: GPS (unit make/model) Land Survey X Topographic Map Online Mapper

6 Elevation 865.07 ft Ground Level X TOC Source X Land Survey GPS Topographic Map Other

7 WELL WATER TO BE USED AS: 1 Domestic: Household Lawn & Garden Livestock Irrigation Feedlot Industrial 5 Public Water Supply: well ID 6 Dewatering: how many wells? 7 Aquifer Recharge: well ID 8 X Monitoring: well ID MW10 9 Environmental Remediation: well ID Air Sparge Soil Vapor Extractor Recovery Injection 10 Oil Field Water Supply: lease 11 Test Hole: well ID Cased Uncased Geotechnical 12 Geothermal: How many bores? a) Closed Loop Horizontal Vertical b) Open Loop Surface Discharge Inj. of Water Other (specify):

Was a chemical/bacteriological sample submitted to KDHE? Yes No X No If yes, date sample was submitted:

8 TYPE OF CASING USED: Steel PVC X Other CASING JOINTS: Glued Clamped Welded X Threaded Casing diameter 2 in. to 5.5 ft. Diameter in. to ft. Diameter in. to ft. Casing height above land surface -0.47 in. Weight lbs./ft. Well thickness or gauge No TYPE OF SCREEN OR PERFORATION MATERIAL: Steel Stainless Steel Fiberglass X PVC Brass Galvanized Steel Concrete tile None used (open hole) SCREEN OR PERFORATION OPENINGS ARE: Continuous Slot X Mill Slot Gauze Wrapped Torch Cut Drilled Holes Other (Specify) Louvered Shutter Key Punched Wire Wrapped Saw Cut None (Open Hole) SCREEN-PERFORATED INTERVALS: From 5.5 ft. to 20.5 ft. From ft. to ft. From ft. to ft. GRAVEL PACK INTERVALS: From 3.5 ft. to 20.5 ft. From ft. to ft. From ft. to ft.

9 GROUT MATERIAL: Neat cement Cement grout X Bentonite X Other Concrete: 0-1' Grout intervals: From 1 ft. to 3.5 ft. From ft. to ft. From ft. to ft.

Nearest source of possible contamination: Septic Tank Lateral Lines Pit Privy Livestock Pens Insecticide Storage Sewer Lines Cess Pool Sewage Lagoon Fuel Storage X Abandoned Water Well Watertight Sewer Lines Seepage Pit Feedyard Fertilizer Storage Oil Well / Gas Well Other (Specify) Direction from well? N Distance from well? ~80 ft

Table with columns: 10 FROM, TO, LITHOLOGIC LOG, FROM, TO, LITHO. LOG (cont.) or PLUGGING INTERVALS. Rows: 0-1 Gravel, 1-15 Clay, 15-20.5 Shale.

Notes: KDHE ID: Pete's #50; U3-103-15140 Target of monitoring well is shallow groundwater, <20' of grout was installed at the direction of KDHE.

11 CONTRACTOR'S OR LANDOWNER'S CERTIFICATION: This water well was X constructed, reconstructed, or plugged under my jurisdiction and was completed on (mo-day-yr) 7/12/22 and this record is true to the best of my knowledge and belief. Kansas Water Well Contractor's License No 757 This Water Well Record was completed on (mo-day-yr) 8/2/22 under the business name of Larsen & Associates, Inc. Signature

11-29-14E

# DENNIS L HANDKE

1820 NW 59th Terrace  
TOPEKA, KANSAS 66618  
785-286-4047 Home

Jess Chapman  
Larsen & Assoc.  
1311 E. 25<sup>th</sup> St., Suite B  
Lawrence, Kansas 66046

July 26, 2022

RE: Monitor Well Elevation Survey  
933 North 2<sup>nd</sup> St., Fredonia, Kansas

Proj. 22-00LL  
Pete's #50  
KDHE ID U3-103-15140

Bench Mark: Chisled X on top of the EENE bolt of fire hydrant at the NW corner of property.  
Elev: 868.34      North 4080      West 295      (from SE Cor. Sec. 11-29-14E)

|       |          |        |            |                                   |
|-------|----------|--------|------------|-----------------------------------|
| MW-10 | rim      | 865.54 | North 3711 | NE1/4,NE1/4,SE1/4,NE1/4           |
|       | top pipe | 865.07 | West 151   | Lat = 37.54028    Long = 95.83372 |

Elevation derived from existing project. NAVD 88.

Lat & Long derived from Fredonia 7.5 Quad Map WGS84

If you have any questions, please feel free to call me. Thank you for the opportunity to be of service to you.

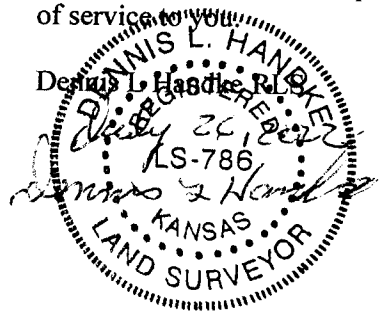

RECEIVED  
AUG 10 2022  
BUREAU OF WATER

Wilson

NOTE: Figures exhibited within this report are only to be used within the context of this report. Placement of property lines, wells, structures, and roads is based on the available information from county appraiser maps, surveys, site visits, and/or previous vendor reports and should be considered approximate.

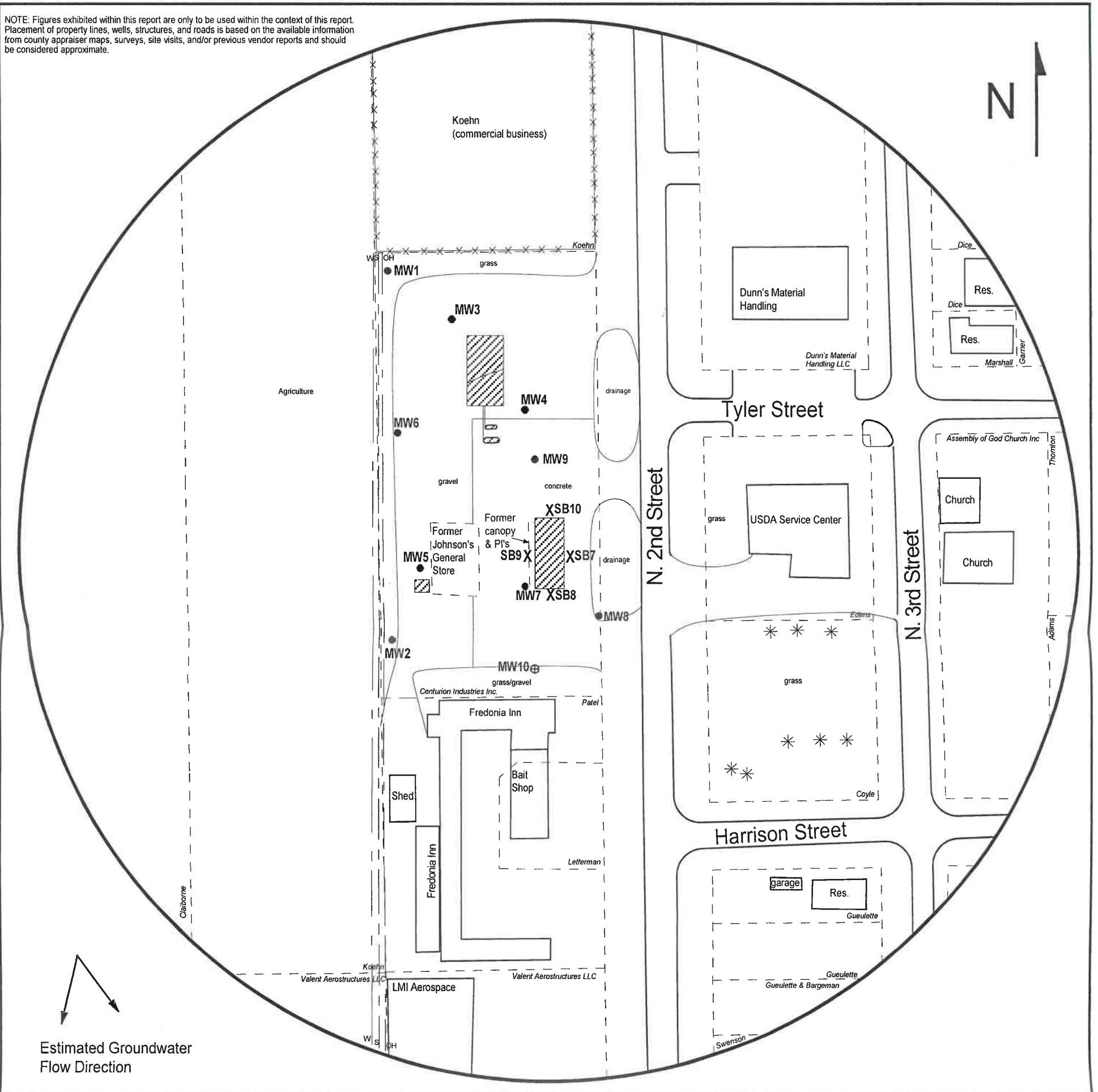

FIGURE 2.1 - 500 FT RADIUS AREA BASE MAP

LEGEND:

- Approximate Location of Former UST Basin and Pump Islands
- Building with Basement
- Existing Monitoring Well
- New Monitoring Well (Installed 7/12/22)
- Soil Boring (Drilled 7/12/22)
- Overhead Lines (25-40 ft high)
- Sewer Lines (2 - 6 ft BGS)
- Water Lines (2 - 6 ft BGS)



**PROJECT:**  
 Pete's #50  
 933 N 2nd St.  
 Fredonia, KS  
 KDHE ID: U3-103-15140  
 Date: 7/12-13/22

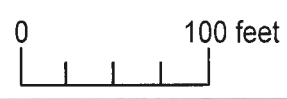

1311 E 25th St., Suite B (785) 841-8707 office  
 Lawrence, KS 66046 (785) 865-4282 fax

NOTE: Utility depths, heights and locations are approximate.

11-29-14E