

1 LOCATION OF WATER WELL: County: Sedgwick	Fraction NW ¼ NW ¼ NW ¼	Section Number 8	Township Number 29S	Range Number 2E
---	-----------------------------------	----------------------------	-------------------------------	---------------------------

Distance and direction from nearest town or city street address of well if located within city?
340 N. Rock Rd., Derby KS

2 WATER WELL OWNER: Casey's General Store RR#, St. Address, Box #: PO Box 3001 City, State, ZIP Code: Ankeny IA 50021-3001	Global Positioning System (decimal degrees, min. of 4 digits) Latitude: <u>NA</u> Longitude: <u>NA</u> Elevation: <u>NA</u> Datum: <u>NA</u> Data Collection Method: <u>NA</u>
---	--

3 MARK WELL'S LOCATON WITH AN "X" IN SECTION BOX:	4 DEPTH OF WELL <u>28.6</u> ft. MW2 WELL'S STATIC WATER LEVEL <u>NA</u> ft. WELL WAS USED AS: <table style="width: 100%; border: none;"> <tr> <td style="width: 33%;">1 Domestic</td> <td style="width: 33%;">5 Public Water Supply</td> <td style="width: 33%;">9 Dewatering</td> </tr> <tr> <td>2 Irrigation</td> <td>6 Oil Field Water Supply</td> <td><input checked="" type="radio"/> 10 Monitoring</td> </tr> <tr> <td>3 Feedlot</td> <td>7 Domestic (Lawn & Garden)</td> <td>11 Injection Well</td> </tr> <tr> <td>4 Industrial</td> <td>8 Air Conditioning</td> <td>12 Other _____</td> </tr> </table> <p>Was a chemical/bacteriological sample submitted to Department? Yes ___ No <u>X</u></p>	1 Domestic	5 Public Water Supply	9 Dewatering	2 Irrigation	6 Oil Field Water Supply	<input checked="" type="radio"/> 10 Monitoring	3 Feedlot	7 Domestic (Lawn & Garden)	11 Injection Well	4 Industrial	8 Air Conditioning	12 Other _____
1 Domestic	5 Public Water Supply	9 Dewatering											
2 Irrigation	6 Oil Field Water Supply	<input checked="" type="radio"/> 10 Monitoring											
3 Feedlot	7 Domestic (Lawn & Garden)	11 Injection Well											
4 Industrial	8 Air Conditioning	12 Other _____											

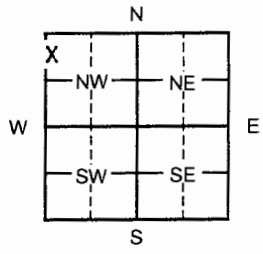

5 TYPE OF BLANK CASING USED:

1 Steel	3 RMP (SR)	5 Wrought	7 Fiberglass	9 Other (specify below)
<input checked="" type="radio"/> 2 PVC	4 ABS	6 Asbestos-Cement	8 Concrete Tile	_____

Blank casing diameter 2 in. Was casing pulled? Yes x No ___ If yes, how much 3'
Casing height above or below land surface NA in.

6 GROUT PLUG MATERIAL: 1 Neat cement 2 Cement grout 3 Bentonite 4 Other Asphalt: 0-0.3'; Soil: 0.3-3'

Grout Plug Intervals: From 3 ft. to 28.6 ft., From _____ ft. to _____ ft., From _____ ft. to _____ ft.

What is the nearest source of possible contamination:

1 Septic tank	6 Seepage pit	11 Fuel storage	16 Other (specify below)
2 Sewer lines	7 Pit privy	12 Fertilizer storage	_____
3 Watertight sewer lines	8 Sewage lagoon	13 Insecticide storage	_____
4 Lateral lines	9 Feedyard	14 Abandoned water well	Direction from well?
5 Cess pool	10 Livestock pens	15 Oil well/Gas well	How many feet?

FROM	TO	PLUGGING MATERIALS	FROM	TO	PLUGGING MATERIALS
0	0.3	Asphalt			
0.3	3	Soil			
3	28.6	Bentonite			

7 CONTRACTOR'S OR LANDOWNER'S CERTIFICATION: This water well was plugged under my jurisdiction and was completed on (mo/day/year) 9/2/14 and this record is true to the best of my knowledge and belief. Kansas Water Well Contractor's License No. 757. This Water Well Record was completed on (mo/day/year) 9/10/14 under the business name of Larsen and Associates, Inc. by (signature) _____

INSTRUCTIONS: Please fill in blanks or circle the correct answers. Send top three copies to Kansas Department of Health and Environment, Bureau of Water, Geology Section, 1000 SW Jackson St., Ste. 420, Topeka, Kansas 66612-1867. Telephone: 785/296-5522. Send one to Water Well Owner and retain one for your records. Visit us at <http://www.kdheks.gov/waterwell>.

NOTE: Figures exhibited within this report are only to be used within the context of this report. Placement of property lines, wells, structures, and roads is based on the available information from county appraiser maps, surveys, site visits, and/or previous vendor reports and should be considered approximate.

~~KS 500~~

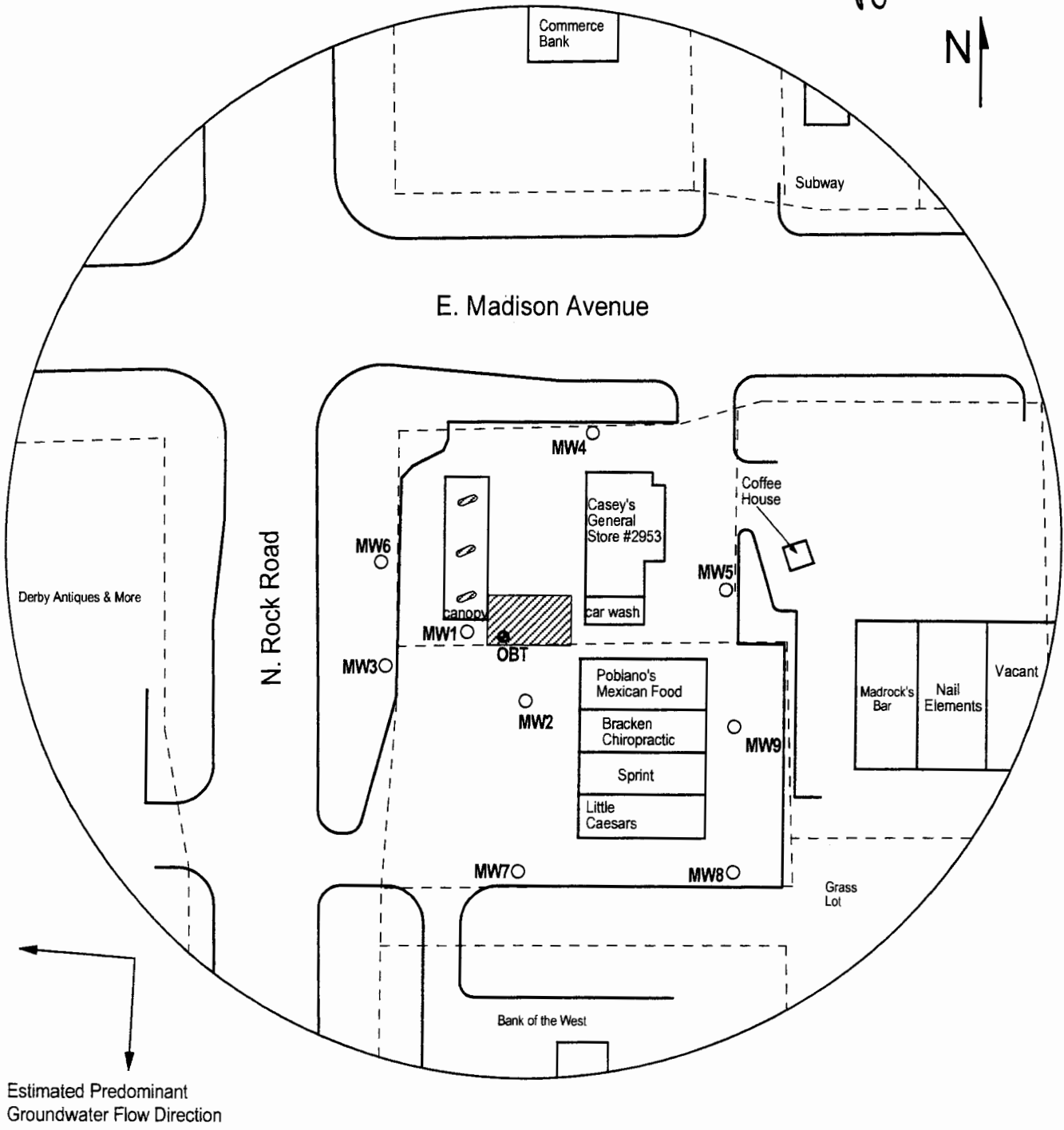

FIGURE 1 - 350 FT RADIUS AREA BASE MAP

LEGEND:

- Approximate Location of Active UST Basin and Pump Islands
- Observation Tube
- Plugged Monitoring Well
- Approximate Location of Property Lines



PROJECT:
 Casey's General Store #2953
 400 N. Rock Road
 Derby, KS
 KDHE ID: U2-087-14337
 Date: 9/2/14

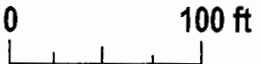

1311 E 25th St., Suite B (785) 841-8707 office
 Lawrence, KS 66046 (785) 865-4282 fax

Note: Location of product lines is unknown.