

<b>1 LOCATION OF WATER WELL:</b> County: <b>Sedgwick</b>	Fraction <b>NW ¼ NW ¼ NW ¼</b>	Section Number <b>8</b>	Township Number <b>29S</b>	Range Number <b>2E</b>
---	-----------------------------------	----------------------------	-------------------------------	---------------------------

Distance and direction from nearest town or city street address of well if located within city?

320 N. Rock Rd., Derby KS

**2 WATER WELL OWNER:** Casey's General Store

RR#, St. Address, Box #: PO Box 3001

City, State, ZIP Code: Ankeny IA 50021-3001

**Global Positioning System** (decimal degrees, min. of 4 digits)

Latitude: NA  
 Longitude: NA  
 Elevation: NA  
 Datum: NA  
 Data Collection Method: NA

**3 MARK WELL'S LOCATON WITH AN "X" IN SECTION BOX:**

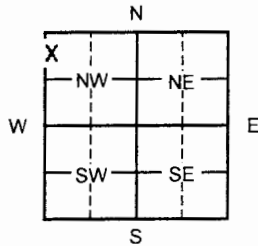

**4 DEPTH OF WELL** 29.6 ft. MW8

WELL'S STATIC WATER LEVEL NA ft.

WELL WAS USED AS:

- |              |                            |  |
|--------------|----------------------------|--|
| 1 Domestic   | 5 Public Water Supply      | 9 Dewatering                                   |
| 2 Irrigation | 6 Oil Field Water Supply   | <input checked="" type="radio"/> 10 Monitoring |
| 3 Feedlot    | 7 Domestic (Lawn & Garden) | 11 Injection Well                              |
| 4 Industrial | 8 Air Conditioning         | 12 Other _____                                 |

Was a chemical/bacteriological sample submitted to Department? Yes \_\_\_ No X

**5 TYPE OF BLANK CASING USED:**

- |  |            |                   |                 |                         |
|--|------------|-------------------|-----------------|-------------------------|
| 1 Steel                                | 3 RMP (SR) | 5 Wrought         | 7 Fiberglass    | 9 Other (specify below) |
| <input checked="" type="radio"/> 2 PVC | 4 ABS      | 6 Asbestos-Cement | 8 Concrete Tile | _____                   |

Blank casing diameter 2 in. Was casing pulled? Yes x No \_\_\_ If yes, how much 3'  
 Casing height above or below land surface NA in.

**6 GROUT PLUG MATERIAL:** 1 Neat cement 2 Cement grout  3 Bentonite  4 Other Asphalt: 0-0.3'; Soil: 0.3-3'

Grout Plug Intervals: From 3 ft. to 29.6 ft., From \_\_\_\_\_ ft. to \_\_\_\_\_ ft., From \_\_\_\_\_ ft. to \_\_\_\_\_ ft.

What is the nearest source of possible contamination:

- |                          |                   |                         |                          |
|--------------------------|-------------------|-------------------------|--------------------------|
| 1 Septic tank            | 6 Seepage pit     | 11 Fuel storage         | 16 Other (specify below) |
| 2 Sewer lines            | 7 Pit privy       | 12 Fertilizer storage   | _____                    |
| 3 Watertight sewer lines | 8 Sewage lagoon   | 13 Insecticide storage  |                          |
| 4 Lateral lines          | 9 Feedyard        | 14 Abandoned water well | Direction from well?     |
| 5 Cess pool              | 10 Livestock pens | 15 Oil well/Gas well    | How many feet?           |

FROM	TO	PLUGGING MATERIALS	FROM	TO	PLUGGING MATERIALS
0	0.3	Asphalt			
0.3	3	Soil			
3	29.6	Bentonite			

**7 CONTRACTOR'S OR LANDOWNER'S CERTIFICATION:** This water well was plugged under my jurisdiction and was completed on (mo/day/year) 9/2/14 and this record is true to the best of my knowledge and belief. Kansas Water Well Contractor's License No. 757. This Water Well Record was completed on (mo/day/year) 9/10/14 under the business name of Larsen and Associates, Inc. by (signature) \_\_\_\_\_

**INSTRUCTIONS:** Please fill in blanks or circle the correct answers. Send top three copies to Kansas Department of Health and Environment, Bureau of Water, Geology Section, 1000 SW Jackson St., Ste. 420, Topeka, Kansas 66612-3367. Telephone: 785/296-5522. Send one to Water Well Owner and retain one for your records. Visit us at <http://www.kdheks.gov/waterwell>.

NOTE: Figures exhibited within this report are only to be used within the context of this report. Placement of property lines, wells, structures, and roads is based on the available information from county appraiser maps, surveys, site visits, and/or previous vendor reports and should be considered approximate.

~~KCS copy~~

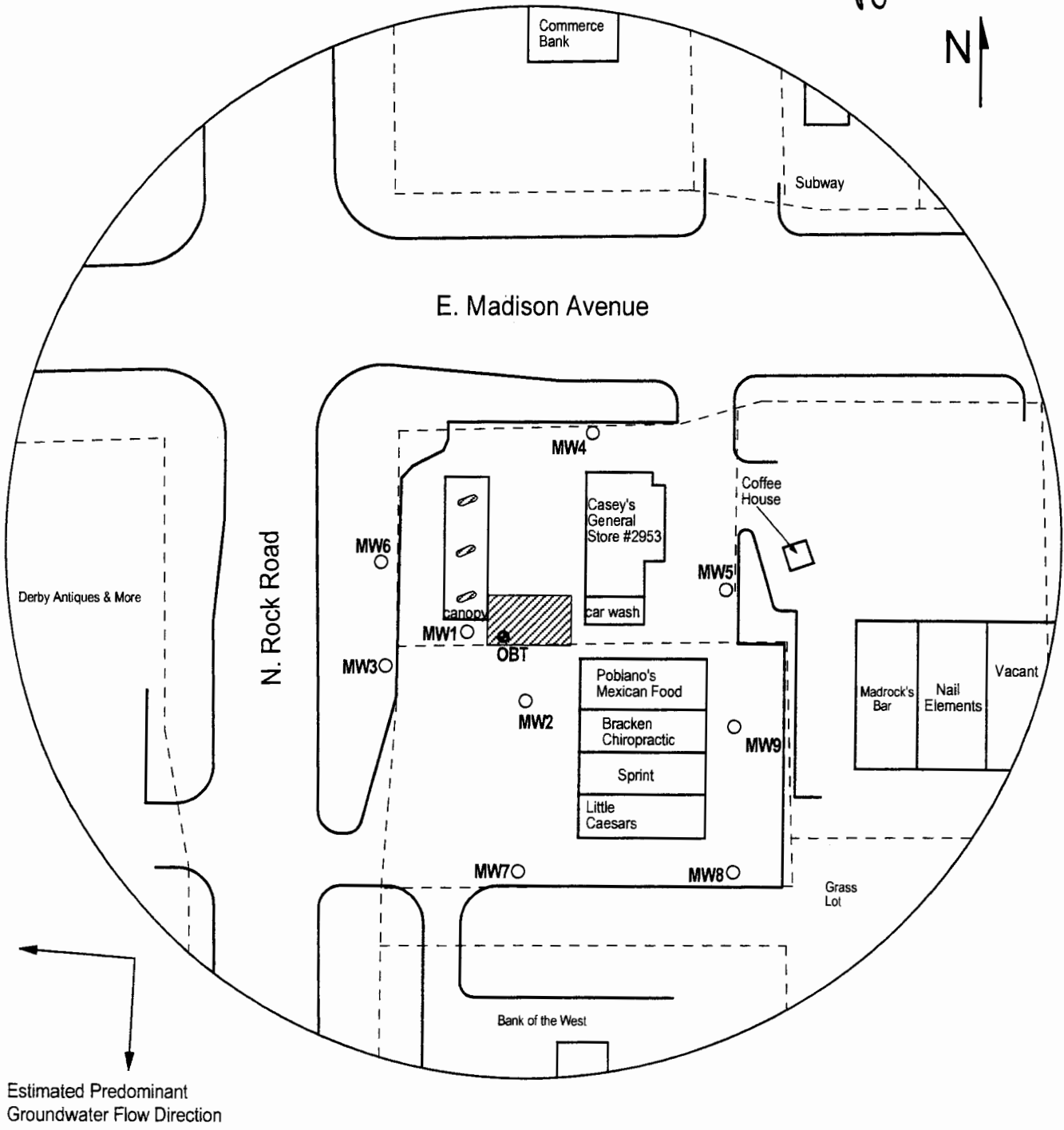





FIGURE 1 - 350 FT RADIUS AREA BASE MAP

**LEGEND:**

-  Approximate Location of Active UST Basin and Pump Islands
-  Observation Tube
-  Plugged Monitoring Well
-  Approximate Location of Property Lines



**PROJECT:**  
 Casey's General Store #2953  
 400 N. Rock Road  
 Derby, KS  
 KDHE ID: U2-087-14337  
 Date: 9/2/14

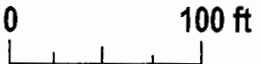

1311 E 25th St., Suite B (785) 841-8707 office  
 Lawrence, KS 66046 (785) 865-4282 fax

Note: Location of product lines is unknown.