

Constructed at 200

1 LOCATION OF WATER WELL: County: CRAWFORD Fraction NW 1/4 NW 1/4 NE 1/4 Section Number 12 Township Number T 29 S Range Number 23 [X] E [] W

Street/Rural Address of Well Location; if unknown, distance & direction from nearest town or intersection: If at owner's address, check here []

Global Positioning Systems (GPS) information: Latitude: 37.5425 (in decimal degrees) Longitude: -94.8423 (in decimal degrees) Elevation: Datum: [] WGS84, [] NAD83, [] NAD27 Collection Method:

2 WATER WELL OWNER: SHERYL CORRELL RR#, St. Address, Box #: 296 N. HWY 7 City, State ZIP Code: GIRARD, KS 66743

[X] GPS unit (Make/Model: MAGELLEN) [] Digital Map/Photo, [] Topographic Map, [] Land Survey Est. Accuracy: [] < 3 m, [] 3-5 m, [] 5-15 m, [] > 15 m

3 MARK WELL'S LOCATION WITH AN "X" IN SECTION BOX:

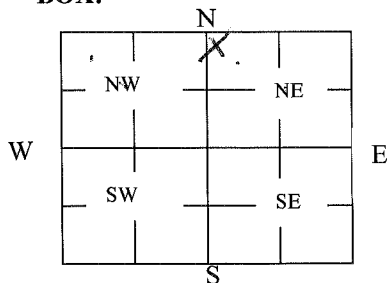

4 DEPTH OF WELL 280 ft.

WELL'S STATIC WATER LEVEL NA ft

WELL WAS USED AS:

- [] Domestic Irrigation Feedlot Industrial [] Public Water Supply Oil Field Water Supply Domestic (Lawn & Garden) Air Conditioning [] Dewatering Monitoring Injection Well [X] Other Geothermal

Was a chemical/bacteriological sample submitted to Department? Yes [] No [X]

5 TYPE OF BLANK CASING USED:

- [] Steel [] PVC [] RMP (SR) [] ABS [] Wrought [] Asbestos-Cement [] Fiberglass [] Concrete Tile [X] Other (Specify below) NA

Blank casing diameter in. Was casing pulled? Yes [] No [] If yes, how much Casing height above or below land surface in.

6 GROUT PLUG MATERIAL: [] Neat cement [] Cement grout [X] Bentonite [] Other

Grout Plug Intervals: From 0 ft. to 280 ft., From ft. to ft., From to ft.

What is the nearest source of possible contamination:

- [] Septic tank [] Sewer lines [] Watertight sewer lines [] Lateral lines [] Cess pool [] Seepage pit [] Pit privy [] Sewage lagoon [] Feedyard [] Livestock pens [] Fuel Storage [] Fertilizer storage [] Insecticide storage [] Abandoned water well [] Oil well/Gas well [X] Other (specify below) HOUSE Direction from well? NORTH How many feet? 12

Table with columns: FROM, TO, PLUGGING MATERIALS. Rows include: 0-3 BROWN CLAY, 3-5 WHITE ROCK, 5-8 RED CLAY, 8-15 WHITE ROCK, 15-90 BLUE SHALE, 90-110 WHITE ROCK, 110-115 BLUE SHALE, 115-125 WHITE ROCK, 125-130 BLUE SHALE, 130-135 SANDSTONE, 135-140 BROWN CLAY, 140-200 SANDSTONE, 200-220 BLUE SHALE, 220-225 COAL.

7 CONTRACTOR'S OR LANDOWNER'S CERTIFICATION: This water well was plugged under my jurisdiction and was completed on (mo/day/year) 9/29/11 and this record is true to the best of my knowledge and belief. Kansas Water Well Contractor's License No. 812. This Water Well Record was completed on (mo/day/year) 10/07/11 under the business name of Environmental Loop Service, Inc by (signature) Richard Moore

INSTRUCTIONS: Use typewriter or ballpoint pen. Please press firmly and print clearly. Please fill in blanks, underline or circle the correct answers. Send top three copies to Kansas Department of Health and Environment, Bureau of Water, Geology Section, 1000 SW Jackson St., Ste. 420, Topeka, Kansas 66612-1367. Telephone: 785/296-5524. Send one to Water Well Owner and retain one for your records. Visit us at http://www.kdheks.gov/waterwell/index.html.

Check one: [X] White Copy [] Blue Copy [] Pink Copy

Continued

Page 1

WATER WELL PLUGGING RECORD Form WWC-5P KSA 82a-1212 ID NO.

1 LOCATION OF WATER WELL: Fraction NW 1/4 NW 1/4 NE 1/4 1/4 Section Number 12 Township Number T 29 S Range Number 23 E W
 County: CRAWFORD

Street/Rural Address of Well Location; if unknown, distance & direction from nearest town or intersection: If at owner's address, check here

Global Positioning Systems (GPS) information:
 Latitude: 37.5425 (in decimal degrees)
 Longitude: -94.8423 (in decimal degrees)
 Elevation: _____
 Datum: WGS84, NAD83, NAD27
 Collection Method:
 GPS unit (Make/Model: MAGELLEN)
 Digital Map/Photo, Topographic Map, Land Survey
 Est. Accuracy: < 3 m, 3-5 m, 5-15 m, > 15 m

2 WATER WELL OWNER: SHERYL CORRELL
 RR#, St. Address, Box #: 296 N. HWY 7
 City, State ZIP Code: GIRARD, KS 66743

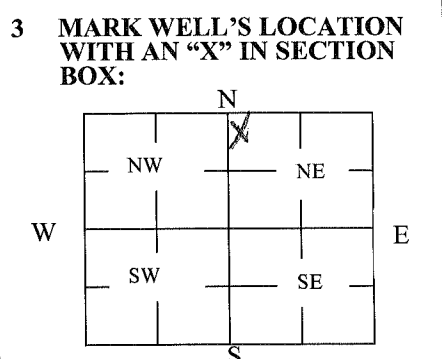

4 DEPTH OF WELL 280 ft.
 WELL'S STATIC WATER LEVEL NA ft
 WELL WAS USED AS:
 Domestic Public Water Supply Dewatering
 Irrigation Oil Field Water Supply Monitoring
 Feedlot Domestic (Lawn & Garden) Injection Well
 Industrial Air Conditioning Other Geothermal
 Was a chemical/bacteriological sample submitted to Department? Yes No

5 TYPE OF BLANK CASING USED:
 Steel RMP (SR) Wrought Fiberglass Other (Specify below)
 PVC ABS Asbestos-Cement Concrete Tile NA
 Blank casing diameter _____ in. Was casing pulled? Yes No If yes, how much _____
 Casing height above or below land surface _____ in.

6 GROUT PLUG MATERIAL: Neat cement Cement grout Bentonite Other _____
 Grout Plug Intervals: From 6 ft. to 280 ft., From _____ ft. to _____ ft., From _____ to _____ ft.
 What is the nearest source of possible contamination:
 Septic tank Seepage pit Fuel Storage Other (specify below)
 Sewer lines Pit privy Fertilizer storage HOUSE
 Watertight sewer lines Sewage lagoon Insecticide storage
 Lateral lines Feedyard Abandoned water well Direction from well? NORTH
 Cess pool Livestock pens Oil well/Gas well How many feet? 12

FROM	TO	PLUGGING MATERIALS	FROM	TO	PLUGGING MATERIALS
225	240	WHITE ROCK			
240	245	BLACK ROCK			
245	260	BLUE SHALE			
260	265	COAL			
265	280	BLUE SHALE			

7 CONTRACTOR'S OR LANDOWNER'S CERTIFICATION: This water well was plugged under my jurisdiction and was completed on (mo/day/year) 9/29/11 and this record is true to the best of my knowledge and belief. Kansas Water Well Contractor's License No. 812. This Water Well Record was completed on (mo/day/year) 10/07/11 under the business name of Environmental Loop Service, Inc by (signature) Richard Moore

INSTRUCTIONS: Use typewriter or ballpoint pen. Please press firmly and print clearly. Please fill in blanks, underline or circle the correct answers. Send top three copies to Kansas Department of Health and Environment, Bureau of Water, Geology Section, 1000 SW Jackson St., Ste. 420, Topeka, Kansas 66612-1367. Telephone: 785/296-5524. Send one to Water Well Owner and retain one for your records. Visit us at <http://www.kdheks.gov/waterwell/index.html>.

Paul D

Check one: White Copy Blue Copy Pink Copy