

**WATER WELL PLUGGING RECORD Form WWC-5P KSA 82a-1212 ID NO.**

\_\_\_\_\_

**1 LOCATION OF WATER WELL:** Fraction ¼ SW ¼ NE ¼ NW ¼ Section Number 28 Township Number T 29 S Range Number 25  E  W  
 County: Crawford

Street/Rural Address of Well Location; if unknown, distance & direction from nearest town or intersection: If at owner's address, check here  East 610th Avenue and South 230th St  
Franklin, Kansas

**Global Positioning Systems (GPS) information:**  
 Latitude: 37.49559 (in decimal degrees)  
 Longitude: 94.680212 (in decimal degrees)  
 Elevation: 946  
 Datum:  WGS84,  NAD83,  NAD27  
 Collection Method:  
 GPS unit (Make/Model: \_\_\_\_\_)  
 Digital Map/Photo,  Topographic Map,  Land Survey  
 Est. Accuracy:  < 3 m,  3-5 m,  5-15 m,  > 15 m

**2 WATER WELL OWNER:** Crawford County Kansas  
 RR#, St. Address, Box #: PO Box 249  
 City, State ZIP Code: Girard, Kansas 66743

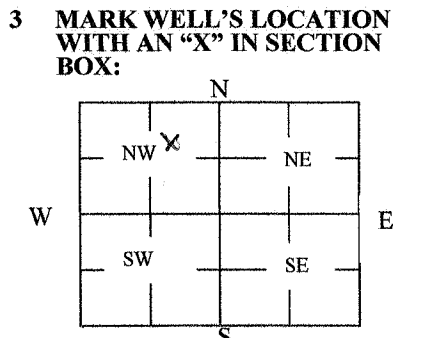

**4 DEPTH OF WELL** 50.22 ft.  
 WELL'S STATIC WATER LEVEL 18.46 ft  
 WELL WAS USED AS:  
 Domestic  Public Water Supply  Dewatering  
 Irrigation  Oil Field Water Supply  Monitoring  
 Feedlot  Domestic (Lawn & Garden)  Injection Well  
 Industrial  Air Conditioning  Other GW-5  
 Was a chemical/bacteriological sample submitted to Department? Yes  No

**5 TYPE OF BLANK CASING USED:**  
 Steel  RMP (SR)  Wrought  Fiberglass  Other (Specify below) \_\_\_\_\_  
 PVC  ABS  Asbestos-Cement  Concrete Tile  
 Blank casing diameter 2 in. Was casing pulled? Yes  No  If yes, how much All  
 Casing height above or below land surface 30 in.

**6 GROUT PLUG MATERIAL:**  Neat cement  Cement grout  Bentonite  Other 0 to 3-foot top soil  
 Grout Plug Intervals: From 3 ft. to 50.22 ft., From N/A ft. to N/A ft., From N/A to N/A ft.  
 What is the nearest source of possible contamination:  
 Septic tank  Seepage pit  Fuel Storage  Other (specify below) Landfill  
 Sewer lines  Pit privy  Fertilizer storage  
 Watertight sewer lines  Sewage lagoon  Insecticide storage  
 Lateral lines  Feedyard  Abandoned water well Direction from well? adjacent  
 Cess pool  Livestock pens  Oil well/Gas well How many feet? 0

FROM	TO	PLUGGING MATERIALS	FROM	TO	PLUGGING MATERIALS
0	3	topsoil			
3	50.22	Bentonite			

**7 CONTRACTOR'S OR LANDOWNER'S CERTIFICATION:** This water well was plugged under my jurisdiction and was completed on (mo/day/year) 7-22-2013 and this record is true to the best of my knowledge and belief. Kansas Water Well Contractor's License No. 759. This Water Well Record was completed on (mo/day/year) 8-25-2013 under the business name of RAZEK Environmental, LLC by (signature) [Signature]

**INSTRUCTIONS:** Use typewriter or ballpoint pen. Please press firmly and print clearly. Please fill in blanks, underline or circle the correct answers. Send one copy to Kansas Department of Health and Environment, Bureau of Water, Geology Section, 1000 SW Jackson St., Ste. 420, Topeka, Kansas 66612-1367. Telephone: 785/296-5524. Send one to Water Well Owner and retain one for your records. Visit us at <http://www.kdheks.gov/waterwell/index.html>.

77708 SP1A