

WATER WELL RECORD

Form WWC-5

Division of Water Resources App. No.

Well ID

MW1

Original Record Correction Change in Well Use



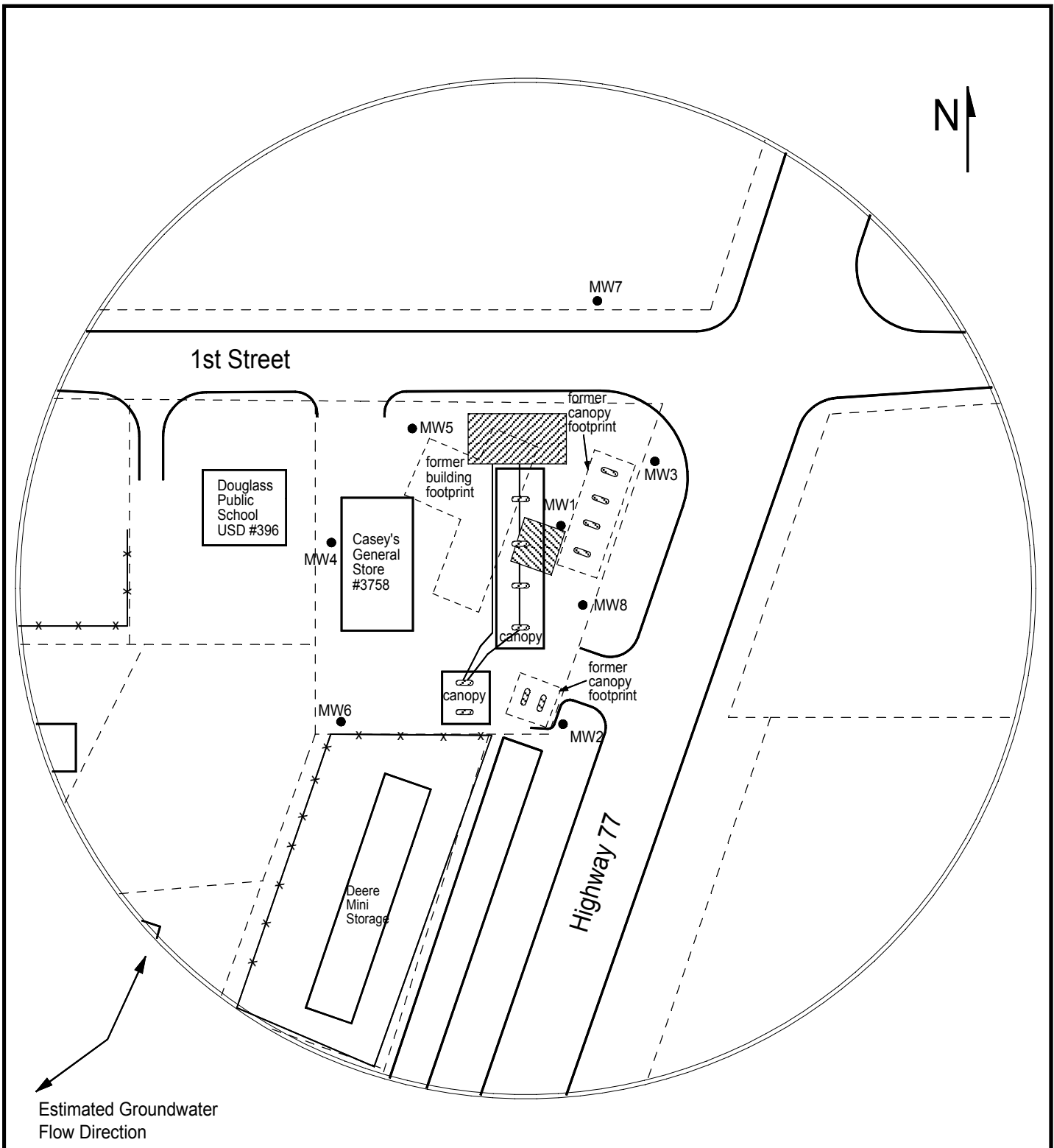

1 LOCATION OF WATER WELL: County Butler, Fraction NE 1/4 NE 1/4 NW 1/4 NW 1/4, Section Number 21, Township Number T 29 S, Range Number R 4 E. 2 WELL OWNER: Last Name: Casey's Retail Company, Business: Casey's Retail Company, Address: PO Box 3004, City: Ankeny, State: IA, ZIP: 50021, Street or Rural Address: 103 S. Hwy 77, Douglass, KS. 3 LOCATE WELL WITH "X" IN SECTION BOX: [Diagram showing section box with 'X' in NW corner]. 4 DEPTH OF COMPLETED WELL: 26 ft, Depth(s) Groundwater Encountered: 1) 17.57 ft, WELLS STATIC WATER LEVEL: 17.57 ft, below land surface, measured on (mo-day-yr) 2/17-18/20. 5 Latitude: 37.51927, Longitude: 97.00423, Horizontal Datum: WGS 84, Source for Latitude/Longitude: Land Survey. 6 Elevation: 1212.78 ft, Ground Level, TOC, Source: Land Survey. 7 WELL WATER TO BE USED AS: 1 Domestic: Household, Lawn & Garden, Livestock, Irrigation, Feedlot, Industrial. 2 Public Water Supply: well ID. 3 Dewatering: how many wells? 4 Aquifer Recharge: well ID. 5 Monitoring: well ID MW1. 6 Environmental Remediation: well ID. 7 Air Sparge, Recovery, Soil Vapor Extractor, Injection. 8 Oil Field Water Supply: lease. 9 Test Hole: well ID. 10 Cased, Uncased, Geotechnical. 11 Geothermal: How many bores? a) Closed Loop, Horizontal, Vertical. b) Open Loop, Surface Discharge, Inj. of Water. Other (specify). 8 TYPE OF CASING USED: Steel, PVC, Other. CASING JOINTS: Glued, Clamped, Welded, Threaded. Casing diameter 2 in. to 11 ft, Diameter in. to ft, Diameter in. to ft, Casing height above land surface -0.42 in. Weight lbs./ft. Well thickness or gauge No. TYPE OF SCREEN OR PERFORATION MATERIAL: Steel, Stainless Steel, Fiberglass, PVC, Brass, Galvanized Steel, Concrete tile, None used (open hole). SCREEN OR PERFORATION OPENINGS ARE: Continuous Slot, Mill Slot, Gauze Wrapped, Torch Cut, Drilled Holes, Louvered Shutter, Key Punched, Wire Wrapped, Saw Cut, None (Open Hole). SCREEN-PERFORATED INTERVALS: From 11 ft. to 26 ft., From ft. to ft., From ft. to ft., GRAVEL PACK INTERVALS: From 9 ft. to 26 ft., From ft. to ft., From ft. to ft. 9 GROUT MATERIAL: Neat cement, Cement grout, Bentonite, Other Concrete: 0-0.5'. Grout intervals: From 0.5 ft. to 9 ft., From ft. to ft., From ft. to ft. Nearest source of possible contamination: Septic Tank, Lateral Lines, Pit Privy, Livestock Pens, Insecticide Storage, Sewer Lines, Cess Pool, Sewage Lagoon, Fuel Storage, Abandoned Water Well, Watertight Sewer Lines, Seepage Pit, Feedyard, Fertilizer Storage, Oil Well / Gas Well, Other (Specify). Direction from well? SW Distance from well? ~8 ft. 10 FROM TO LITHOLOGIC LOG FROM TO LITHO. LOG (cont.) or PLUGGING INTERVALS 0 0.8 Concrete 0.8 3.5 Fill, gravel 3.5 4.5 Silty clay 4.5 19 Shaly, silty clay 19 26 Clay with abundant silt Notes: KDHE ID: Casey's General Store #3758; U2-008-15145 Target of monitoring well is shallow groundwater, <20' of grout was installed at the direction of KDHE. 11 CONTRACTOR'S OR LANDOWNER'S CERTIFICATION: This water well was constructed, reconstructed, or plugged under my jurisdiction and was completed on (mo-day-year) 2/12/20 and this record is true to the best of my knowledge and belief. Kansas Water Well Contractor's License No 757 This Water Well Record was completed on (mo-day-year) 3/5/20 under the business name of Larsen & Associates, Inc. Signature [Signature]

Mail 1 white copy along with a fee of \$5.00 for each constructed well to: Kansas Department of Health and Environment, Bureau of Water, 1000 SW Jackson St., Suite 420, Topeka, Kansas 66612-1367. Mail one to Water Well Owner and retain one for your records. Telephone 785-296-5524.



Estimated Groundwater
Flow Direction

LEGEND:

-  Approximate Location of Active UST Basin, Product Lines & Pump Islands
-  Approximate Location of Former UST Basin & Pump Islands
-  Approximate Location of Property Line
-  Existing Monitoring Well



PROJECT:
Casey's General Store #3758
103 S Hwy. 77
Douglass, KS
KDHE ID: U2-008-15145
Date: 8/4/20

1311 E 25th St. Suite B 785-841-8707 office
Lawrence, KS 66046 785-865-4282 fax

