

WATER WELL RECORD

Form WWC-5

Division of Water Resources App. No.

Well ID

MW2

Original Record Correction Change in Well Ust

1 LOCATION OF WATER WELL: County Butler Fraction NE 1/4 NE 1/4 NW 1/4 NW 1/4 Section Number 21 Township Number T 29 S Range Number R 4 E W

2 WELL OWNER: Last Name: Business: Casey's Retail Company Address: PO Box 3004 City Ankeny State: IA ZIP: 50021 Street or Rural Address where well is located (if unknown, distance and direction from nearest town or intersection): 103 S. Hwy 77, Douglass, KS

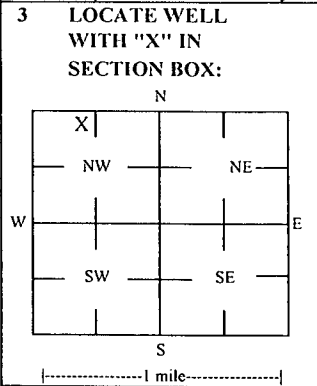

3 LOCATE WELL WITH 'X' IN SECTION BOX: 4 DEPTH OF COMPLETED WELL: 26 ft Depth(s) Groundwater Encountered: 1) 2) 3) 4) Dry Well WELL'S STATIC WATER LEVEL: 17.03 ft

5 Latitude: 37.51888 (decimal degrees) Longitude: 97.00425 (decimal degrees) Horizontal Datum: WGS 84 NAD 83 NAD 27 Source for Latitude/Longitude: GPS (unit make/model): Land Survey Topographic Map Online Mapper

6 Elevation 1212.14 ft Ground Level TOC Source: Land Survey GPS Topographic Map Other

7 WELL WATER TO BE USED AS: 1 Domestic: Household Lawn & Garden Livestock Irrigation Feedlot Industrial 2 Public Water Supply: well ID 3 Dewatering: how many wells? 4 Aquifer Recharge: well ID 5 Monitoring: well ID MW2 6 Environmental Remediation: well ID 7 Air Sparge Recovery 8 Soil Vapor Extractor Injection 9 Oil Field Water Supply: lease 10 Test Hole: well ID 11 Cased Uncased Geotechnical 12 Geothermal: How many bores? a) Closed Loop Horizontal Vertical b) Open Loop Surface Discharge Inj. of Water Other (specify):

Was a chemical/bacteriological sample submitted to KDHE? Yes No If yes, date sample was submitted: Water well disinfected? Yes No

8 TYPE OF CASING USED: Steel PVC Other CASING JOINTS: Glued Clamped Welded Threaded Casing diameter 2 in. to 11 ft, Diameter in. to ft, Casing height above land surface -0.25 in. Weight lbs./ft. Well thickness or gauge No TYPE OF SCREEN OR PERFORATION MATERIAL: Steel Stainless Steel Fiberglass PVC Brass Galvanized Steel Concrete tile None used (open hole) SCREEN OR PERFORATION OPENINGS ARE: Continuous Slot Mill Slot Gauze Wrapped Torch Cut Drilled Holes Other (Specify) Louvered Shutter Key Punched Wire Wrapped Saw Cut None (Open Hole) SCREEN-PERFORATED INTERVALS: From 11 ft. to 26 ft, From ft. to ft, From ft. to ft, GRAVEL PACK INTERVALS: From 9 ft. to 26 ft, From ft. to ft, From ft. to ft,

9 GROUT MATERIAL: Neat cement Cement grout Bentonite Other Concrete: 0-0.5' Grout intervals: From 0.5 ft. to 9 ft, From ft. to ft, From ft. to ft,



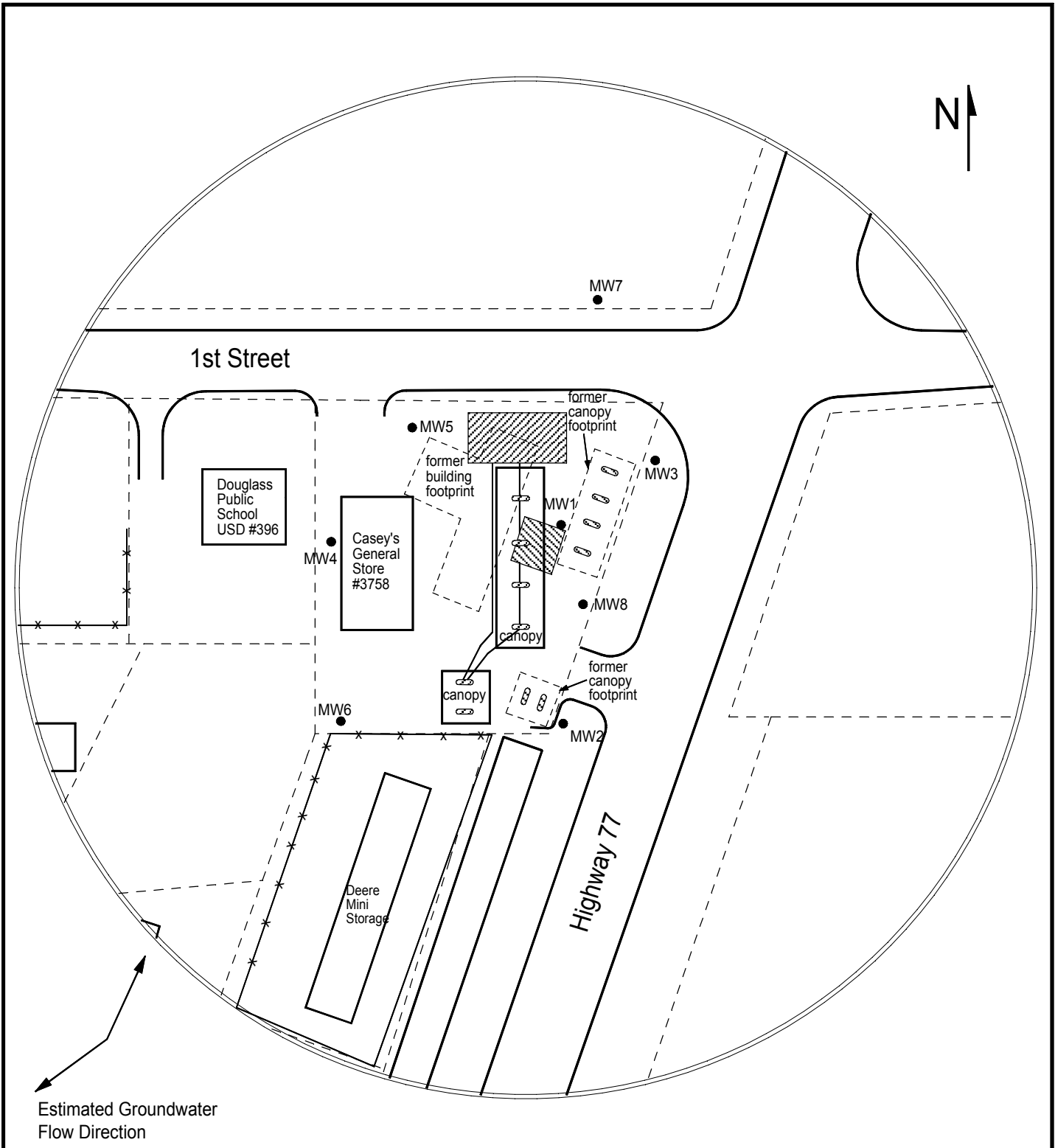

Nearest source of possible contamination: Septic Tank Lateral Lines Pit Privy Livestock Pens Insecticide Storage Sewer Lines Cess Pool Sewage Lagoon Fuel Storage Abandoned Water Well Watertight Sewer Lines Seepage Pit Feedyard Fertilizer Storage Oil Well / Gas Well Other (Specify): Direction from well? NW Distance from well? ~20 ft

Table with 6 columns: FROM, TO, LITHOLOGIC LOG, FROM, TO, LITHO. LOG (cont.) or PLUGGING INTERVALS. Rows include: 0-0.5 Grass/topsoil, 0.5-1 Silty clay/topsoil, organics, 1-2 Gravel, fill, 2-4 Silty clay, 4-7.5 Shaley clay, 7.5-9 Silty clay, 9-19 Shaley clay, 19-26 Silty, shaley clay with abundant silt. Notes: KDHE ID: Casey's General Store #3758; U2-008-15145 Target of monitoring well is shallow groundwater, <20' of grout was installed at the direction of KDHE.

11 CONTRACTOR'S OR LANDOWNER'S CERTIFICATION: This water well was constructed, reconstructed, or plugged under my jurisdiction and was completed on (mo-day-year) 2/11/20 and this record is true to the best of my knowledge and belief. Kansas Water Well Contractor's License No. 757 This Water Well Record was completed on (mo-day-year) 3/5/20 under the business name of Larsen & Associates, Inc. Signature



LEGEND:

-  Approximate Location of Active UST Basin, Product Lines & Pump Islands
-  Approximate Location of Former UST Basin & Pump Islands
-  Approximate Location of Property Line
-  Existing Monitoring Well



PROJECT:

Casey's General Store #3758
 103 S Hwy. 77
 Douglass, KS
 KDHE ID: U2-008-15145
 Date: 8/4/20

1311 E 25th St. Suite B 785-841-8707 office
 Lawrence, KS 66046 785-865-4282 fax

