

WATER WELL RECORD

Form WWC-5

Division of Water Resources App. No.

Well ID

MW3

Original Record Correction Change in Well Ust

1 LOCATION OF WATER WELL: County Butler Fraction NE 1/4 NE 1/4 NW 1/4 NW 1/4 Section Number 21 Township Number T 29 S Range Number R 4 E W

2 WELL OWNER: Last Name: Casey's Retail Company Business: Casey's Retail Company Address: PO Box 3004 City Ankeny State: IA ZIP: 50021 Street or Rural Address where well is located (if unknown, distance and direction from nearest town or intersection): 103 S. Hwy 77, Douglass, KS

3 LOCATE WELL WITH "X" IN SECTION BOX: [Grid with X in NW quadrant]

4 DEPTH OF COMPLETED WELL: 25 ft Depth(s) Groundwater Encountered: 1) 25 ft 2) 3) 4) Dry Well WELL'S STATIC WATER LEVEL: 17.65 ft [X] below land surface, measured on (mo-day-yr) 2/17-18/20

5 Latitude: 37.51941 (decimal degrees) Longitude: 97.00402 (decimal degrees) Horizontal Datum: [X] WGS 84 [] NAD 83 [] NAD 27 Source for Latitude/Longitude: [] GPS (unit make/model:) [X] Land Survey [] Topographic Map [] Online Mapper

6 Elevation 1212.94 ft [] Ground Level [X] TOC Source [X] Land Survey [] GPS [] Topographic Map [] Other

7 WELL WATER TO BE USED AS: 1 Domestic: [] Household [] Lawn & Garden [] Livestock [] Irrigation [] Feedlot [] Industrial 5 Public Water Supply: well ID 6 Dewatering: how many wells? 7 Aquifer Recharge: well ID 8 [X] Monitoring: well ID MW3 9 Environmental Remediation: well ID [] Air Sparge [] Soil Vapor Extractor [] Recovery [] Injection 10 Oil Field Water Supply: lease 11 Test Hole: well ID [] Cased [] Uncased [] Geotechnical 12 Geothermal: How many bores? a) Closed Loop [] Horizontal [] Vertical b) Open Loop [] Surface Discharge [] Inj. of Water [] Other (specify):

Was a chemical/bacteriological sample submitted to KDHE? [] Yes [X] No If yes, date sample was submitted: Water well disinfected? [] Yes [X] No

8 TYPE OF CASING USED: [] Steel [X] PVC [] Other CASING JOINTS: [] Glued [] Clamped [] Welded [X] Threaded Casing diameter 2 in. to 10 ft, Diameter in. to ft, Diameter in. to ft, Diameter in. to ft, Casing height above land surface -0.27 in. Weight lbs./ft. Well thickness or gauge No TYPE OF SCREEN OR PERFORATION MATERIAL: [] Steel [] Stainless Steel [] Fiberglass [X] PVC [] Brass [] Galvanized Steel [] Concrete tile [] None used (open hole) SCREEN OR PERFORATION OPENINGS ARE: [] Continuous Slot [X] Mill Slot [] Gauze Wrapped [] Torch Cut [] Drilled Holes [] Other (Specify) [] Louvered Shutter [] Key Punched [] Wire Wrapped [] Saw Cut [] None (Open Hole) SCREEN-PERFORATED INTERVALS: From 10 ft. to 25 ft, From ft. to ft, From ft. to ft, GRAVEL PACK INTERVALS: From 8 ft. to 25 ft, From ft. to ft, From ft. to ft,

9 GROUT MATERIAL: [] Neat cement [] Cement grout [X] Bentonite [X] Other Concrete: 0-0.5' Grout intervals: From 0.5 ft. to 8 ft, From ft. to ft, From ft. to ft,

Nearest source of possible contamination: [] Septic Tank [] Lateral Lines [] Pit Privy [] Livestock Pens [] Insecticide Storage [] Sewer Lines [] Cess Pool [] Sewage Lagoon [X] Fuel Storage [] Abandoned Water Well [] Watertight Sewer Lines [] Seepage Pit [] Feedyard [] Fertilizer Storage [] Oil Well / Gas Well [] Other (Specify) Direction from well? W Distance from well? ~30 ft



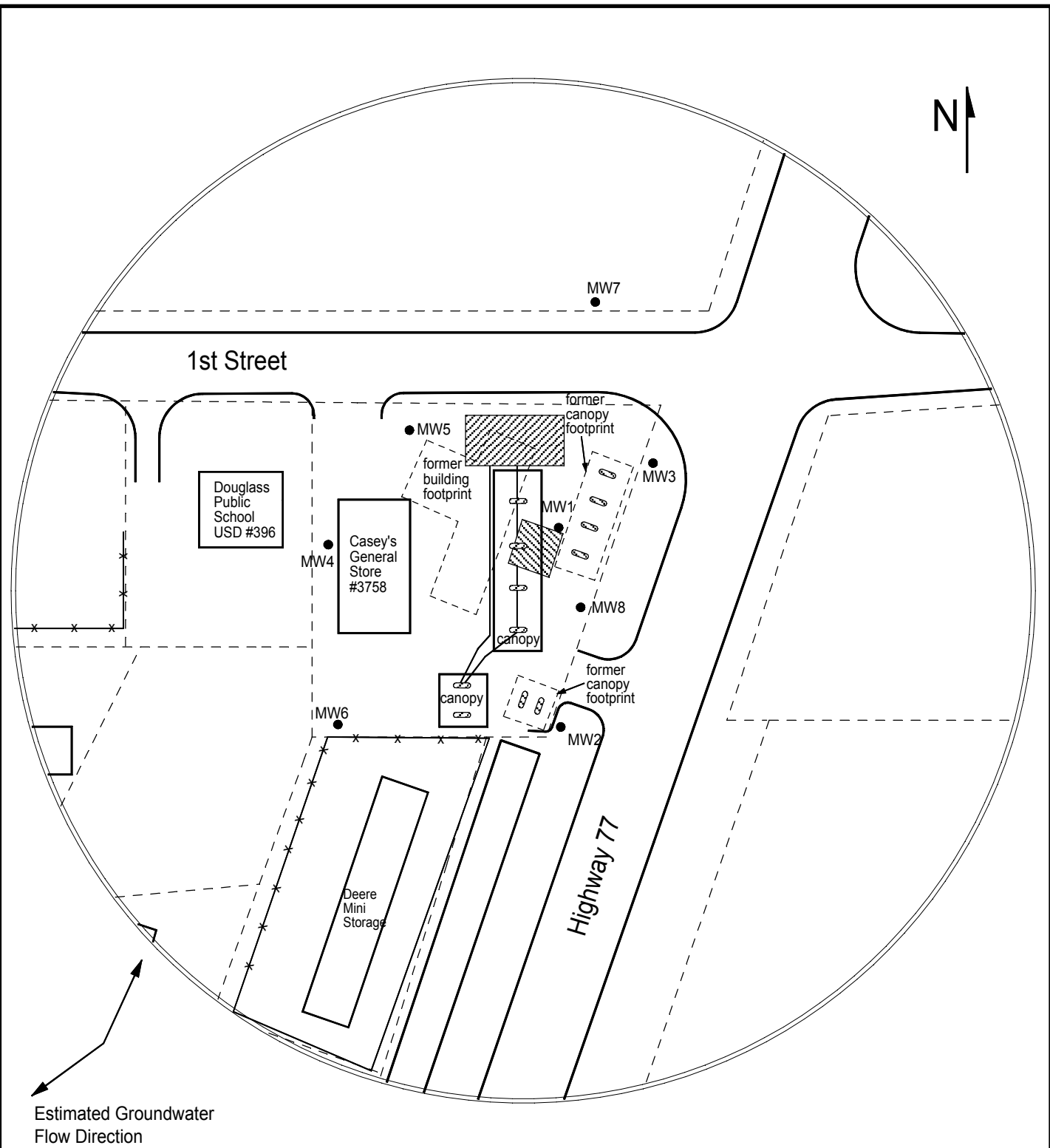

Table with 6 columns: FROM, TO, LITHOLOGIC LOG, FROM, TO, LITHO. LOG (cont.) or PLUGGING INTERVALS. Rows include: 0-0.5 Grass/topsoil, 0.5-1 Silty clay, 1-1.5 Sand, possible fill, 1.5-4 Silty clay, gravel, possible fill, 4-19 Shaley clay, 19-25 Silty clay with abundant silt

Notes: KDHE ID: Casey's General Store #3758; U2-008-15145 Target of monitoring well is shallow groundwater, <20' of grout was installed at the direction of KDHE.

11 CONTRACTOR'S OR LANDOWNER'S CERTIFICATION: This water well was [X] constructed, [] reconstructed, or [] plugged under my jurisdiction and was completed on (mo-day-year) 2/13/20 and this record is true to the best of my knowledge and belief. Kansas Water Well Contractor's License No 757 This Water Well Record was completed on (mo-day-year) 3/5/20 under the business name of Larsen & Associates, Inc. Signature



LEGEND:

-  Approximate Location of Active UST Basin, Product Lines & Pump Islands
-  Approximate Location of Former UST Basin & Pump Islands
-  Approximate Location of Property Line
-  Existing Monitoring Well



PROJECT:
 Casey's General Store #3758
 103 S Hwy. 77
 Douglass, KS
 KDHE ID: U2-008-15145
 Date: 8/4/20



1311 E 25th St. Suite B 785-841-8707 office
 Lawrence, KS 66046 785-865-4282 fax