

WATER WELL RECORD

Form WWC-5

Division of Water Resources App. No.

Well ID

MW4

Original Record Correction Change in Well Use

1 LOCATION OF WATER WELL: County Butler Fraction NE 1/4 NE 1/4 NW 1/4 NW 1/4 Section Number 21 Township Number T 29 S Range Number R 4 E W

2 WELL OWNER: Last Name: Casey's Retail Company Business: Casey's Retail Company Address: PO Box 3004 City Ankeny State: IA ZIP: 50021 Street or Rural Address where well is located (if unknown, distance and direction from nearest town or intersection): 103 S. Hwy 77, Douglass, KS

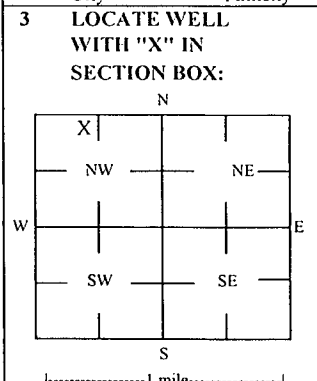

3 LOCATE WELL WITH 'X' IN SECTION BOX: 4 DEPTH OF COMPLETED WELL: 34 ft Depth(s) Groundwater Encountered: 1) 34 ft 2) ft 3) ft, or 4) Dry Well WELL'S STATIC WATER LEVEL: 17.95 ft below land surface, measured on (mo-day-yr) 2/17-18/20

5 Latitude: 37.51924 (decimal degrees) Longitude: 97.00477 (decimal degrees) Horizontal Datum: WGS 84 NAD 83 NAD 27 Source for Latitude/Longitude: GPS (unit make/model) Land Survey Topographic Map Online Mapper

6 Elevation: 1212.99 ft Ground Level TOC Source: Land Survey GPS Topographic Map Other

7 WELL WATER TO BE USED AS: 1 Domestic: Household Lawn & Garden Livestock Irrigation Feedlot Industrial 5 Public Water Supply: well ID 6 Dewatering: how many wells? 7 Aquifer Recharge: well ID 8 Monitoring: well ID MW4 9 Environmental Remediation: well ID Air Sparge Recovery Soil Vapor Extractor Injection 10 Oil Field Water Supply: lease 11 Test Hole: well ID Cased Uncased Geotechnical 12 Geothermal: How many bores? a) Closed Loop Horizontal Vertical b) Open Loop Surface Discharge Inj. of Water Other (specify):

Was a chemical/bacteriological sample submitted to KDHE? Yes No If yes, date sample was submitted: Water well disinfected? Yes No

8 TYPE OF CASING USED: Steel PVC Other CASING JOINTS: Glued Clamped Welded Threaded Casing diameter 2 in. to 19 ft, Diameter in. to ft, Diameter in. to ft, Casing height above land surface -0.26 in. Weight lbs./ft. Well thickness or gauge No TYPE OF SCREEN OR PERFORATION MATERIAL: Steel Stainless Steel Fiberglass PVC Other (Specify) SCREEN OR PERFORATION OPENINGS ARE: Continuous Slot Mill Slot Gauze Wrapped Torch Cut Drilled Holes Other (Specify) Louvered Shutter Key Punched Wire Wrapped Saw Cut None (Open Hole) SCREEN-PERFORATED INTERVALS: From 19 ft. to 34 ft., From ft. to ft., From ft. to ft. GRAVEL PACK INTERVALS: From 17 ft. to 34 ft., From ft. to ft., From ft. to ft.

9 GROUT MATERIAL: Neat cement Cement grout Bentonite Other Concrete: 0-0.5' Grout intervals: From 0.5 ft. to 17 ft., From ft. to ft., From ft. to ft.

Nearest source of possible contamination: Septic Tank Lateral Lines Pit Privy Livestock Pens Insecticide Storage Sewer Lines Cess Pool Sewage Lagoon Fuel Storage Abandoned Water Well Watertight Sewer Lines Seepage Pit Feedyard Fertilizer Storage Oil Well / Gas Well Other (Specify) Direction from well? E Distance from well? ~130 ft

10 FROM TO LITHOLOGIC LOG FROM TO LITHO. LOG (cont.) or PLUGGING INTERVALS

FROM	TO	LITHOLOGIC LOG	FROM	TO	LITHO. LOG (cont.) or PLUGGING INTERVALS
0	0.8	Concrete			
0.8	2	Gravel, fill			
2	5	Silty clay, some organics			
5	18	Shaley clay			
18	20	Silty clay			
20	22	Shaley, silty clay			
22	34	Silty clay with abundant silt and some clay			



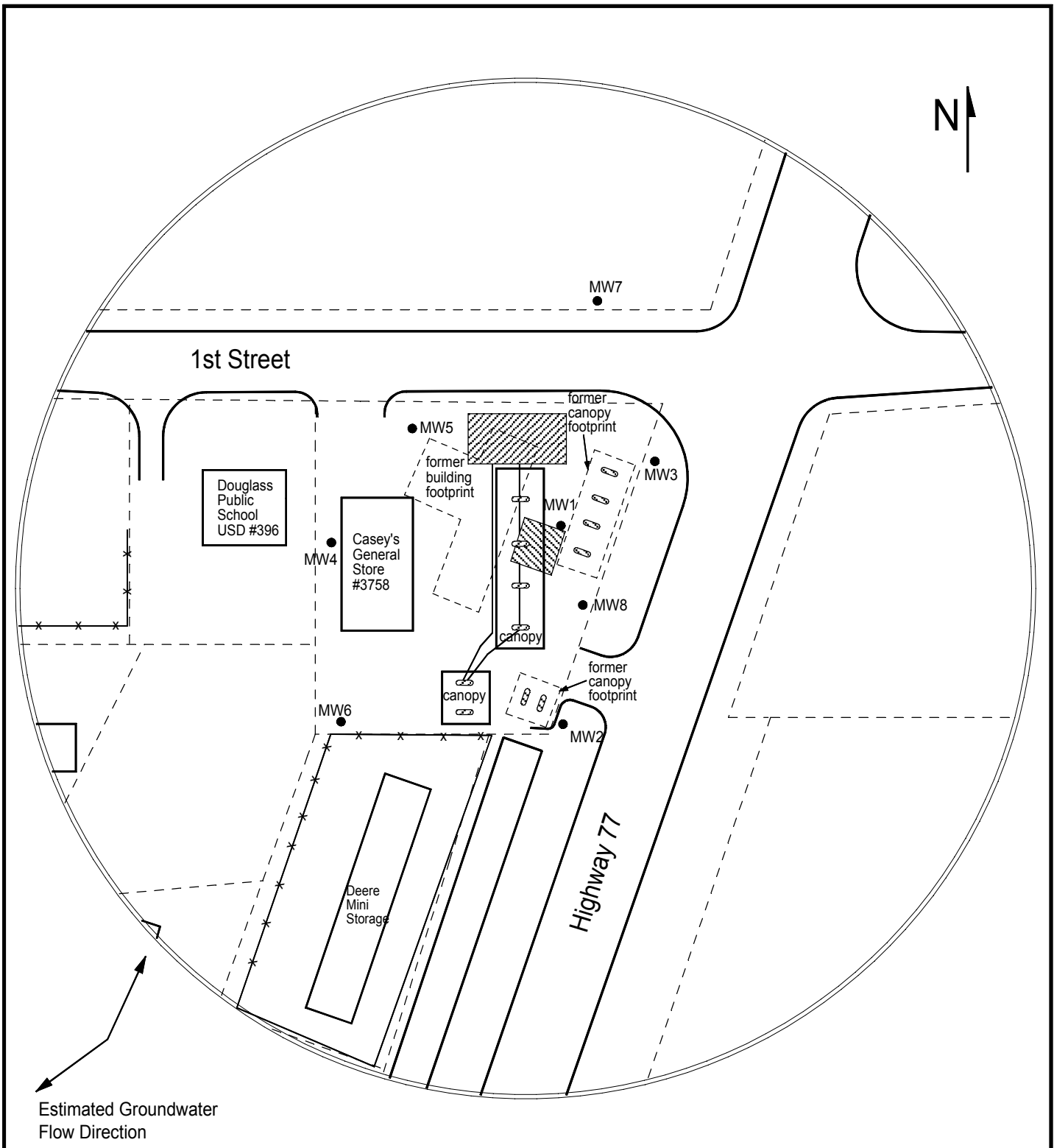

Notes: KDHE ID: Casey's General Store #3758; U2-008-15145 Target of monitoring well is shallow groundwater, <20' of grout was installed at the direction of KDHE.

11 CONTRACTOR'S OR LANDOWNER'S CERTIFICATION: This water well was constructed, reconstructed, or plugged under my jurisdiction and was completed on (mo-day-year) 2/11/20 and this record is true to the best of my knowledge and belief. License No 757 This Water Well Record was completed on (mo-day-year) 3/5/20 under the business name of Larsen & Associates, Inc. Signature

Mail 1 white copy along with a fee of \$5.00 for each constructed well to: Kansas Department of Health and Environment, Bureau of Water, GWTS Section, 1000 SW Jackson St., Suite 420, Topeka, Kansas 66612-1367. Mail one to Water Well Owner and retain one for your records. Telephone 785-296-5524.



**LEGEND:**

-  Approximate Location of Active UST Basin, Product Lines & Pump Islands
-  Approximate Location of Former UST Basin & Pump Islands
-  Approximate Location of Property Line
-  Existing Monitoring Well



**PROJECT:**  
 Casey's General Store #3758  
 103 S Hwy. 77  
 Douglass, KS  
 KDHE ID: U2-008-15145  
 Date: 8/4/20



1311 E 25th St. Suite B 785-841-8707 office  
 Lawrence, KS 66046 785-865-4282 fax