

WATER WELL RECORD

Form WWC-5

Division of Water Resources App. No.

Well ID

MW6

Original Record Correction Change in Well Ust

1 LOCATION OF WATER WELL: County Butler Fraction NE 1/4 NE 1/4 NW 1/4 NW 1/4 Section Number 21 Township Number T 29 S Range Number R 4 E W

2 WELL OWNER: Last Name: Business: Casey's Retail Company Address: PO Box 3004 City Ankeny State: IA ZIP: 50021 Street or Rural Address where well is located (if unknown, distance and direction from nearest town or intersection): 103 S. Hwy 77, Douglass, KS

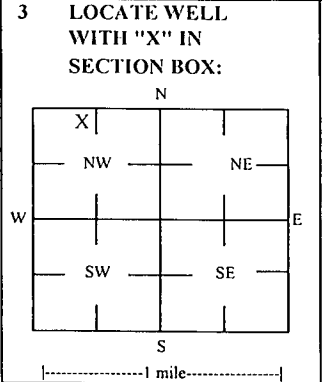

3 LOCATE WELL WITH 'X' IN SECTION BOX: 4 DEPTH OF COMPLETED WELL: 26 ft Depth(s) Groundwater Encountered: 1) 26 ft 2) 3) 4) Dry Well WELLS STATIC WATER LEVEL: 20.02 ft

5 Latitude: 37.51890 (decimal degrees) Longitude: 97.00476 (decimal degrees) Horizontal Datum: X WGS 84 Source for Latitude/Longitude: X Land Survey

7 WELL WATER TO BE USED AS: 1 Domestic: Household Lawn & Garden Livestock Irrigation Feedlot Industrial 5 Public Water Supply: well ID 6 Dewatering: how many wells? 7 Aquifer Recharge: well ID 8 Monitoring: well ID MW6 9 Environmental Remediation: well ID Air Sparge Soil Vapor Extractor Recovery Injection 10 Oil Field Water Supply: lease 11 Test Hole: well ID Cased Uncased Geotechnical 12 Geothermal: How many bores? a) Closed Loop Horizontal Vertical b) Open Loop Surface Discharge Inj. of Water Other (specify):

Was a chemical/bacteriological sample submitted to KDHE? Yes No X No If yes, date sample was submitted: Water well disinfected? Yes No X No

8 TYPE OF CASING USED: Steel PVC Other CASING JOINTS: Glued Clamped Welded X Threaded Casing diameter 2 in. to 11 ft, Diameter in. to ft, Diameter in. to ft, Casing height above land surface -0.45 in. Weight lbs./ft. Well thickness or gauge No TYPE OF SCREEN OR PERFORATION MATERIAL: Steel Stainless Steel Fiberglass X PVC Other (Specify) SCREEN OR PERFORATION OPENINGS ARE: Continuous Slot X Mill Slot Gauze Wrapped Torch Cut Drilled Holes Other (Specify) Louvered Shutter Key Punched Wire Wrapped Saw Cut None (Open Hole) SCREEN-PERFORATED INTERVALS: From 11 ft. to 26 ft. GRAVEL PACK INTERVALS: From 9 ft. to 26 ft.

9 GROUT MATERIAL: Neat cement Cement grout X Bentonite X Other Concrete: 0-0.5' Grout intervals: From 0.5 ft. to 9 ft, From ft. to ft, From ft. to ft,

Nearest source of possible contamination: Septic Tank Lateral Lines Pit Privy Livestock Pens Insecticide Storage Sewer Lines Cess Pool Sewage Lagoon X Fuel Storage Abandoned Water Well Watertight Sewer Lines Seepage Pit Feedyard Fertilizer Storage Oil Well / Gas Well Other (Specify) Direction from well? E Distance from well? ~90 ft



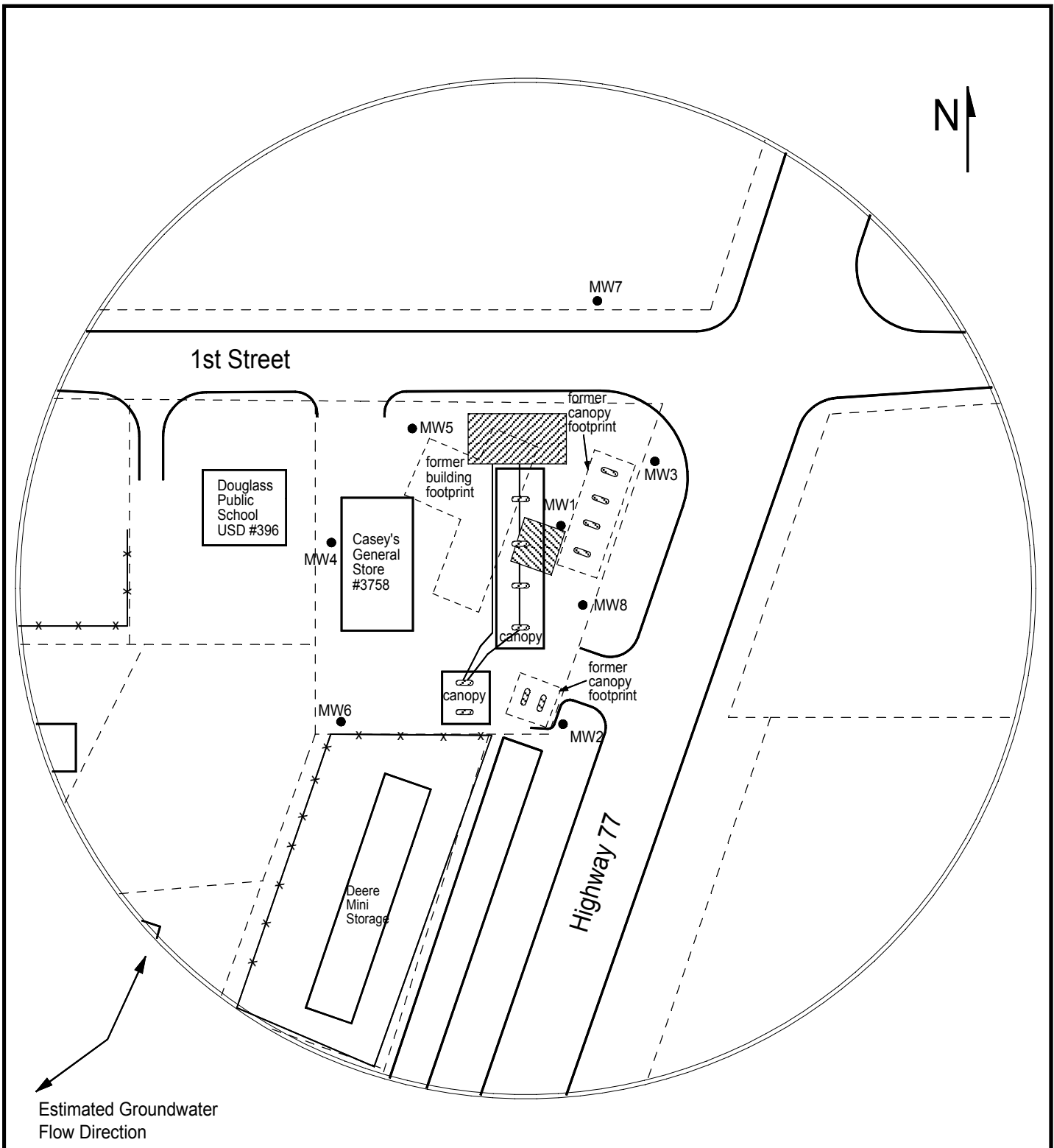

Table with 6 columns: FROM, TO, LITHOLOGIC LOG, FROM, TO, LITHO. LOG (cont.) or PLUGGING INTERVALS. Rows include: 0-0.8 Concrete, 0.8-2.5 Gravel, fill, 2.5-5 Silty clay, some organics, 5-19 Silty clay, some shale, 19-26 Silty clay with abundant silt

Notes: KDHE ID: Casey's General Store #3758; U2-008-15145 Target of monitoring well is shallow groundwater, <20' of grout was installed at the direction of KDHE.

11 CONTRACTOR'S OR LANDOWNER'S CERTIFICATION: This water well was X constructed, reconstructed or plugged under my jurisdiction and was completed on (mo-day-year) 2/12/20 and this record is true to the best of my knowledge and belief. Kansas Water Well Contractor's License No 757 This Water Well Record was completed on (mo-day-year) 3/5/20 under the business name of Larsen & Associates, Inc. Signature



**LEGEND:**

-  Approximate Location of Active UST Basin, Product Lines & Pump Islands
-  Approximate Location of Former UST Basin & Pump Islands
-  Approximate Location of Property Line
-  Existing Monitoring Well



**larsen**  
& ASSOCIATES, INC.

**PROJECT:**  
 Casey's General Store #3758  
 103 S Hwy. 77  
 Douglass, KS  
 KDHE ID: U2-008-15145  
 Date: 8/4/20

1311 E 25th St. Suite B    785-841-8707 office  
 Lawrence, KS 66046        785-865-4282 fax

