

WATER WELL RECORD

Form WWC-5

Division of Water Resources App. No.

Well ID

MW7

Original Record Correction Change in Well Ust

1 LOCATION OF WATER WELL: County Butler Fraction SE 1/4 SE 1/4 SW 1/4 SW 1/4 Section Number 16 Township Number T 29 S Range Number R 4 E W

2 WELL OWNER: Last Name: Casey's Retail Company Business: Casey's Retail Company Address: PO Box 3004 City Ankeny State: IA ZIP: 50021 Street or Rural Address where well is located (if unknown, distance and direction from nearest town or intersection): ~80' north of 103 S. Hwy 77, Douglass, KS

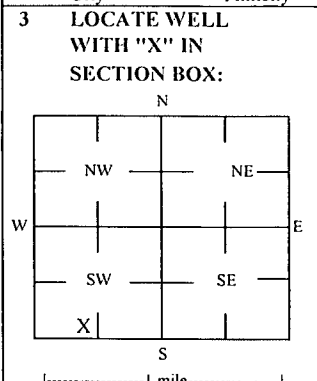

3 LOCATE WELL WITH 'X' IN SECTION BOX: 4 DEPTH OF COMPLETED WELL: 29 ft Depth(s) Groundwater Encountered: 1) 29 ft 2) 3) 4) Dry Well WELL'S STATIC WATER LEVEL: 16.23 ft X below land surface, measured on (mo-day-yr) 2/17-18/20

5 Latitude: 37.51969 (decimal degrees) Longitude: 97.00415 (decimal degrees) Horizontal Datum: X WGS 84 NAD 83 NAD 27 Source for Latitude/Longitude: X GPS (unit make/model: 2/17-18/20) (WAAS enabled? Yes No) X Land Survey Topographic Map Online Mapper 6 Elevation 1211.46 ft Ground Level X TOC Source X Land Survey GPS Topographic Map Other

7 WELL WATER TO BE USED AS: 1 Domestic: Household Lawn & Garden Livestock Irrigation Feedlot Industrial 5 Public Water Supply: well ID 6 Dewatering: how many wells? 7 Aquifer Recharge: well ID 8 X Monitoring: well ID MW7 9 Environmental Remediation: well ID Air Sparge Soil Vapor Extractor Recovery Injection 10 Oil Field Water Supply: lease 11 Test Hole: well ID Cased Uncased Geotechnical 12 Geothermal: How many bores? a) Closed Loop Horizontal Vertical b) Open Loop Surface Discharge Inj. of Water Other (specify):

Was a chemical/bacteriological sample submitted to KDHE? Yes No X No If yes, date sample was submitted: Water well disinfected? Yes No X No

8 TYPE OF CASING USED: Steel X PVC Other CASING JOINTS: Glued Clamped Welded X Threaded Casing diameter 2 in. to 14 ft, Diameter in. to ft, Diameter in. to ft, Casing height above land surface -0.34 in. Weight lbs./ft. Well thickness or gauge No TYPE OF SCREEN OR PERFORATION MATERIAL: Steel Stainless Steel Fiberglass X PVC Brass Galvanized Steel Concrete tile None used (open hole) SCREEN OR PERFORATION OPENINGS ARE: Continuous Slot X Mill Slot Gauze Wrapped Torch Cut Drilled Holes Other (Specify) Louvered Shutter Key Punched Wire Wrapped Saw Cut None (Open Hole) SCREEN-PERFORATED INTERVALS: From 14 ft. to 29 ft., From ft. to ft., From ft. to ft., GRAVEL PACK INTERVALS: From 12 ft. to 29 ft., From ft. to ft., From ft. to ft.,

9 GROUT MATERIAL: Neat cement Cement grout X Bentonite X Other Concrete: 0-0.5' Grout intervals: From 0.5 ft. to 12 ft., From ft. to ft., From ft. to ft.,

Nearest source of possible contamination: Septic Tank Lateral Lines Pit Privy Livestock Pens Insecticide Storage Sewer Lines Cess Pool Sewage Lagoon X Fuel Storage Abandoned Water Well Watertight Sewer Lines Seepage Pit Feedyard Fertilizer Storage Oil Well / Gas Well Other (Specify): Direction from well? S-SW Distance from well? ~90 ft



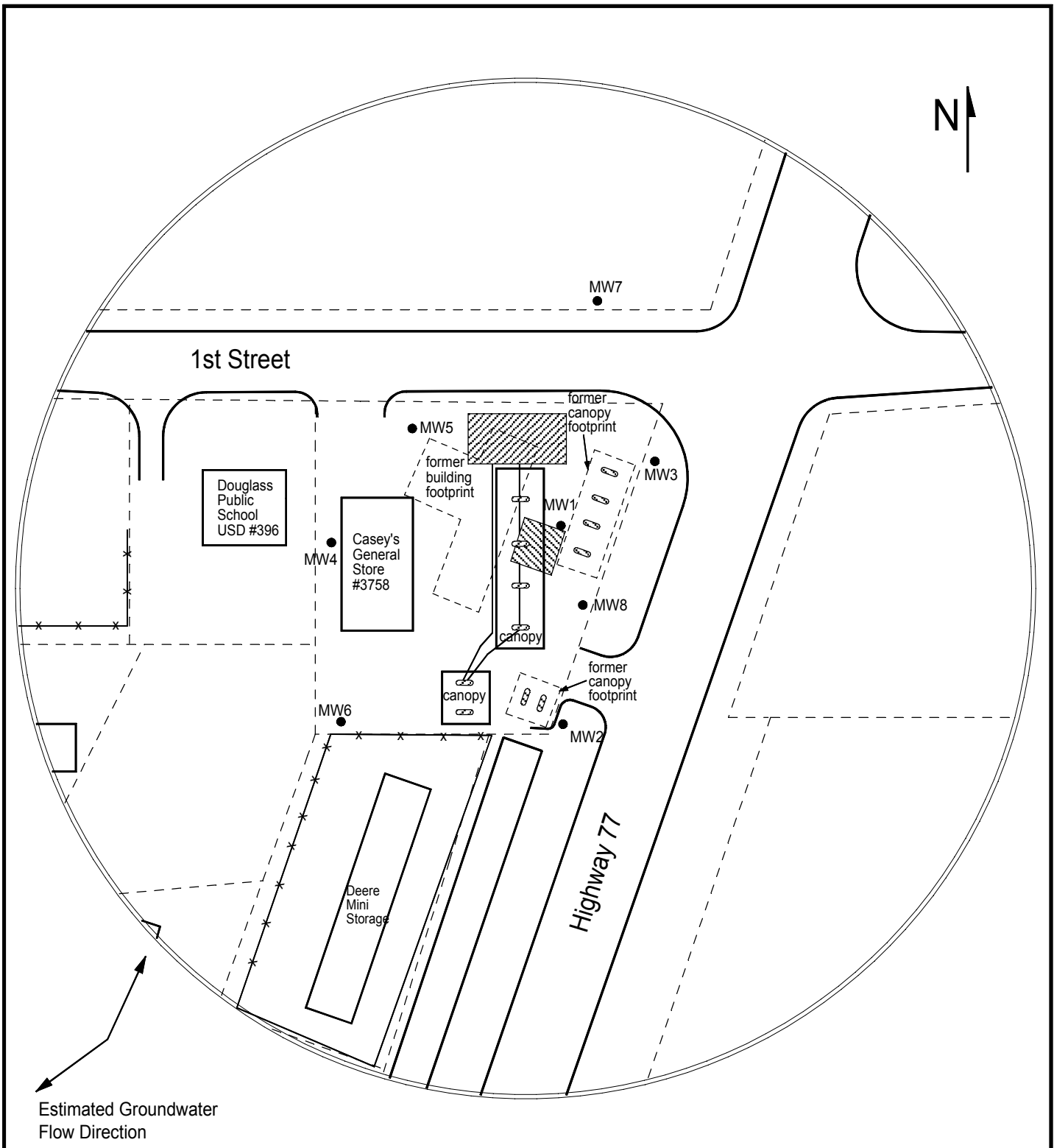

Table with 6 columns: FROM, TO, LITHOLOGIC LOG, FROM, TO, LITHO. LOG (cont.) or PLUGGING INTERVALS. Rows include 0-0.5 Grass/topsoil, 0.5-5.5 Silty clay, organics, 5.5-17 Shaley clay, 7-22 Silty clay, 22-29 Silty clay with some clay and abundant silt.

Notes: KDHE ID: Casey's General Store #3758; U2-008-15145 Target of monitoring well is shallow groundwater, <20' of grout was installed at the direction of KDHE.

11 CONTRACTOR'S OR LANDOWNER'S CERTIFICATION: This water well was X constructed, reconstructed or plugged under my jurisdiction and was completed on (mo-day-year) 2/11/20 and this record is true to the best of my knowledge and belief. License No 757 This Water Well Record was completed on (mo-day-year) 3/5/20 under the business name of Larsen & Associates, Inc. Signature



**LEGEND:**

-  Approximate Location of Active UST Basin, Product Lines & Pump Islands
-  Approximate Location of Former UST Basin & Pump Islands
-  Approximate Location of Property Line
-  Existing Monitoring Well



**PROJECT:**  
 Casey's General Store #3758  
 103 S Hwy. 77  
 Douglass, KS  
 KDHE ID: U2-008-15145  
 Date: 8/4/20



1311 E 25th St. Suite B    785-841-8707 office  
 Lawrence, KS 66046      785-865-4282 fax