

WATER WELL PLUGGING RECORD Form WWC-5P KSA 82a-1212 ID NO.

MW-4

1 LOCATION OF WATER WELL: County: <u>Brown</u>	Fraction <u>¼</u> <u>¼ NE</u> <u>¼ NE</u> <u>¼</u>	Section Number <u>30</u>	Township Number <u>T 2 S</u>	Range Number <u>17</u> <input checked="" type="checkbox"/> <u>E</u> <input type="checkbox"/> <u>W</u>
--	---	-----------------------------	---------------------------------	--

Street/Rural Address of Well Location; if unknown, distance & direction from nearest town or intersection: If at owner's address, check here 1215 Oregon Street, Hiawatha, KS 66434

Global Positioning Systems (GPS) information:
 Latitude: 39o51.151' N (in decimal degrees)
 Longitude: 95o32.879' W (in decimal degrees)
 Elevation: _____
 Datum: WGS84, NAD83, NAD27
 Collection Method:
 GPS unit (Make/Model: Magellan)
 Digital Map/Photo, Topographic Map, Land Survey
 Est. Accuracy: < 3 m, 3-5 m, 5-15 m, > 15 m

2 WATER WELL OWNER: Hiawatha Implement
 RR#, St. Address, Box #: 2000 Oregon Street
 City, State ZIP Code: Hiawatha, KS 66434

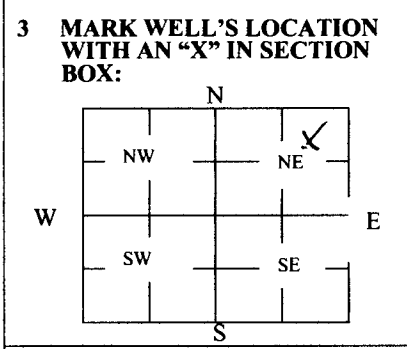

4 DEPTH OF WELL 31 **ft.**
 WELL'S STATIC WATER LEVEL 7.53 **ft**
 WELL WAS USED AS:
 Domestic Public Water Supply Dewatering
 Irrigation Oil Field Water Supply Monitoring
 Feedlot Domestic (Lawn & Garden) Injection Well
 Industrial Air Conditioning Other _____
 Was a chemical/bacteriological sample submitted to Department? Yes No

5 TYPE OF BLANK CASING USED:

Steel RMP (SR) Wrought Fiberglass Other (Specify below) _____
 PVC ABS Asbestos-Cement Concrete Tile

Blank casing diameter 2 in. Was casing pulled? Yes No If yes, how much 31'
 Casing height above or below land surface _____ in.

6 GROUT PLUG MATERIAL: Neat cement Cement grout Bentonite Other _____
 Grout Plug Intervals: From 31 ft. to 1 ft., From _____ ft. to _____ ft., From _____ to _____ ft.

What is the nearest source of possible contamination:

<input type="checkbox"/> Septic tank	<input type="checkbox"/> Seepage pit	<input type="checkbox"/> Fuel Storage	<input type="checkbox"/> Other (specify below) _____
<input checked="" type="checkbox"/> Sewer lines	<input type="checkbox"/> Pit privy	<input type="checkbox"/> Fertilizer storage	
<input type="checkbox"/> Watertight sewer lines	<input type="checkbox"/> Sewage lagoon	<input type="checkbox"/> Insecticide storage	
<input type="checkbox"/> Lateral lines	<input type="checkbox"/> Feedyard	<input type="checkbox"/> Abandoned water well	Direction from well? _____
<input type="checkbox"/> Cess pool	<input type="checkbox"/> Livestock pens	<input type="checkbox"/> Oil well/Gas well	How many feet? _____

FROM	TO	PLUGGING MATERIALS	FROM	TO	PLUGGING MATERIALS
<u>1'</u>	<u>31'</u>	<u>Bentonite Chips</u>			

7 CONTRACTOR'S OR LANDOWNER'S CERTIFICATION: This water well was plugged under my jurisdiction and was completed on (mo/day/year) 7/18/2014 and this record is true to the best of my knowledge and belief. Kansas Water Well Contractor's License No. 704. This Water Well Record was completed on (mo/day/year) 9/22/2014 under the business name of Max's by (signature) David Humphreys

INSTRUCTIONS: Use typewriter or ballpoint pen. Please press firmly and print clearly. Please fill in blanks, underline or circle the correct answers. Send one copy to Kansas Department of Health and Environment, Bureau of Water, Geology Section, 1000 SW Jackson St., Ste. 420, Topeka, Kansas 66612-1367. Telephone: 785/296-5524. Send one to Water Well Owner and retain one for your records. Visit us at <http://www.kdheks.gov/waterwell/index.html>.

Soil Conservation Service

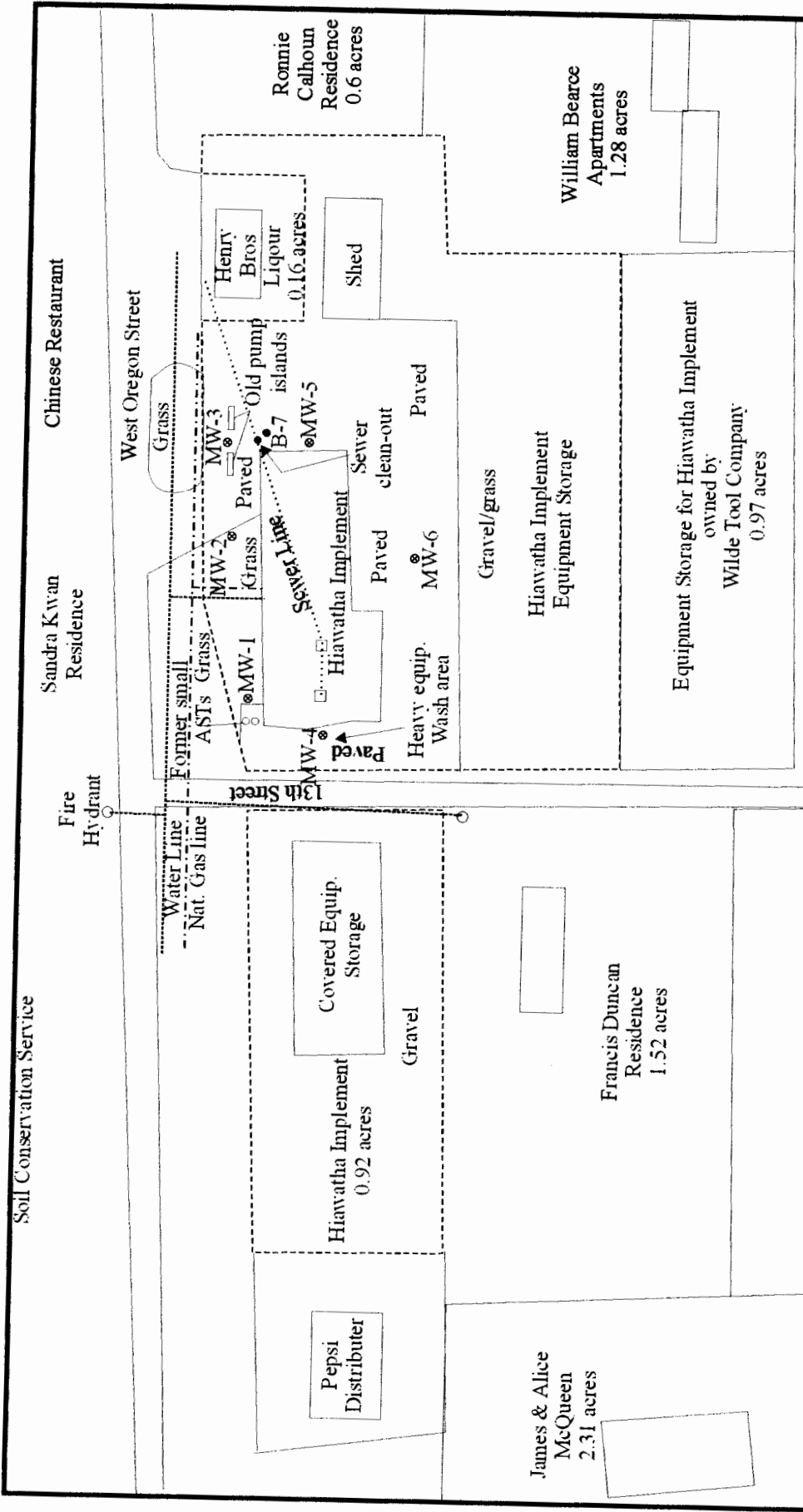

Chinese Restaurant

Sandra Kwan Residence

West Oregon Street

Grass

Henry Bros Liquor 0.16 acres

Shed

William Bearce Apartments 1.28 acres

Hiawatha Implement (former) 1215 Oregon Street Hiawatha, Kansas

Wilde Tool Company 8.91 acres vacant

Equipment Storage for Hiawatha Implement owned by Wilde Tool Company 0.97 acres

Westview Court (abandoned road)

Hiawatha Implement (former) 1215 Oregon Street Hiawatha, Kansas

PROJECT #: ECP ENVIRO-CO., LLC

FIGURE: 1 - Site Map

13th Street

Former small AST's Grass

MW-1

MW-2

MW-3

Old pump islands

B-7

MW-5

Hiawatha Implement

Paved

Sewer clean-out

Paved

Gravel/grass

Hiawatha Implement Equipment Storage

Equipment Storage for Hiawatha Implement owned by Wilde Tool Company 0.97 acres

Heavy equip. Wash area

MW-4

MW-6

Gravel

Covered Equip. Storage

Hiawatha Implement 0.92 acres

Francis Duncan Residence 1.52 acres

White Cloud Grain 1.43 acres

James & Alice McQueen 2.31 acres

Water Line

Nat. Gas line

Fire Hydrant

Gravel

Pepsi Distributer

Scale: 1" = 110'

