

USE TYPEWRITER OR BALL POINT PEN-PRESS FIRMLY, PRINT CLEARLY.

WATER WELL RECORD
KSA 82a-1201-1215

Kansas Department of Health and Environment-Division of Environment (Water well Contractors) Topeka, Kansas 66620

1. Location of well:	County DONIPHAN	Fraction SE 1/4 SE 1/4 NE 1/4	Section number 7	Township number T 2	Range number S R 19	(EW)
----------------------	---------------------------	---	----------------------------	-------------------------------	-------------------------------	-------------

2. Distance and direction from nearest town or city: 2 miles west and 1 1/2 miles north of Highland, Kansas Street address of well location if in city:	3. Owner of well: DONALD RAWLES R.R. or street: RR 1 City, state, zip code: HIGHLAND, KANSAS 66035
---	---

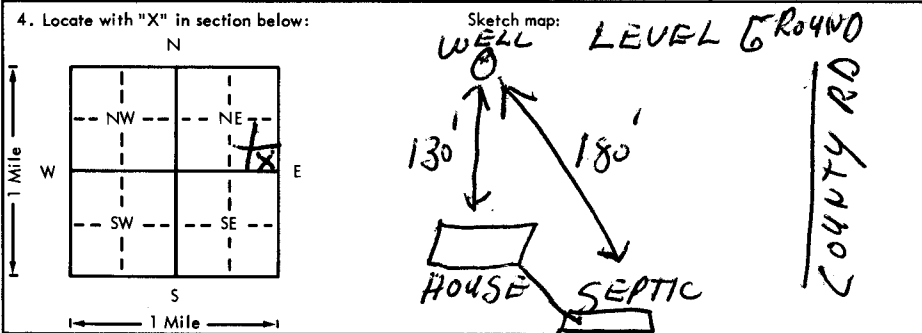

6. Bore hole dia. <u>34</u> in. Completion date <u>9/29/75</u> Well depth <u>62</u> ft. BORE HOLE IS 42"
7. <input type="checkbox"/> Cable tool <input type="checkbox"/> Rotary <input type="checkbox"/> Driven <input type="checkbox"/> Dug <input type="checkbox"/> Hollow rod <input type="checkbox"/> Jetted <input checked="" type="checkbox"/> Bored <input type="checkbox"/> Reverse rotary
8. Use: <input checked="" type="checkbox"/> Domestic <input type="checkbox"/> Public supply <input type="checkbox"/> Industry <input type="checkbox"/> Irrigation <input type="checkbox"/> Air conditioning <input type="checkbox"/> Stock <input type="checkbox"/> Lawn <input type="checkbox"/> Oil field water <input type="checkbox"/> Other
9. Casing: Material <u>CONCRETE</u> Height: <u>Above</u> or below Threaded <input type="checkbox"/> Welded <input type="checkbox"/> Surface <u>15</u> in. RMP <input type="checkbox"/> PVC <input type="checkbox"/> Weight <u>200</u> lbs./ft. Dia. <u>30</u> in. to <u>62</u> ft. depth Wall Thickness: inches or Dia. <u>in.</u> to <u>ft.</u> depth Gauge No. <u>2 in.</u>

5. Type and color of material	From	To
BLACK TOPSOIL	0	2 1/2
YELLOW WINDBLOWN - VERY FINE TEXTURE	2 1/2	7
BROWNISH - YELLOW WINDBLOWN LOESS	7	24
GRAY CLAY - VERY FINE GRAIN	24	27
GRAY CLAY WITH STREAKS OF BLACK	27	31
YELLOW AND BROWN CLAY WITH STREAKS OF BLACK DIRT	31	40
FINE TO COARSE, VERY DARK BROWN SAND, FAIRLY WET	40	44
YELLOW CLAY - VERY HARD	44	62

10. Screen: Manufacturer's name _____ Type _____ Dia. _____ Slot/gauze _____ Length _____ Set between _____ ft. and _____ ft. _____ ft. and _____ ft. Gravel pack? _____ Size range of material _____
11. Static water level: _____ ft. below land surface Date <u>9/29/75</u> mo./day/yr.
12. Pumping level below land surfaces: <u>51</u> ft. after <u>1</u> hrs. pumping <u>9</u> g.p.m. <u>58</u> ft. after <u>2</u> hrs. pumping <u>9</u> g.p.m. Estimated maximum yield _____ g.p.m.
13. Water sample submitted: _____ mo./day/yr. <input type="checkbox"/> Yes <input checked="" type="checkbox"/> No Date _____
14. Well head completion: <input type="checkbox"/> Pitless adapter _____ Inches above grade
15. Well grouted? <input checked="" type="checkbox"/> With: <input checked="" type="checkbox"/> Neat cement <input type="checkbox"/> Bentonite <input type="checkbox"/> Concrete Depth: From _____ ft. to <u>11</u> ft.
16. Nearest source of possible contamination: ft. <u>180</u> Direction <u>SOUTH</u> Type <u>SEPTIC</u> Well disinfected upon completion? <input checked="" type="checkbox"/> Yes <input type="checkbox"/> No
17. Pump: <input checked="" type="checkbox"/> Not installed Manufacturer's name _____ Model number _____ HP _____ Volts _____ Length of drop pipe _____ ft. capacity _____ g.p.m. Type: <input type="checkbox"/> Submersible <input type="checkbox"/> Turbine <input type="checkbox"/> Jet <input type="checkbox"/> Reciprocating <input type="checkbox"/> Centrifugal <input type="checkbox"/> Other

18. Elevation: <u>962'</u> Topography: <input checked="" type="checkbox"/> Hill <input type="checkbox"/> Slope <input type="checkbox"/> Upland <input type="checkbox"/> Valley	19. Remarks: CONCRETE SLAB AND VENT WILL BE INSTALLED BY CUSTOMER. HE KNOWS AND UNDERSTANDS THIS IS A REGULATION. <i>Donald H. Rawles</i>	20. Water well contractor's certification: This well was drilled under my jurisdiction and this report is true to the best of my knowledge and belief. POPPELWELL WELL BORING 320 Business name _____ License No. _____ Address AMITY, MISSOURI Signed <i>Jerry Poppelew</i> <u>10/16/75</u> Authorized representative
--	---	--

TO 11
-2-190-2 SE SE NE
T
R
S
E
C
1/4
1/4
1/4